



RAZER WOLVERINE ULTIMATE

MASTER GUIDE

PACKAGE CONTENTS / SYSTEM REQUIREMENTS

PACKAGE CONTENTS

- Razer Wolverine Ultimate gaming controller for Xbox One
- 2x Detachable thumbstick modules
- USB to Micro-USB cable + breakaway cable
- Tilting D-Pad module
- Important Product Information Guide

SYSTEM REQUIREMENTS

- Xbox One / Xbox One S / Xbox One X
OR
- PC (Windows®7 or higher)

SAFETY STATEMENT

IMPORTANT! Before using the Xbox One with this product, read the Xbox One instruction manual for safety, health, and other information regarding the use of the Xbox One.

REGISTRATION / TECHNICAL SUPPORT

REGISTRATION

Register your product online at razerzone.com/registration for real-time information on your product's warranty.

If you don't have a Razer ID yet, register now at razerzone.com/razer-id for access to a wide range of Razer benefits.

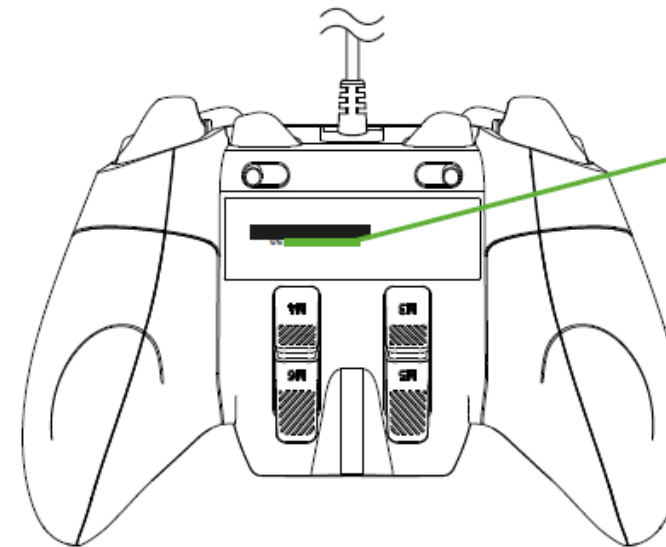

Your product's serial number can be found here.

TECHNICAL SUPPORT

- 1 year limited manufacturer's warranty
- Free online technical support at razersupport.com

DEVICE LAYOUT

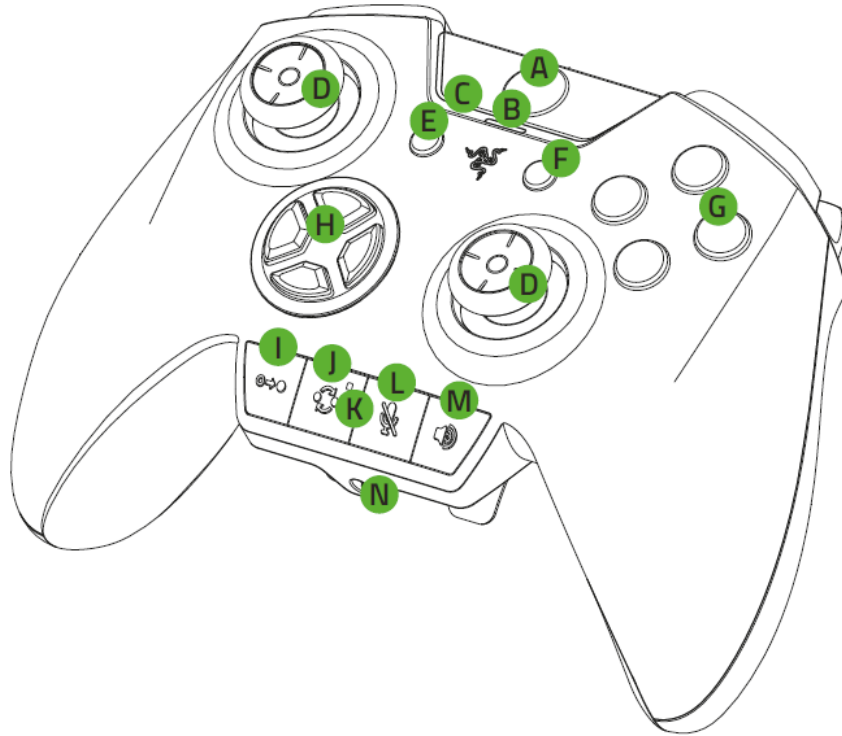

- A. Xbox button
- B. Power indicator
- C. Razer Chroma lighting
- D. Detachable thumbstick modules (standard)
- E. View button
- F. Menu button
- G. Hyperresponse action buttons
- H. Individual D-Pad module
- I. Remap button
- J. Profile cycle button
- K. Profile indicator
- L. Mic mute button
- M. Audio control button
- N. 3.5 mm headset port

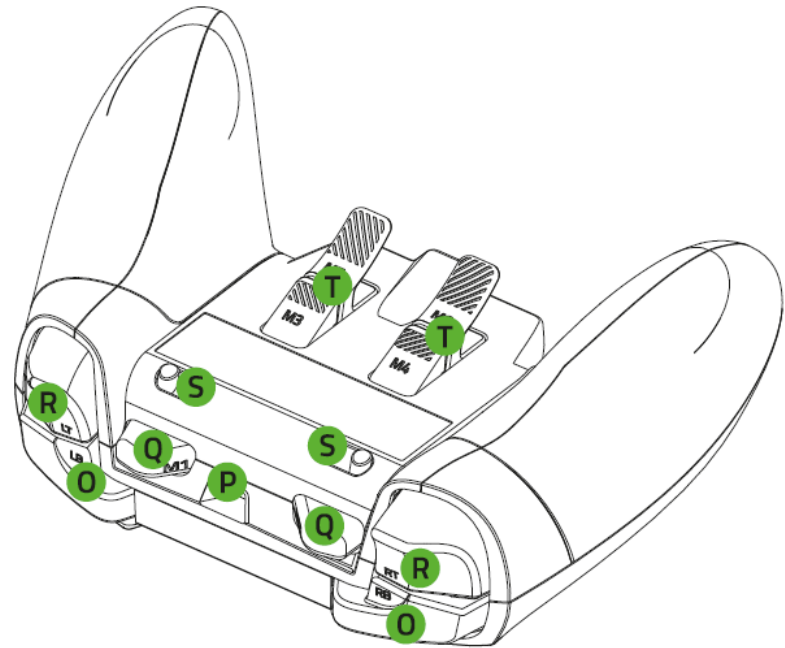

- O. Bumpers (LB / RB)
- P. Micro-USB port
- Q. Multi-Function Bumpers (M1 / M2)
- R. Triggers (LT / RT)
- S. Trigger stop switches
- T. Multi-Function Triggers (M3 / M4 / M5 / M6)

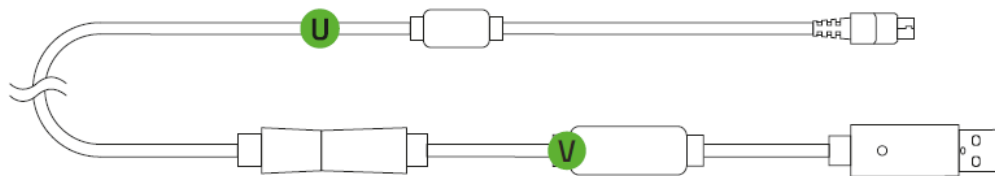

- U. USB to Micro-USB cable
- V. Breakaway cable

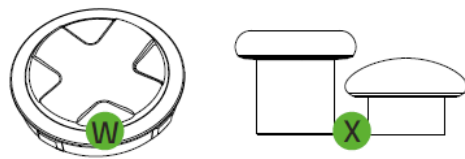

- W. Tilting D-Pad module
- X. Thumbstick modules

SETTING UP YOUR RAZER WOLVERINE ULTIMATE

CONNECTING TO YOUR XBOX ONE

1. Connect your Razer Wolverine Ultimate to your Xbox One using the USB to Micro-USB cable.

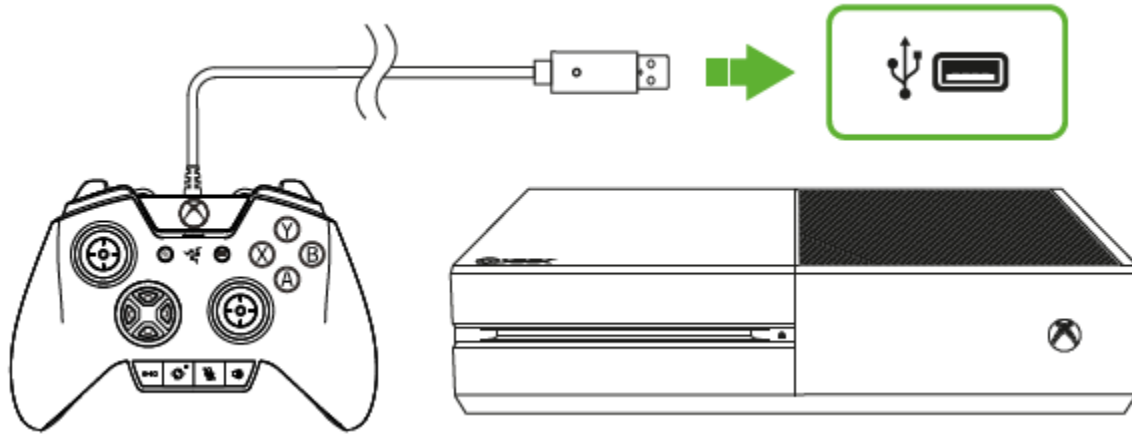

2. Press the Xbox button and your Razer Wolverine Ultimate is ready to go.



CONNECTING TO YOUR PC

1. Connect your Razer Wolverine Ultimate to your PC using the USB to Micro-USB cable.

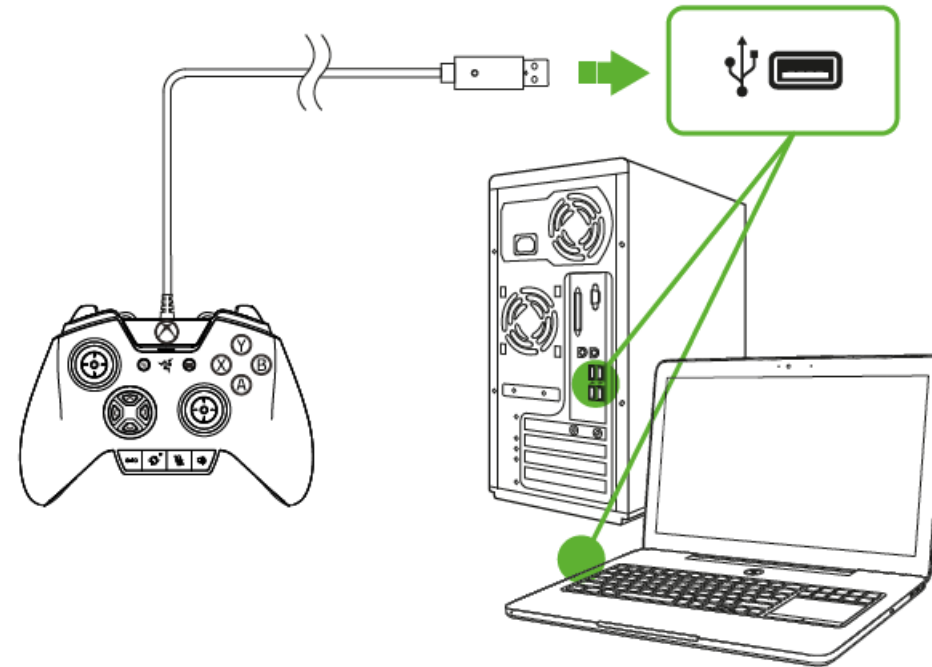

2. Wait until the Xbox One Controller drivers are automatically installed or manually update the drivers through the Device Manager.



100%

USING YOUR RAZER WOLVERINE ULTIMATE

USING THE DETACHABLE THUMBSTICK MODULES

The Razer Wolverine Ultimate has a long and a short module which you can use to replace the standard modules for a more comfortable fit. Simply pull the standard modules to remove them then insert the other modules into the controller.

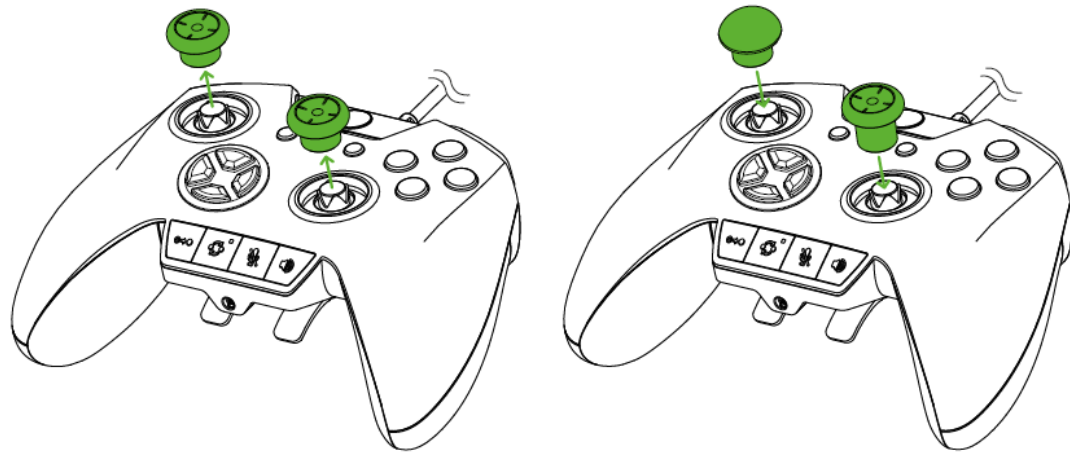

USING THE D-PAD MODULES

The Razer Wolverine Ultimate has a tilting D-Pad module which you can use to replace the individual D-Pad module which you can use for games that require quickly sliding your thumb in different directions such as fighting/arcade games. Simply lift the individual D-Pad module from its edge, remove the module, and then insert the tilting D-Pad module into the controller.

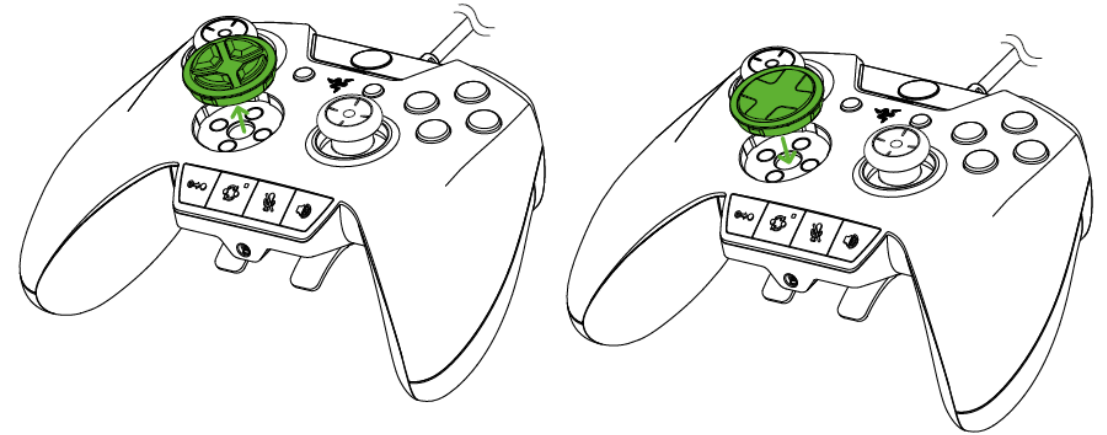

USING THE TRIGGER STOP SWITCHES

The Trigger Stops allows you to activate the Left and Right Triggers faster by shortening their travel distance and reducing their response time (Active Hair Trigger Mode). To enable the Trigger Stops, simply slide the switches outwards; and to disable the Trigger Stops, slide the switches inwards.

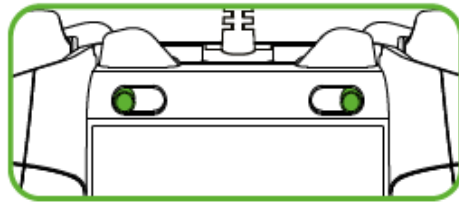

Enable

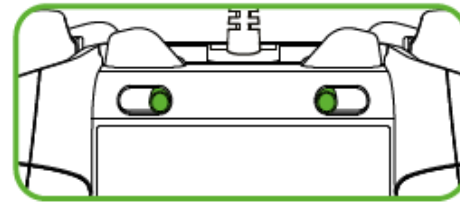

Disable

USING THE SENSITIVITY FUNCTIONS

The sensitivity functions increase or decrease the sensitivity of the analog sticks to provide better aiming and handling. By default, press and hold the M5 trigger to decrease the sensitivity or the M6 trigger to increase the sensitivity.

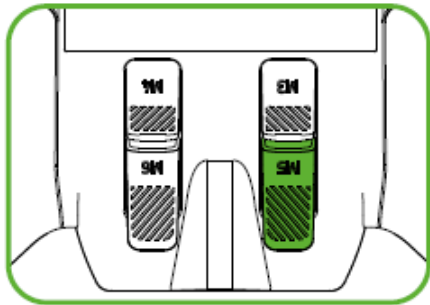

Decrease sensitivity

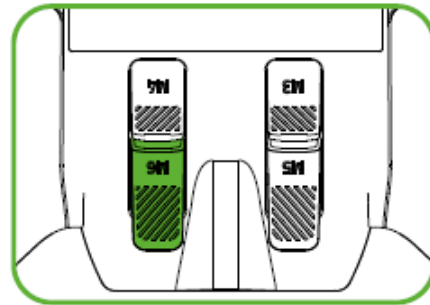

Increase sensitivity

Note: The sensitivity settings can be customized through the Razer Synapse for Xbox app.

USING THE QUICK CONTROL PANEL

SELECTING A PROFILE

The Razer Wolverine Ultimate has 2 onboard profiles which you can use to customize the controller (e.g. button remapping and Razer Chroma lighting). Pressing the Profile button will cycle between Profile 1 (Green) and Profile 2 (Blue).

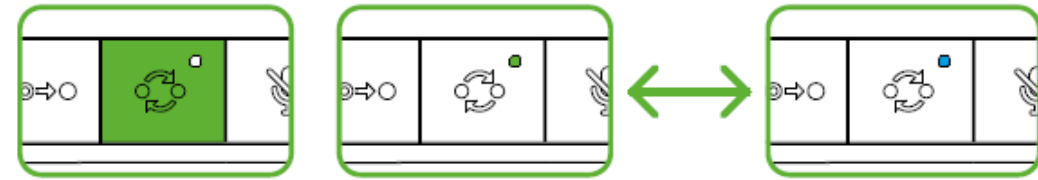

Profile 1

Profile 2

REMAPPING THE MULTI-FUNCTION TRIGGERS (MFT) AND BUMPERS (MFB)

By default, each profile is mapped to a specific function as shown here.

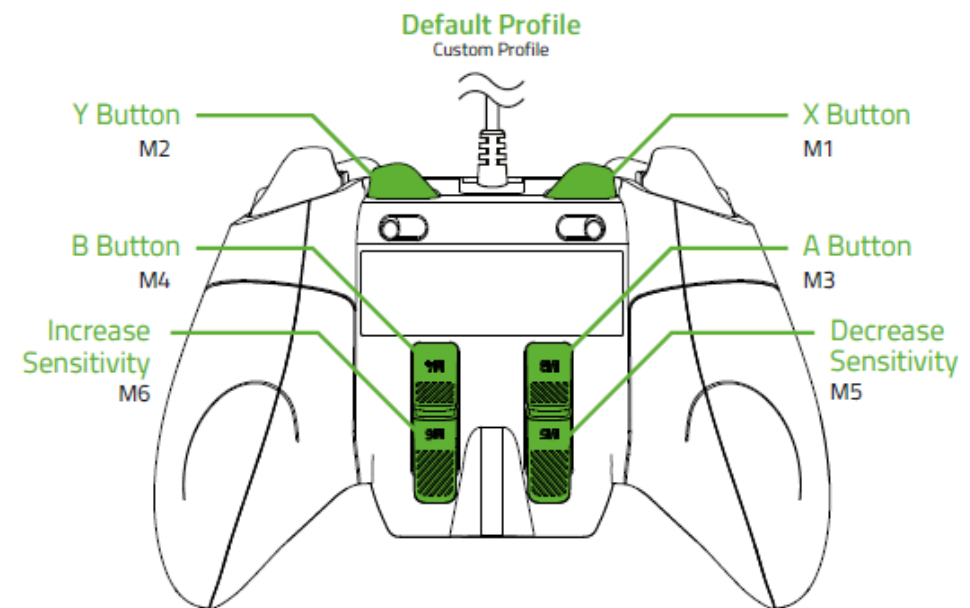

To remap the MFT and MFB, you will first need to select which profile to customize. After you have selected a profile, follow these instructions:

1. Press and hold the Remap button until the active Profile Indicator blinks.

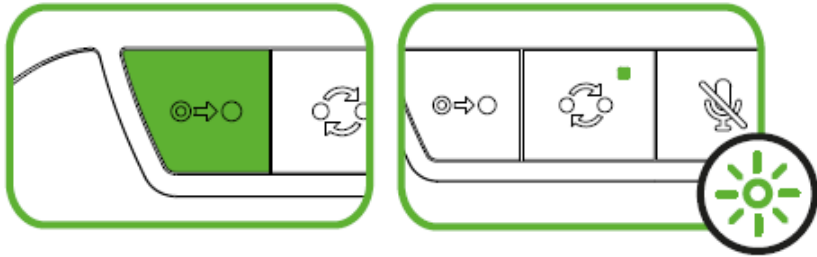

2. Press and hold the MFB or MFT you wish to configure.

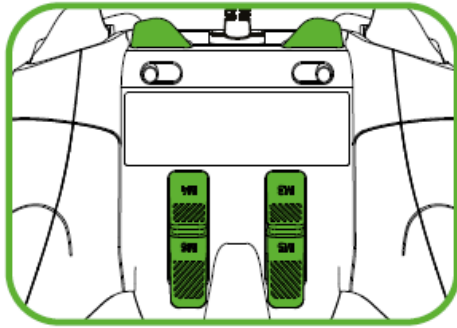

3. Press the button you want to assign to the MFB or MFT.

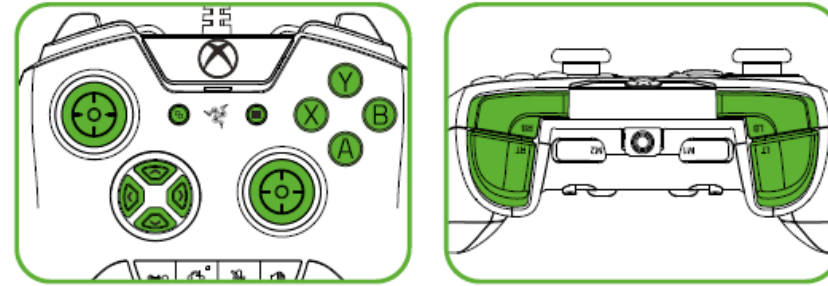

4. Release your fingers once you feel the controller vibrate.

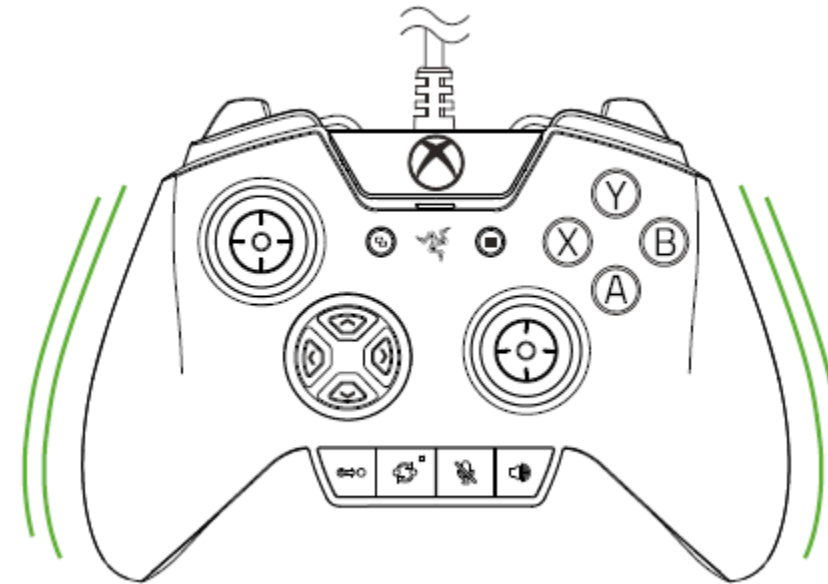

Note: The Xbox button cannot be remapped to the MFB or MFT instead, it will remove the current mapping. Remapping can also be done using the Razer Synapse for Xbox app. The sensitivity functions can only be remapped using the Razer Synapse For Xbox app.

USING THE MIC MUTE BUTTON

The mic mute button allows you to disable the microphone that is connected to the 3.5mm headset port. The button will light up to indicate that the microphone is muted.

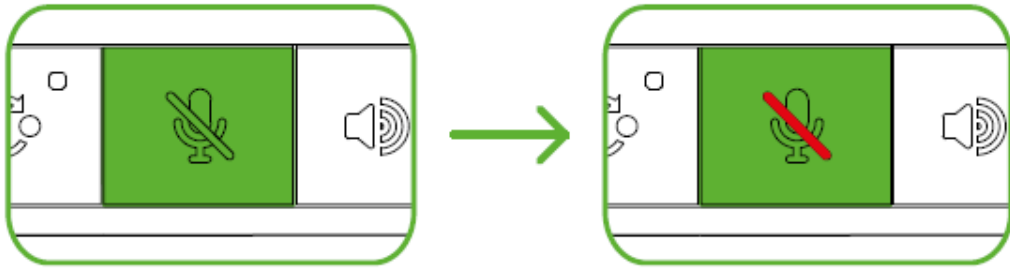

USING THE AUDIO CONTROL BUTTON

The Razer Wolverine Ultimate has a multi-purpose audio control button which you can use to increase or decrease the master volume as well as change the balance between the voice chat and game volume.

To increase the master volume, simply press the audio control button.

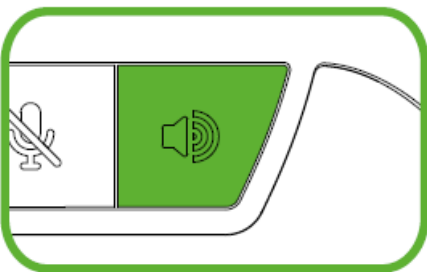

To fine-tune the master volume, press and hold the audio control button then press the directional pad's up or down button to increase or decrease the volume respectively.

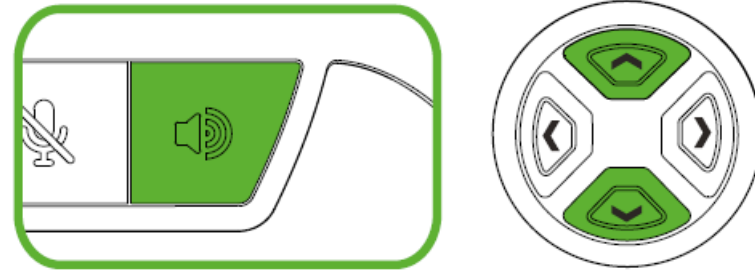

To increase the voice chat volume and decrease the game volume, press and hold the audio control button then press the directional pad's left button.

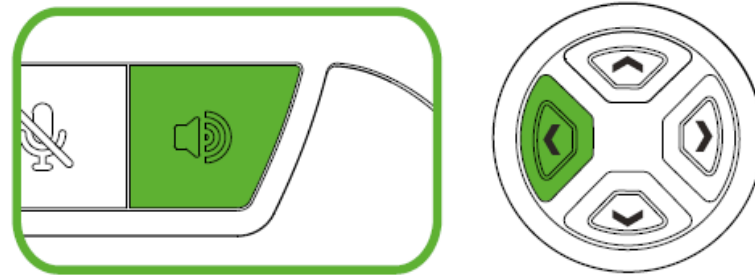

To increase the game volume and decrease the voice chat volume, press and hold the audio control button then press the directional pad's right button.



Note: The game/chat volume control is only applicable for the Xbox One gaming console.

INSTALLING RAZER SYNAPSE FOR XBOX

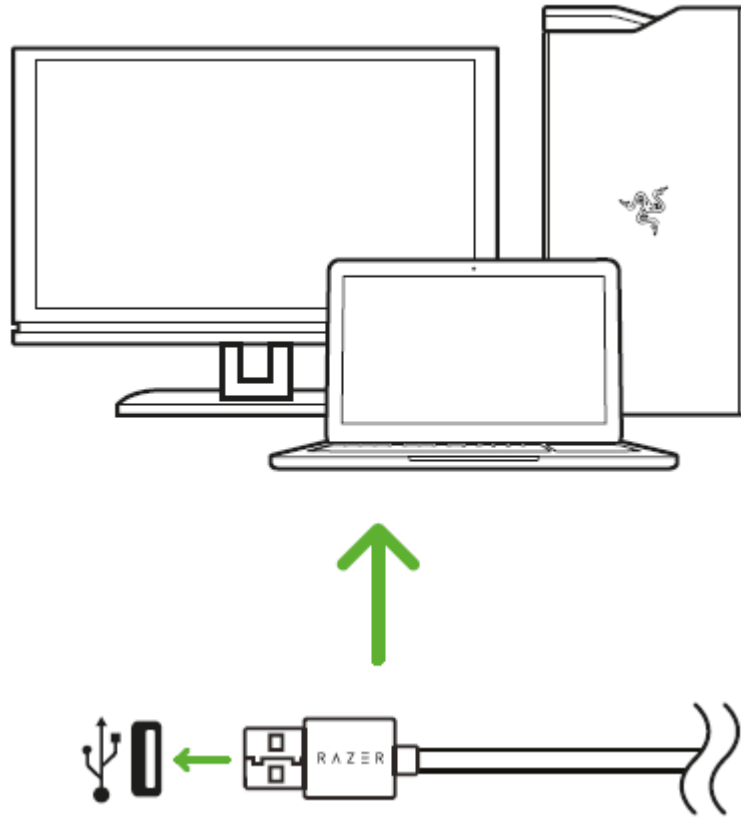







Step 1: Make sure your Razer device is connected to the USB port of your gaming console or PC.

Step 2: Download and install the Razer Synapse For Xbox app from the Xbox Store of your gaming console or from [razerzone.com/software](https://www.razerzone.com/software) on your PC.

CHROMA LIGHTING EFFECTS

Several lighting effects are made available for your Razer Wolverine Ultimate when you download and install the Razer Synapse For Xbox app. Listed below are the lighting effects which you can customize to your controller:

	Name	Description	How to set up
	Breathing	The lighting fades in and out of the selected color(s)	Select up to 2 colors or randomize colors
	Immersive	The LEDs will light up when the controller vibrates.	Select a color
	Reactive	The LEDs will light up when a button is pressed and will fade off after a specified period of time.	Select the length of time for the LEDs to remain lit.
	Spectrum cycling	The LEDs will cycle between 16.8 million colors indefinitely	No further customization required
	Static	The LEDs will remain lit in the selected color	Select a color
	Wave	The lighting will scroll in the direction selected	Select a wave direction

SAFETY AND MAINTENANCE

SAFETY GUIDELINES

In order to achieve maximum safety while using your Razer Wolverine Ultimate, we suggest that you adopt the following guidelines:

Should you have trouble operating the device properly and troubleshooting does not work, unplug the device and contact the Razer hotline or go to [razersupport.com](https://www.razer.com/support) for support. Do not attempt to service or fix the device yourself at any time.

Do not take apart the device (doing so will void your warranty) and do not attempt to operate it under abnormal current loads.

Keep the device away from liquid, humidity or moisture. Operate the device only within the specific temperature range of 0°C (32°F) to 40°C (104°F). Should the temperature exceed this range, unplug and/or switch off the device in order to let the temperature stabilize to an optimal level.

MAINTENANCE AND USE

The Razer Wolverine Ultimate requires minimum maintenance to keep it in optimum condition. Once a month we recommend you unplug the device from the computer and clean it using a soft cloth or cotton swab to prevent dirt buildup. Do not use soap or harsh cleaning agents.

LEGALESE

COPYRIGHT AND INTELLECTUAL PROPERTY INFORMATION

©2017 Razer Inc. All rights reserved. Razer, the triple-headed snake logo, Razer logo, "For Gamers. By Gamers.", and "Powered by Razer Chroma" logo are trademarks or registered trademarks of Razer Inc. and/or affiliated companies in the United States or other countries. All other trademarks and trade names are the property of their respective owners and other company and product names mentioned herein may be trademarks of their respective companies.

This product is manufactured under license from Microsoft Corporation. Microsoft, Windows, the Windows Logo, Xbox, Xbox LIVE, Xbox One, and the Xbox logos are trademarks of the Microsoft group of companies.

Razer Inc. ("Razer") may have copyright, trademarks, trade secrets, patents, patent applications, or other intellectual property rights (whether registered or unregistered) concerning the product in this guide. Furnishing of this guide does not give you a license to any such copyright, trademark, patent or other intellectual property right. The Razer Wolverine Ultimate (the "Product") may differ from pictures whether on packaging or otherwise. Razer assumes no responsibility for such differences or for any errors that may appear. Information contained herein is subject to change without notice.

LIMITED PRODUCT WARRANTY

For the latest and current terms of the Limited Product Warranty, please visit: [razerzone.com/warranty](https://www.razer.com/warranty).

LIMITATION OF LIABILITY

Razer shall in no event be liable for any lost profits, loss of information or data, special, incidental, indirect, punitive or consequential or incidental damages, arising in any way out of distribution of, sale of, resale of, use of, or inability to use the Product. In no event shall Razer's liability exceed the retail purchase price of the Product.

COSTS OF PROCUREMENT

For the avoidance of doubt, in no event will Razer be liable for any costs of procurement unless it has been advised of the possibility of such damages, and in no case shall Razer be liable for any costs of procurement liability exceeding the retail purchase price of the Product.

GENERAL

These terms shall be governed by and construed under the laws of the jurisdiction in which the Product was purchased. If any term herein is held to be invalid or unenforceable, then such term (in so far as it is invalid or unenforceable) shall be given no effect and deemed to be excluded without invalidating any of the remaining terms. Razer reserves the right to amend any term at any time without notice.