



RAZER PRO TYPE ERGO

MASTER GUIDE

CONTENTS

1. WHAT'S INSIDE	2
2. WHAT'S NEEDED	3
3. LET'S GET YOU COVERED	4
4. GETTING STARTED	5
6. USING YOUR RAZER PRO TYPE ERGO	9
7. CONFIGURING YOUR RAZER PRO TYPE ERGO	12
8. SAFETY AND MAINTENANCE	31
9. LEGALESE	34

1. WHAT'S INSIDE

- Razer Pro Type Ergo

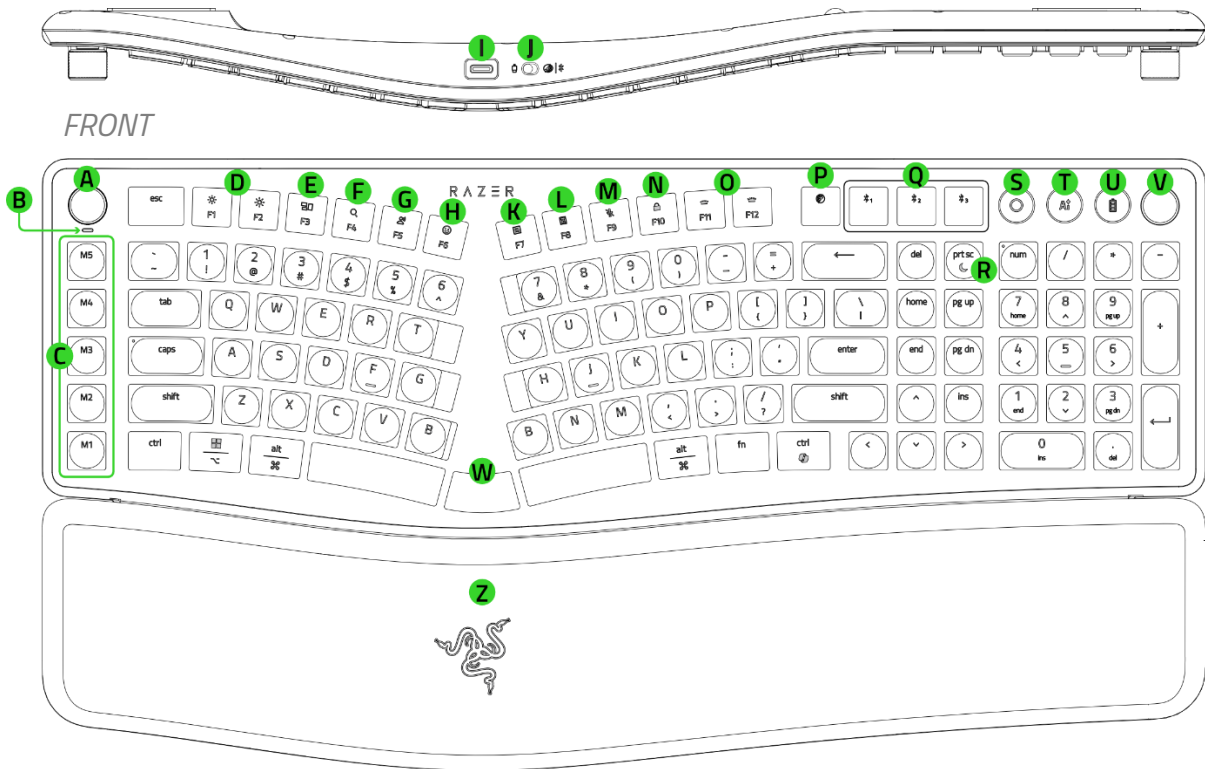

- A. Razer Command Dial
- B. Command Dial mode indicator LED
- C. Dedicated Macro keys
- D. Screen brightness keys
- E. Task View / Mission Control key*
- F. Search key
- G. Dictation key
- H. Emoji / Character Viewer key*
- I. USB Type C port
- J. Mode switch
- K. Context Menu key
- L. Calculator key
- M. Mute / Unmute microphone key
- N. Screen lock key
- O. Backlight control keys
- P. Razer HyperSpeed mode key (2.4 GHz)
- Q. Bluetooth profile keys
- R. Sleep mode key
- S. Multi-function media button
- T. AI Prompt Master button
- U. Battery life / status button
- V. Multi-function roller
- W. Middle key**

*Function may vary per operating system.

**Mapped to Backspace by default.



- X. Kickstand
- Y. Wireless dongle compartment[†]
- Z. Integrated wrist rest

[†]Accessible under the bottom-left kickstand.

- Razer HyperSpeed Wireless Dongle

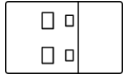

- USB Type A to Type C cable

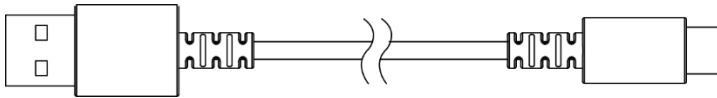

- Important Product Information Guide

2. WHAT'S NEEDED

PRODUCT REQUIREMENTS

- USB Type A port or Bluetooth connectivity

RAZER SYNAPSE REQUIREMENTS

- Windows® 11
- Internet connection for software installation

3. LET'S GET YOU COVERED



You've got a great device — now make it even better. Register your warranty at razerid.razer.com to get covered and unlock exclusive Razer benefits.

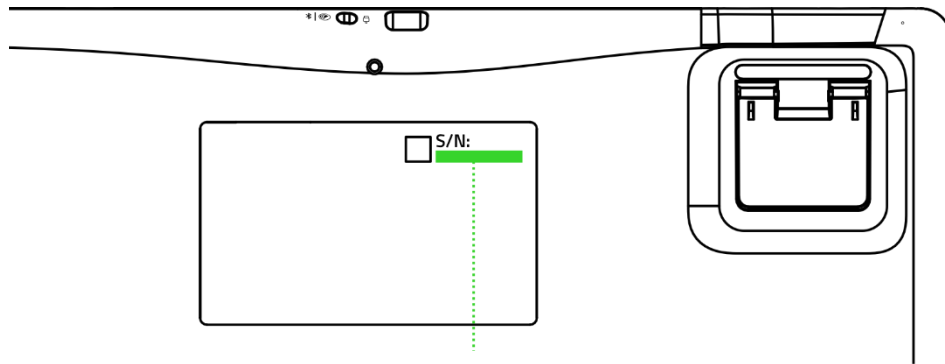

Your product's serial number can be found here.

4. GETTING STARTED

CHARGING YOUR KEYBOARD

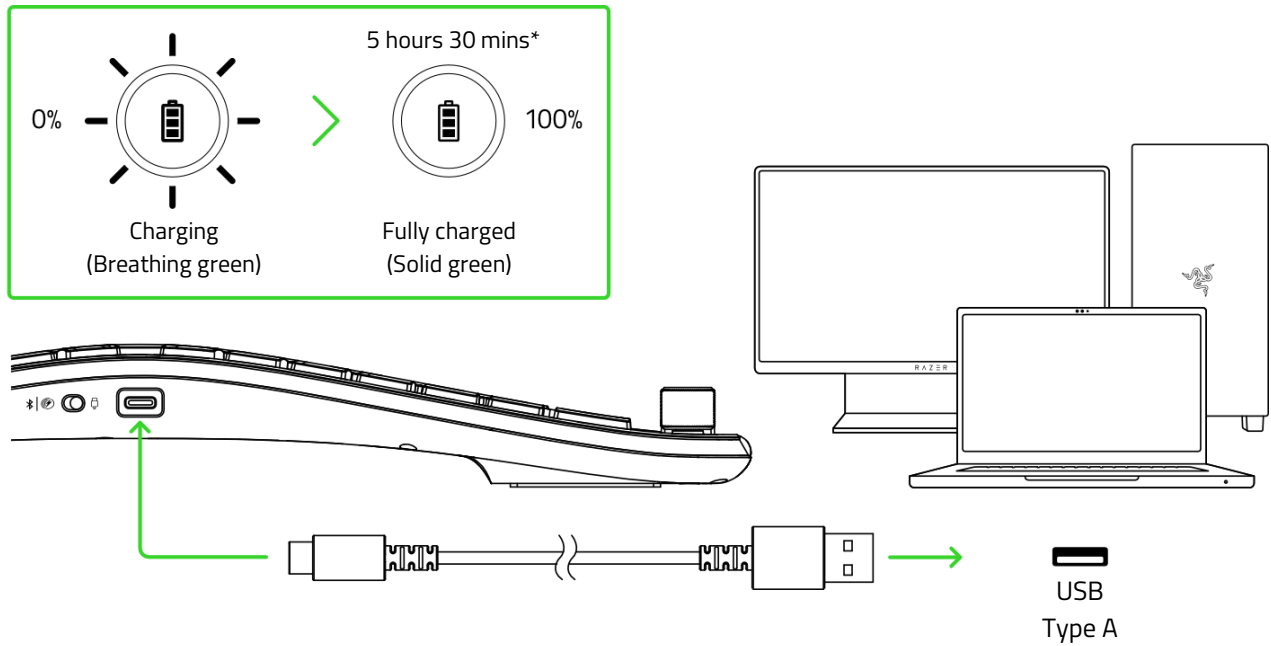

**Charging times vary. Faster charging times can be expected when using an external USB power adapter or a power outlet.*

i For best results, fully charge your keyboard before using it for the first time. You may continue using the keyboard while plugged in.

CONNECTING TO YOUR KEYBOARD

A. Via Razer HyperSpeed Wireless mode (2.4 GHz)

1.

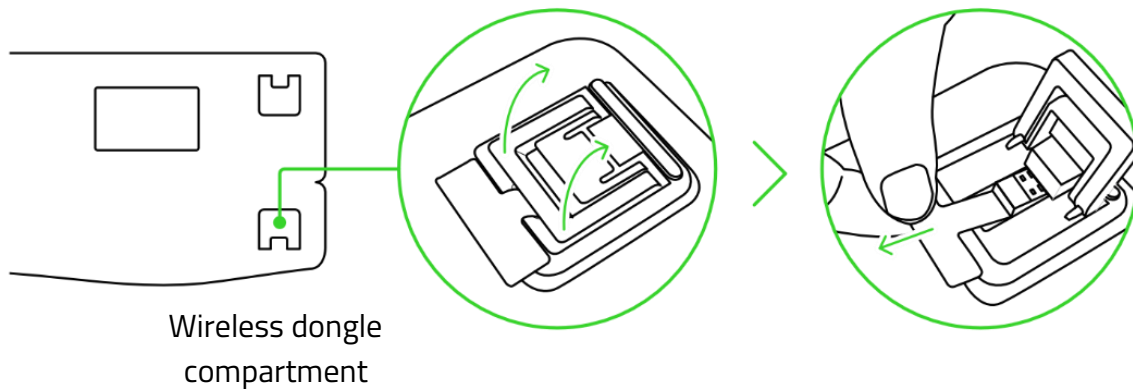

2.

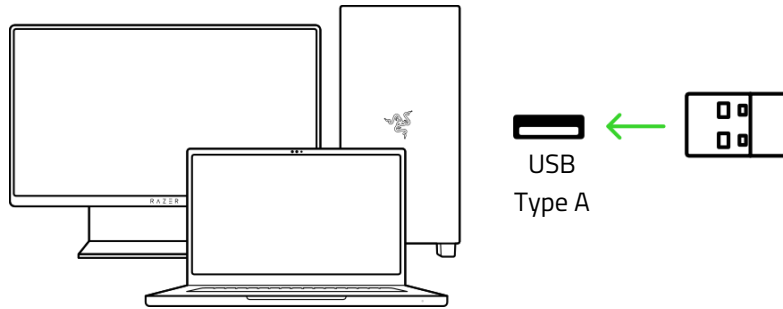

3.

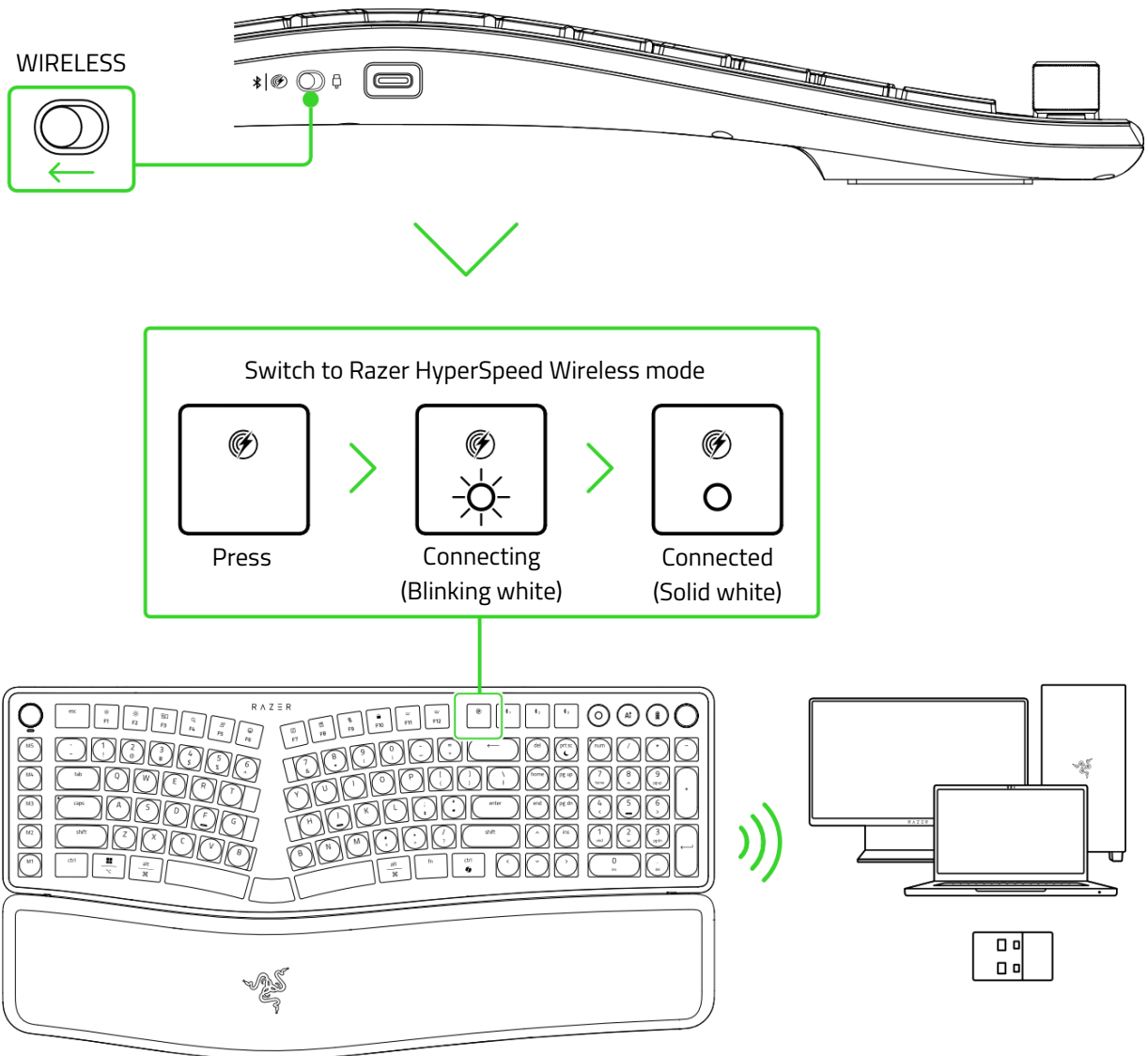

i For initial set up only.

Your keyboard is now ready to use in Razer HyperSpeed Wireless mode (2.4 GHz).

B. Via Bluetooth mode

1.

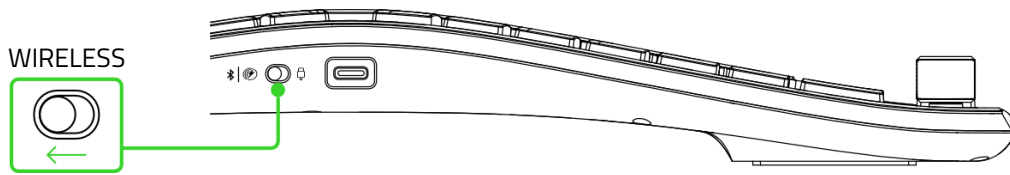

2.

Switch to Bluetooth mode / Select a Bluetooth profile

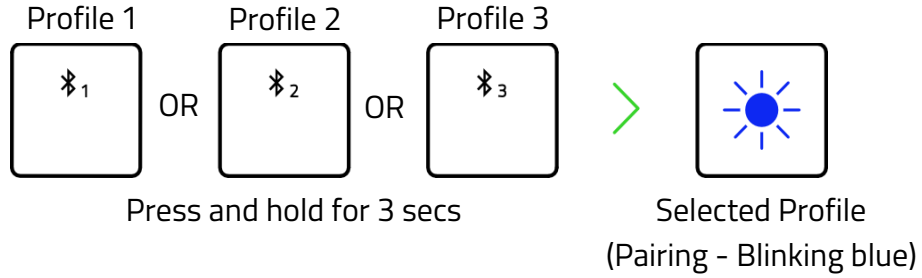

The Bluetooth profile button will briefly show the selected Bluetooth profile. Your keyboard can pair up to 3 devices using its Bluetooth profiles.

3.

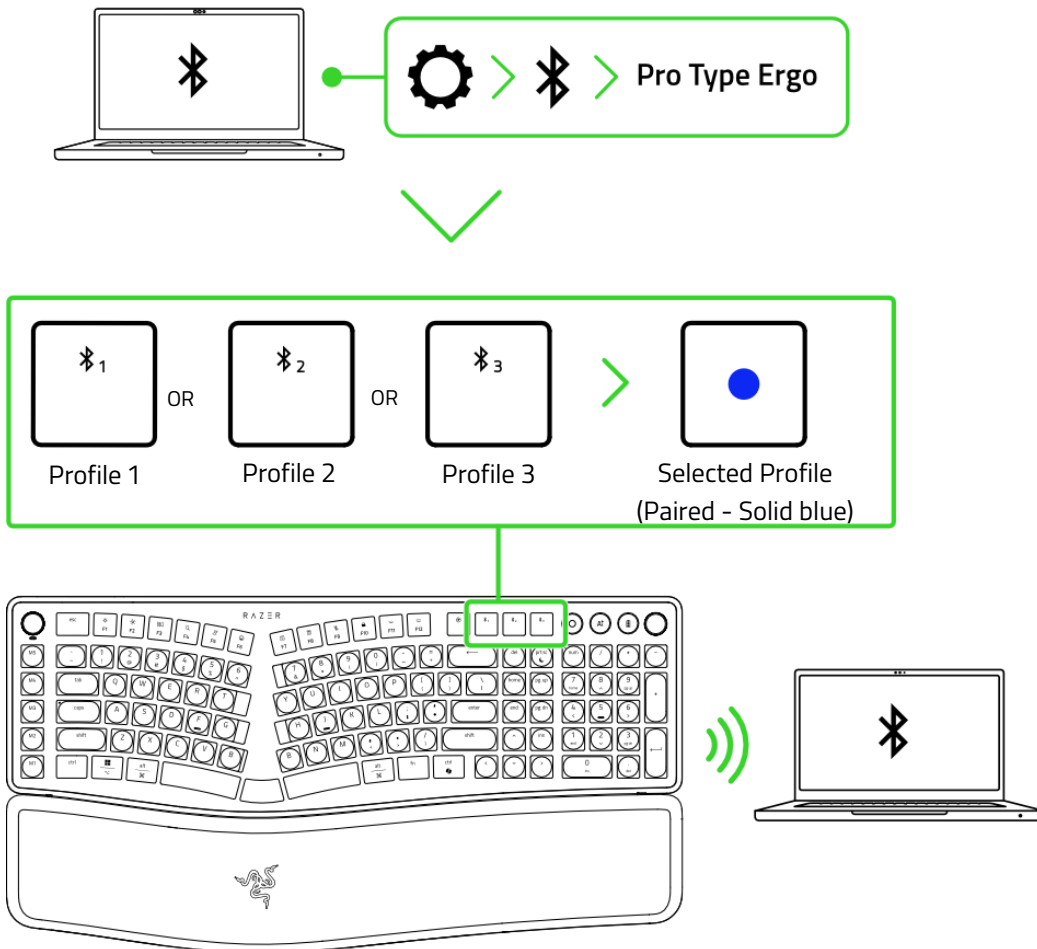

Your keyboard is now ready to use in Bluetooth mode.

Reactivating Bluetooth pairing mode (for new devices)

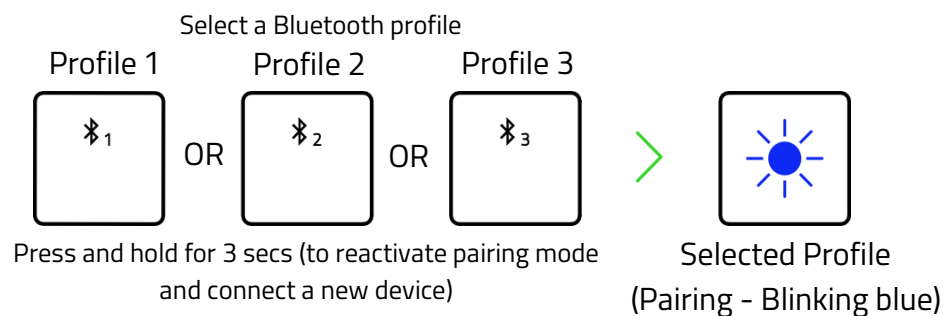

C. Via Wired mode

1.

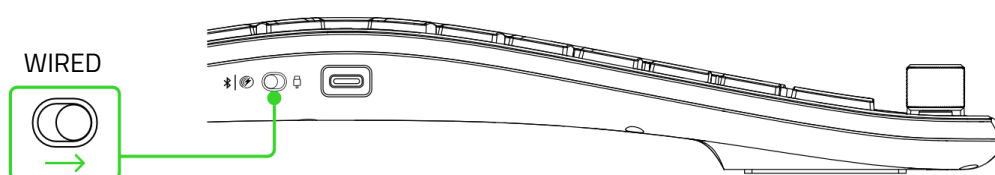

2.

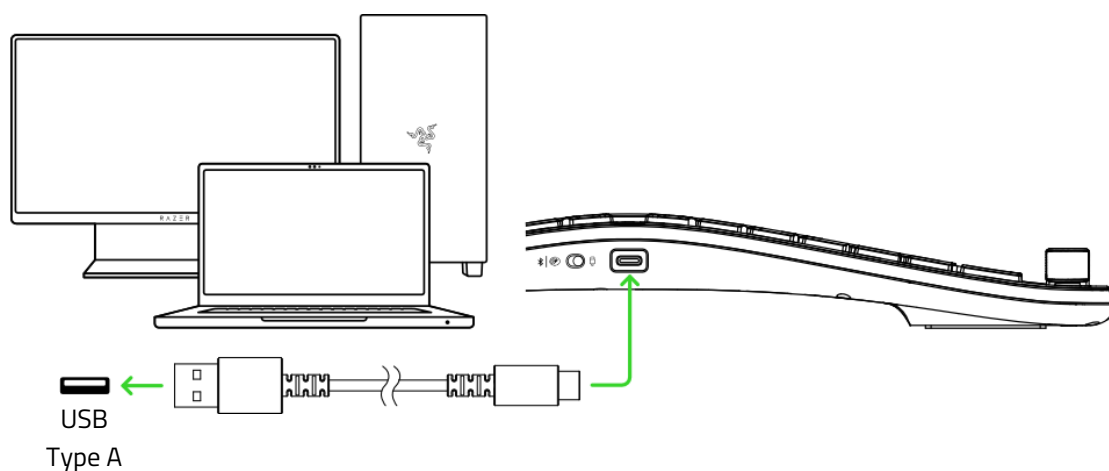

i Install Razer Synapse when prompted, or download the installer from razer.com/synapse

Your keyboard is now ready to use in wired mode.

6. USING YOUR RAZER PRO TYPE ERGO

SWITCHING BETWEEN WIRELESS MODES

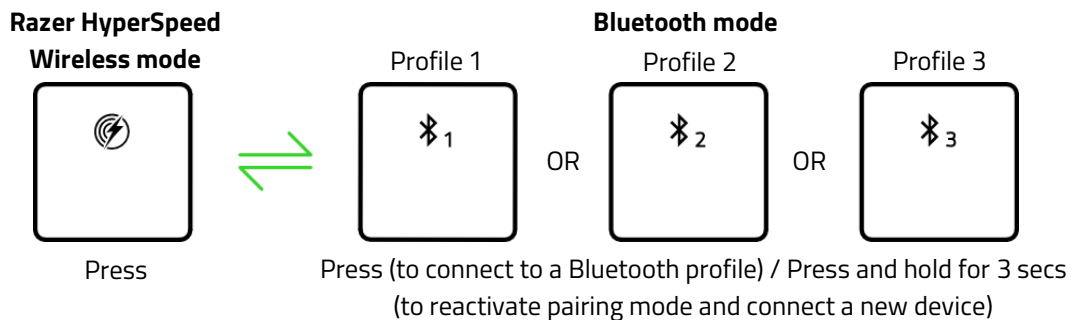

SWITCHING BETWEEN OS LAYOUTS

On systems without Razer Synapse, press the key combination to switch between Windows and Mac layouts as needed.

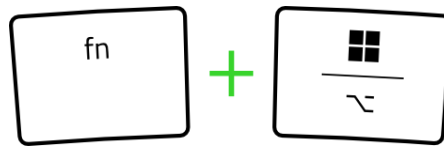

i When available, Razer Synapse automatically sets the keyboard layout to match your OS. The selected layout stays active even after the keyboard is powered off and on again.

SWITCHING BETWEEN RAZER COMMAND DIAL MODES*

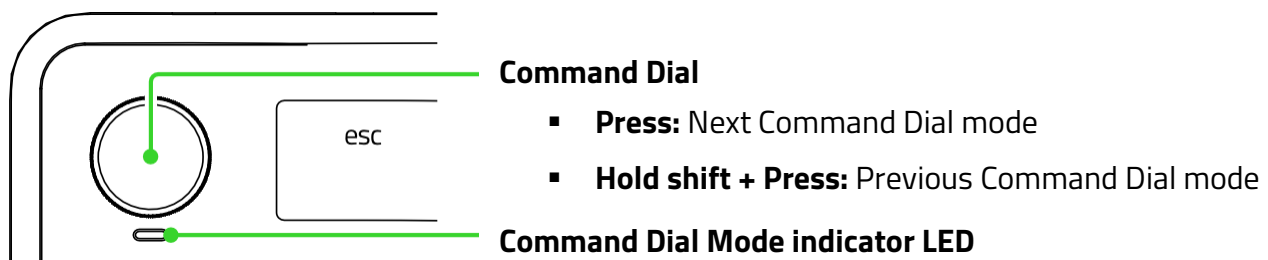

Command Dial Modes	Command Dial Mode indicator LED	Scroll Up / Down
Lighting Brightness (Default)	Green	(☰ / ☷) Adjust the keyboard's brightness
Zoom	Red	(⌕ / 🔍) Zoom in / out

Switch Apps	Blue	(⇧ / ⌘) Switch between apps (alt + tab / alt + shift + tab)
Track Jogging	Yellow	Fast forward or rewind media

**Out-of-the-box settings only.*

i Other Razer Command Dial modes can be enabled and customized via the Razer Synapse app.

MULTI-FUNCTION ROLLER*

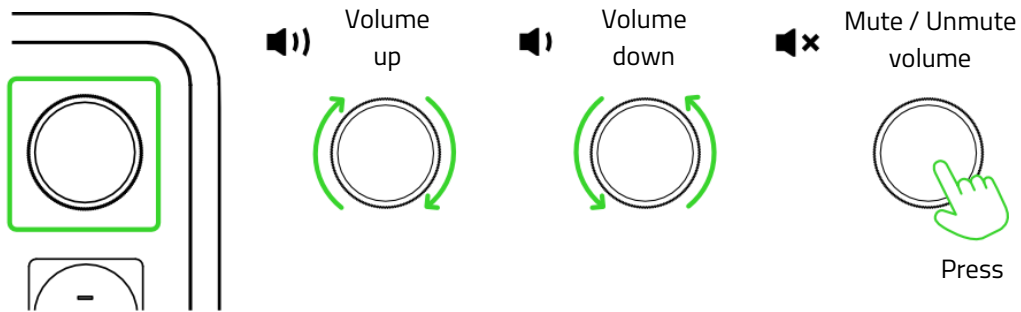

AI PROMPT MASTER*



i Requires Razer Synapse.

LOW BATTERY NOTIFICATION

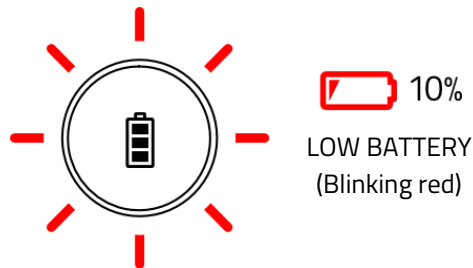

i This notification will repeat until the keyboard is drained or charged.

BATTERY LIFE / STATUS BUTTON

Activating / Deactivating Power Saving Mode

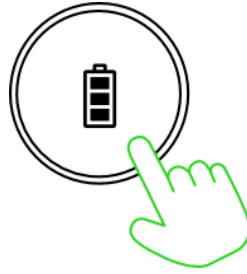

Press and hold for 3s

i In Power Saving Mode, the keyboard conserves battery by reducing its polling rate, turning off the keyboard lighting, and pausing Synapse connectivity.

Checking the battery level

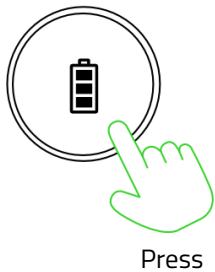

Press

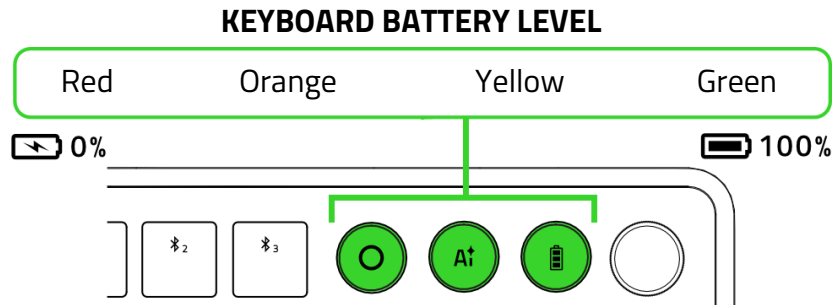

CHROMA EFFECTS

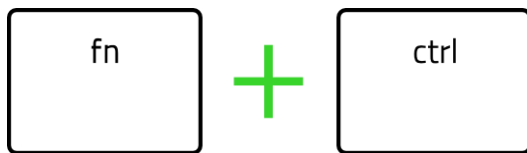

Hotkey	Chroma effect
fn + ctrl + 1	Off
fn + ctrl + 2	Static*
fn + ctrl + 3	Breathing*

Hotkey	Chroma effect
fn + ctrl + 4	Spectrum cycling
fn + ctrl + 5	Wave**

*Press again to change color.

**Press again to change direction.

i Use the Razer Synapse app to customize your keyboard's lighting effects and access other advanced features available on your keyboard.

7. CONFIGURING YOUR RAZER PRO TYPE ERGO

i *Disclaimer: This guide provides an overview of the New Razer Synapse app and may only partially cover some of the features of your device. The New Razer Synapse requires an Internet connection to install, update, access, and save cloud-based features. Registering for a Razer ID account is recommended but optional. All features listed here are subject to change based on the current version, connected device(s), and supported add-ons.*

SYNAPSE

The Synapse tab is your default tab when you first launch Razer Synapse. Use the following buttons below to navigate the user interface:

— Minimize

Clicking this button will minimize the app to the taskbar while it runs in the background.

☐ Maximize

This button expands the browser window to fill the entire screen. To restore the window to its original size, click the maximize button again.

✕ Close

This button will close all relevant tabs and terminate the application completely.

< Previous Tab

Clicking this button will return you to the last tab you have visited.

> Next Tab

Clicking this button will move you to the next page if you've recently used the Previous Tab button.

🔄 Refresh Tab

This button reloads the current page. Use this if a page isn't displaying correctly or you want to see the latest content.

⬇️ Download Update

If this button appears, that means there are changes to the app. Use this if a page isn't displaying correctly or you want to see the latest content.

☰ More

Clicking this button will open a pop-up so you can easily access your Devices, Modules, and Other Installed Apps tabs.

⚙ Settings

Clicking this button will open the Settings tab, so you can quickly change the settings to this app.

👤 Profile

This button will open a pop-up to access the Log In, Feedback, Rate This Software, Add WiFi Device, and Exit options.

❓ Info

Hovering over this button will pop up an additional information about a feature or function.

Dashboard

The Dashboard subtab is an overview of your Razer Synapse, where you can access all your Razer devices, modules, and online services.

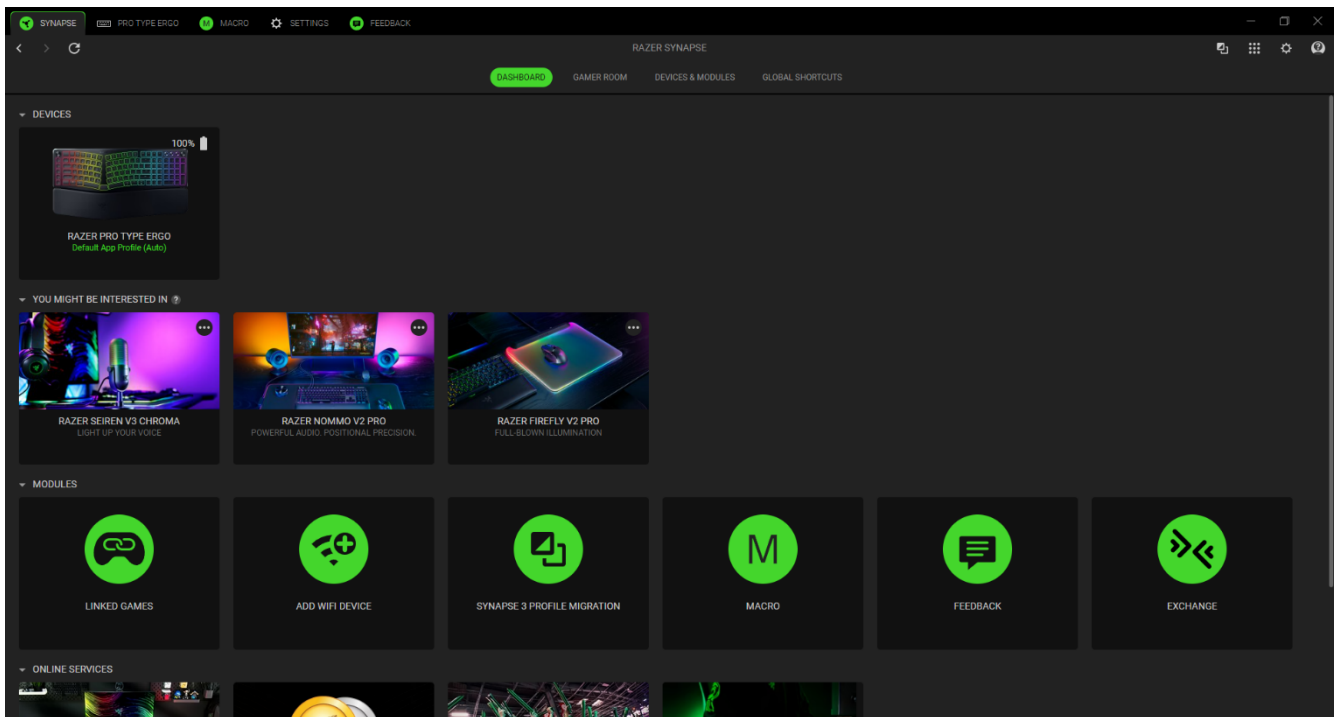

Gamer Room

The Gamer Room subtab shows all devices with the Razer Aether Light feature. From here, you can view and manage your Gamer Room-supported devices.

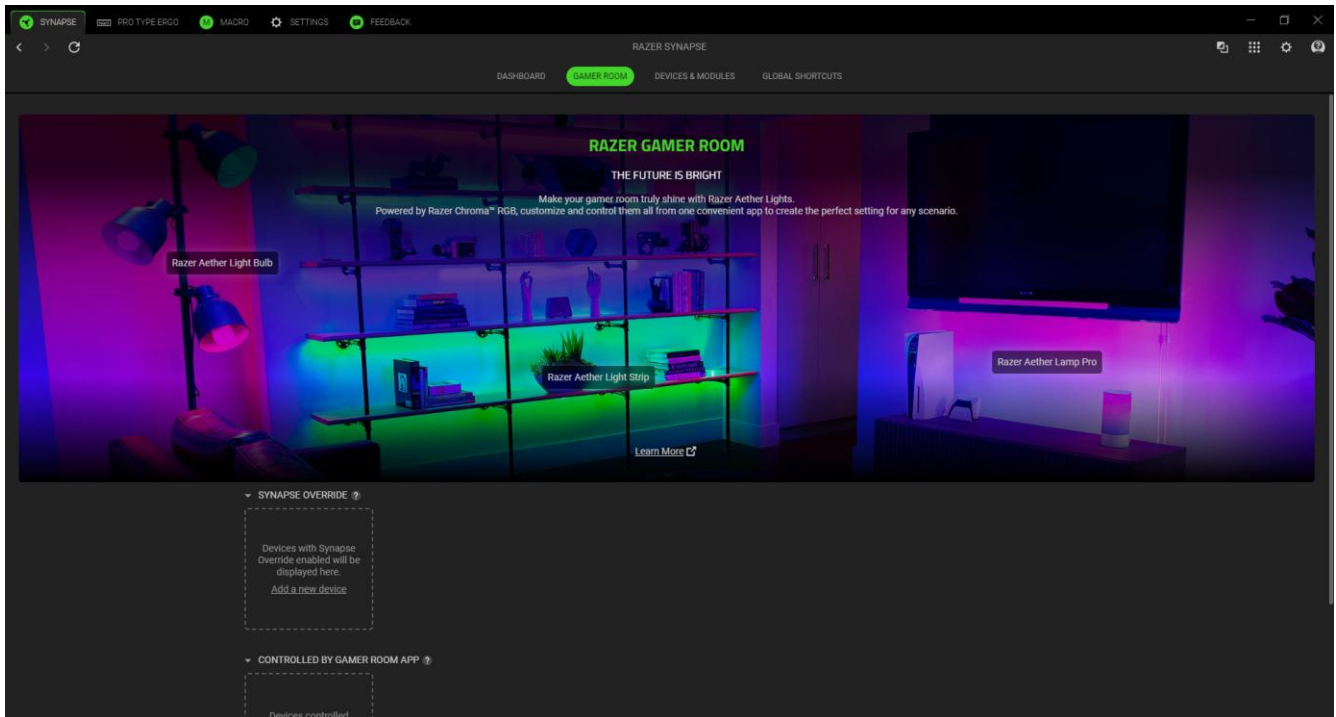

Synapse Override

This section allows you to select and customize your device's lighting and make it react to Chroma-enabled games and Chroma Connect apps using Razer Synapse.

Controlled By Gamer Room App

This section displays all supported devices controlled remotely by the Gamer Room app.

Devices & Modules

The Modules subtab displays all installed and available modules for installation.

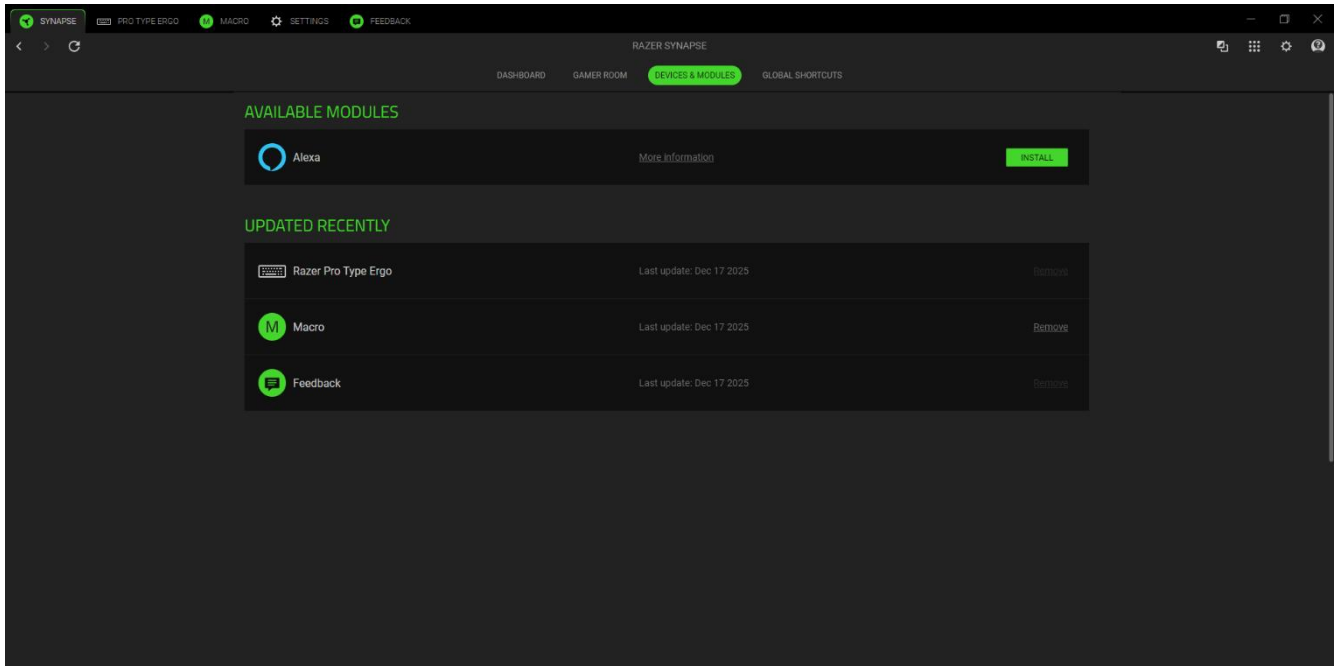

Global Shortcuts

Bind operations or Razer Synapse functions to custom key-combinations from any Razer Synapse-enabled device inputs, which apply across all device profiles.

! *Only Razer Synapse-enabled device inputs will be recognized.*

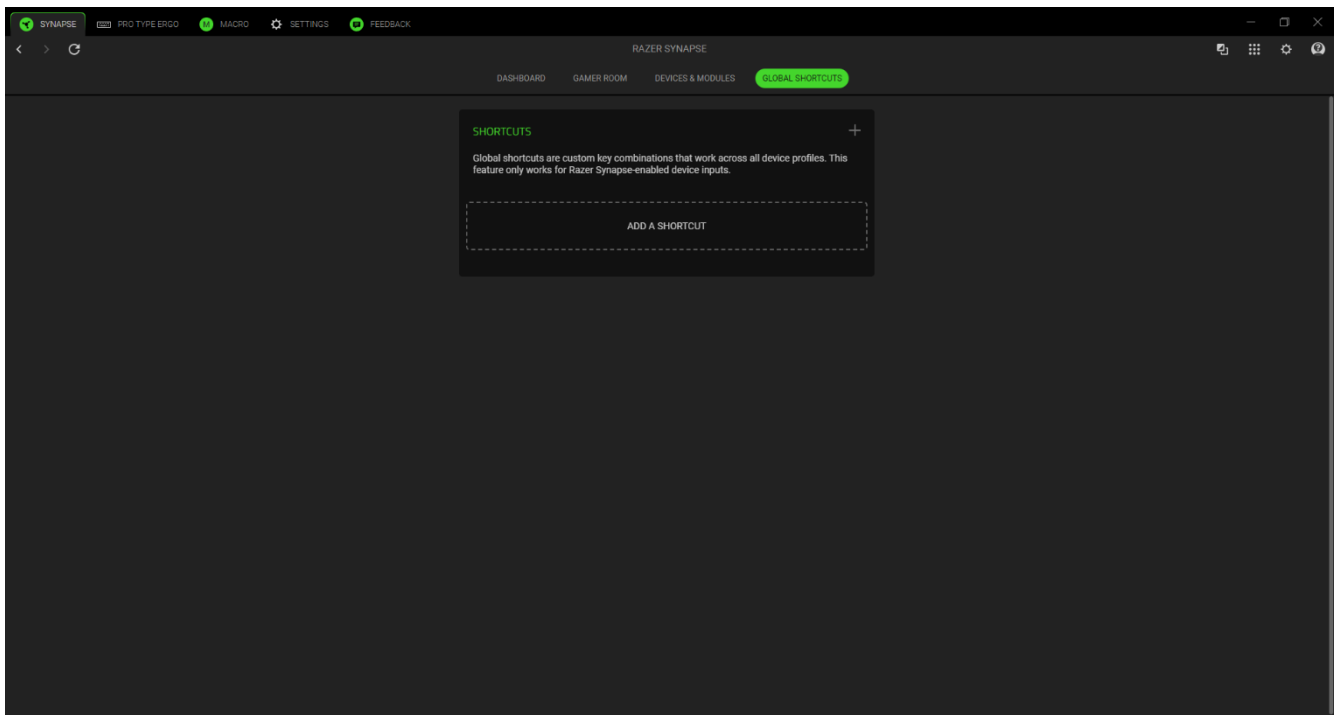

PRO TYPE ERGO

The Pro Type Ergo tab is the main tab for your Razer keyboard. You can change your device settings from here, such as key assignments, lighting, and power consumption. Any changes under this tab will be saved automatically to your local system and cloud storage.

 Refresh

Clicking this button refreshes the page to ensure the latest settings are applied and up to date.

Customize

The Customize subtab is for modifying your keyboard's command dial, key assignments, app profile-specific settings, gaming mode, and other properties.

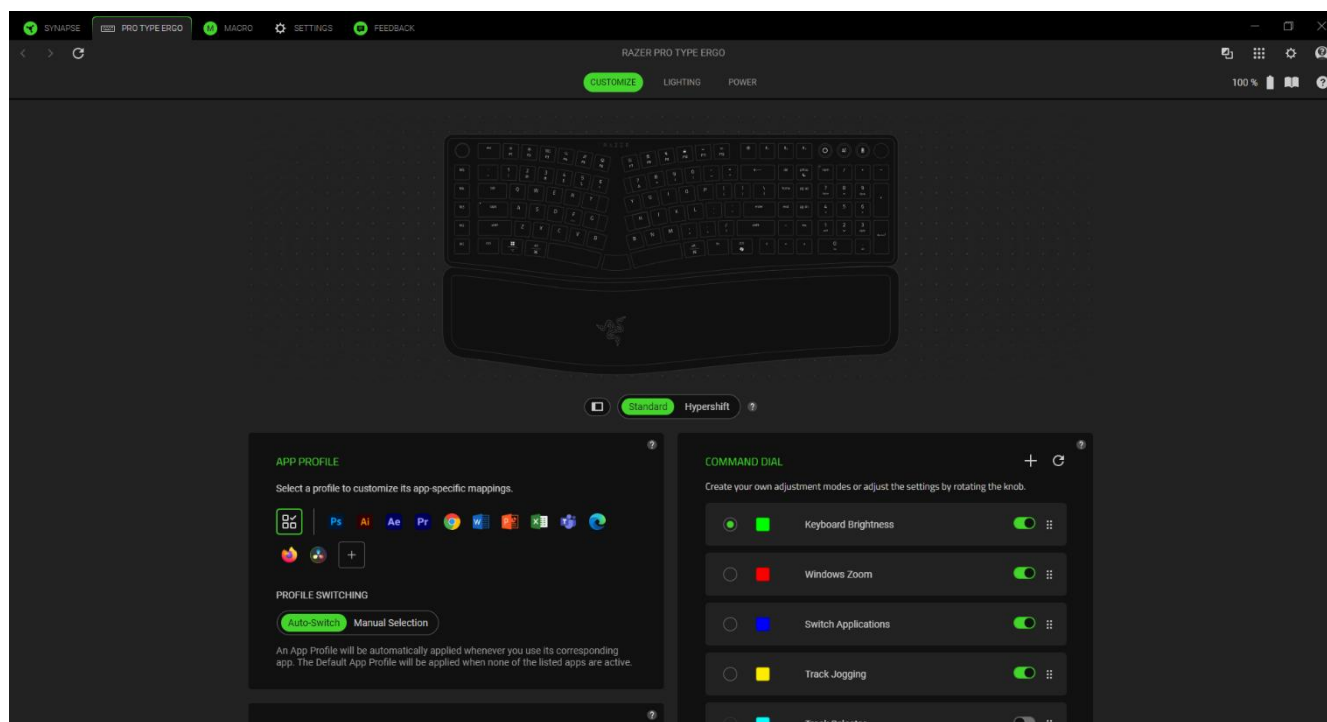

App Profile

An App Profile stores all your Razer peripheral settings for each selected application, allowing you to customize mappings and preferences per app. You can use the available app presets or create your own by clicking the Add an app button (+). When none of the listed apps are active, the Default App Profile will be applied.

Profile Switching

By default, profiles auto-switch to match the active app, ensuring the correct key assignments are applied seamlessly. When set to Manual Selection, the selected profile remains active even if its associated app is not running.

Hypershift

Hypershift mode is a secondary set of key assignments that is activated when the Hypershift key is held down. By default, the Hypershift key is assigned to the fn key of your device, however, you can also assign any key as a Hypershift key.

Gaming Mode

When Gaming Mode is active, the Windows key is automatically disabled to prevent accidental interruptions during gameplay. Based on your settings, you can also disable Alt + Tab and Alt + F4, and choose to apply Gaming Mode only while in-game.

Function Key Primary

Switch the function keys (F1–F12) between standard Function Keys and Multimedia Keys. By default, they work as Multimedia Keys and can be used with a single press. When set to Function Keys, you'll need to hold the fn key to access the secondary multimedia functions.

Keyboard Properties

Allows you to open the Windows Keyboard Properties where you can modify other keyboard settings such as Repeat delay, Repeat Rate, and Cursor blink rate, or view all keyboard drivers installed in your PC.

Command Dial

Enable new modes for the Command Dial such as Track Selector, Vertical Scrolling, Horizontal Scrolling, and Switch Browser Tabs. Create custom modes using the Add button (+), edit commands for each mode by hovering over it and clicking the Miscellaneous button (...), or delete modes with the Bin button (🗑). You can also reorder Command Dial modes via drag-and-drop or reset all changes to default using the Reset button (↺).

Remap Menu

Clicking the Remap Menu button () will reveal all current assignments for your Razer Keyboard and allow you to change their assignments.

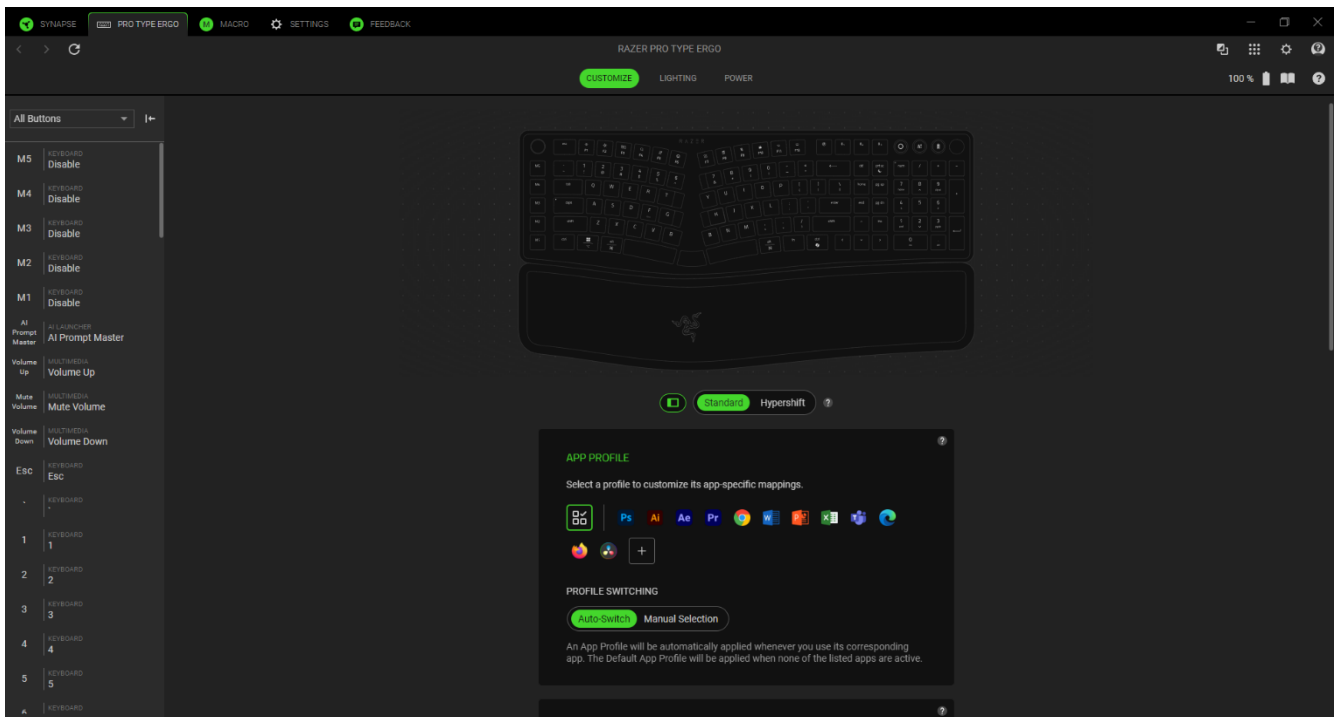

Alternatively, you can skip a specific assignment by selecting it on the Customize tab.

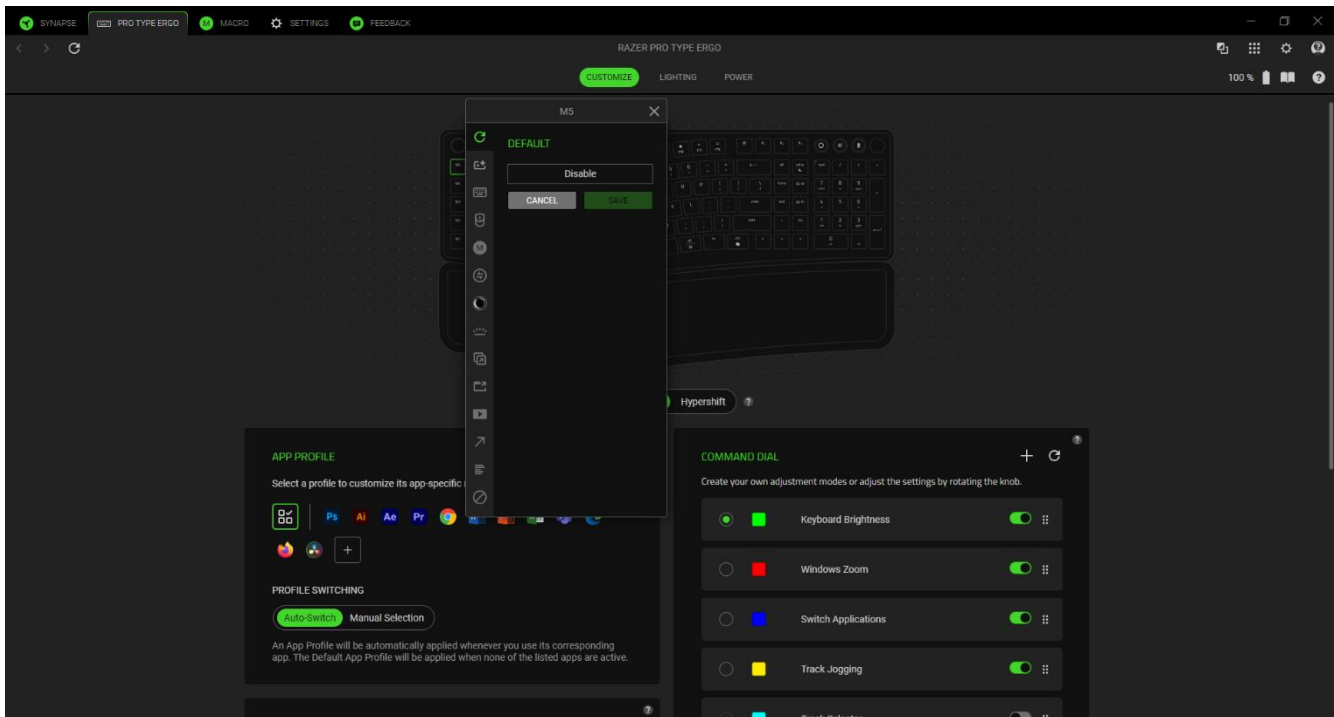

Upon selecting an assignment, you may then change it to one of the following functions:

Default

This option enables you to return the selected key to its original setting.

AI Launcher

When mapped to a key, this opens a window overlay for issuing AI queries. You can start the overlay on either the AI Prompt Master tab or the AI Chat tab.

App Specific

Available only for Razer Presets. This option lets you assign app-specific shortcuts or custom app commands to a selected key.

Keyboard Function

This option changes the key assignment into a keyboard function. You can also choose to enable Turbo mode, which allows you to emulate repeatedly pressing the keyboard function while the key is held down.

Mouse Function

This option allows you to change any key into a mouse function. Listed below are the functions which you can choose from:

- Left Click - Performs a left mouse click using the assigned key.
- Right Click - Performs a right mouse click using the assigned key.
- Scroll Click - Activates the universal scrolling function.
- Double Click - Performs a double left click using the assigned key.
- Scroll Up - Performs a "Scroll Up" command using the assigned key.
- Scroll Down - Performs a "Scroll Down" command using the assigned key.
- Mouse Button 4 - Performs a "Backward" command for most internet browsers.
- Mouse Button 5 - Performs a "Forward" command for most internet browsers.
- Scroll Left - Performs a "Scroll Left" command using the assigned key.
- Scroll Right - Performs a "Scroll Right" command using the assigned key.

You can also choose to enable Turbo mode in some of the mouse functions, which allow you to emulate repeatedly pressing and releasing said function while the key is held down.

Macro

A Macro is a prerecorded sequence of keystrokes and button presses that is executed with precise timing. By setting the key function to Macro, you can conveniently execute a chain of commands. This function will only be visible when the Macro module is installed.

Inter-device

Inter-device allows you to change the functionality of other Razer Synapse-enabled devices. Some of these functionalities are device-specific such as using your Razer gaming keyboard to change the Sensitivity Stage of your Razer gaming mouse.

Switch Chroma Effect

Switch Chroma Effect allows you to easily switch between all Chroma Effect Profiles in Chroma Studio. This function will only be visible when the Chroma Studio module is installed.

Device Brightness

Assign the chosen key to turn your device's LED lighting bright or dim; or toggle them on/off.

Razer Hypershift

Setting the key to Razer Hypershift will allow you to activate Hypershift mode if the key is held down.

Launch

Launch Program lets you open an app or a website using the assigned key. When you select Launch Program, two choices will appear, requiring you to search for a specific app you want to open or write the website address you want to visit.

Multimedia

This option allows you to assign multimedia controls to your Razer device. Listed below are the multimedia controls you can choose from:

- Volume Down - Decreases the audio output.
- Volume Up - Increases the audio output.
- Mute Volume - Mutes the audio.
- Mic Volume Up - Increases the microphone volume.
- Mic Volume Down - Decreases the microphone volume.

- Mute Mic - Mutes the microphone.
- Mute All - Mutes both microphone and audio output.
- Play / Pause - Play, pause, or resume current media playback.
- Previous Track - Play the previous media track.
- Next Track - Play the next media track.

↗ Windows Shortcuts

This option allows you to assign your preferred key into a Windows Operating System shortcut command. For more information, please visit: support.microsoft.com/kb/126449

☰ Text Function

Text Function enables you to type a prewritten text with a touch of a key. Simply write your desired text on the given field, and your text will be typed whenever the assigned key is pressed. This function has full Unicode support, and you can also insert special symbols from character maps.

⊘ Disable

This option renders the assigned key unusable. Use Disable if you do not want to use the selected key or if it interferes with your gaming.

Lighting

The Lighting subtab enables you to modify your Razer device's light settings.

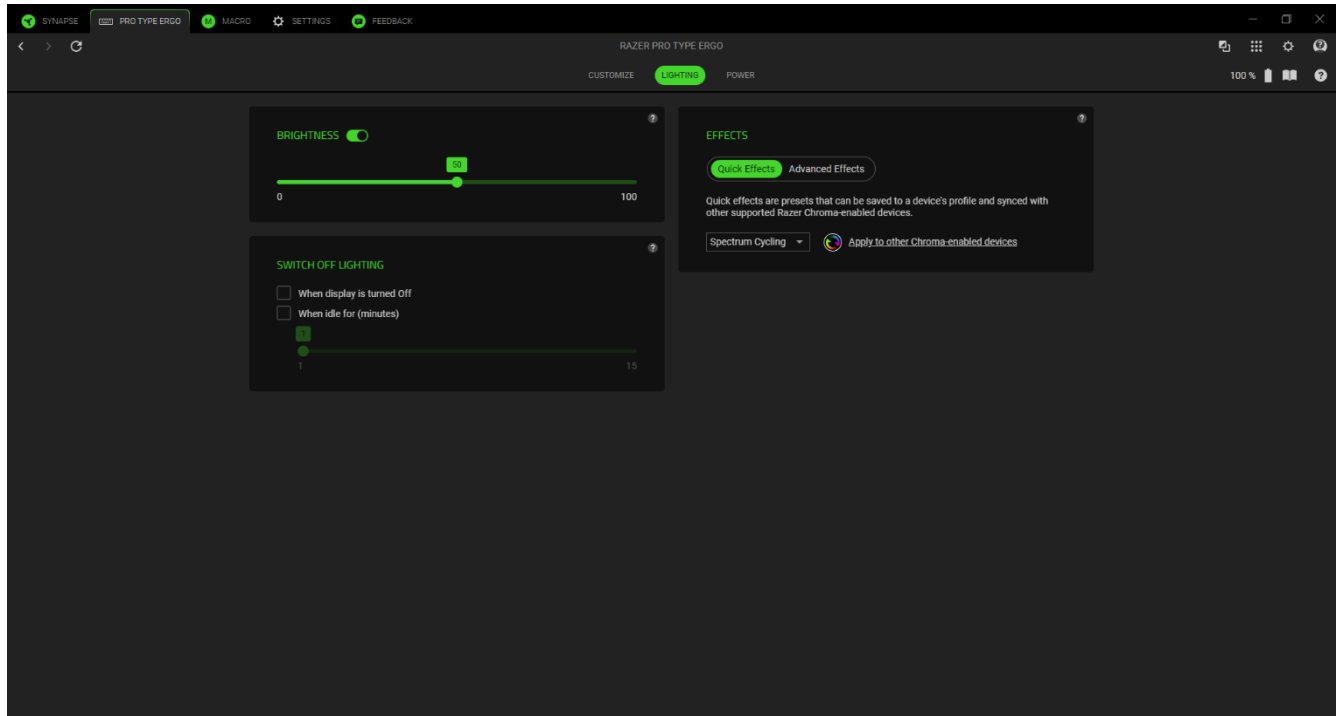

Brightness



You can turn off your Razer device's lighting by toggling the Brightness option or increase/decrease the luminance using the slider.



Switch Off Lighting

This is a power saving tool which allows you to disable your device's lighting in response to your system's display turning off and/or automatically power down when your Razer keyboard has been idle for a set amount of time.

Quick Effects

A number of quick effects can be selected and applied to your device's lighting, as listed here:

	Name	Description	How to set up
	Breathing	The keyboard fades in and out of the selected color(s)	Select up to 2 colors or randomize colors
	Spectrum cycling	The lighting will cycle between 16.8 million colors indefinitely	No further customization required

	Static	The LEDs will remain lit in the selected color	Select a color
	Wave	The lighting will scroll in the direction selected	Select either left-to-right or right-to-left wave direction

If you have other supported Razer Chroma-enabled devices, you can synchronize their quick effects with your Razer device by clicking the Chroma Sync button ().

Advanced Effects

The Advanced Effects option allows you to choose a Chroma Effect Profile you want to use on your Razer Chroma-enabled peripheral. To start making your own Chroma Effect Profile, press the Launch Chroma Studio button ().

 *Only other Razer devices that support the selected lighting effect will synchronize.*

Power

The Power subtab allows you to manage your device's energy consumption when running on batteries.

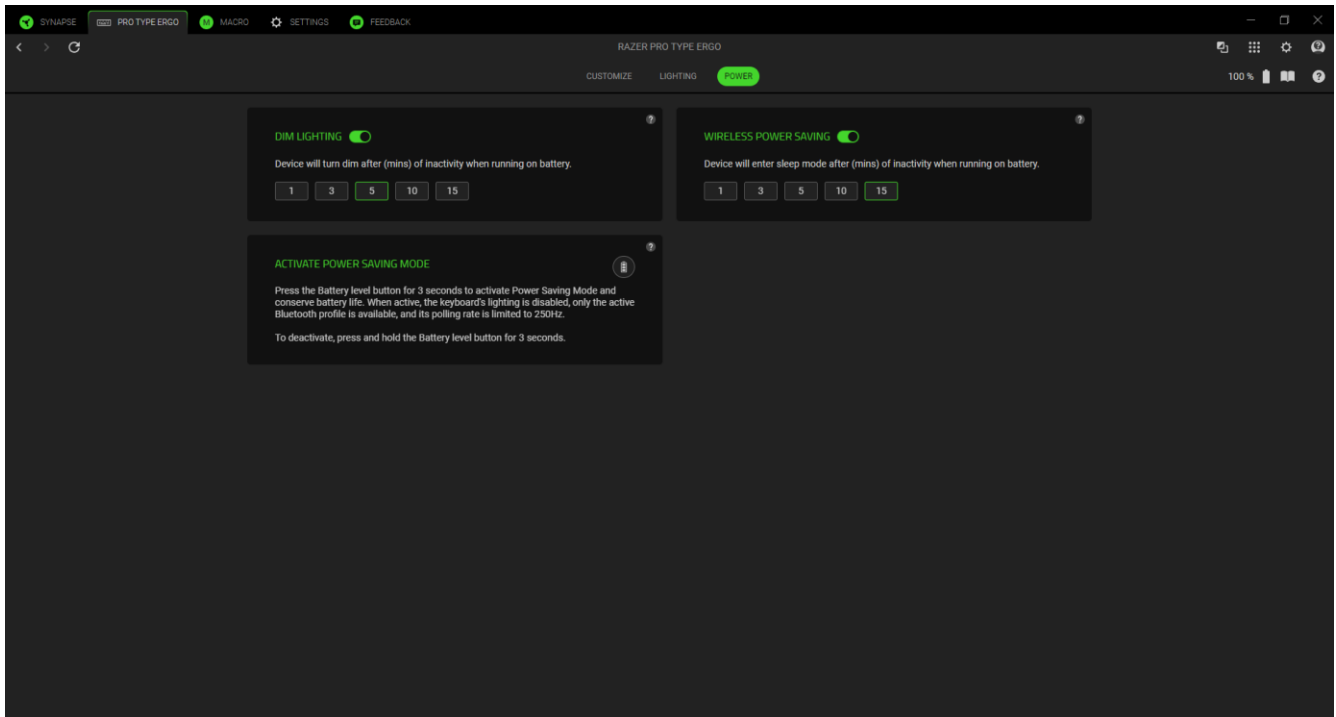

Dim Lighting

Set how long your device should be idle when running on battery before it lowers its brightness or toggle the feature off.

Wireless Power Saving

Set your device to enter sleep mode after a chosen period of inactivity or toggle power saving off.

MACRO

If you need to execute a series of complex commands accurately, you need a macro. A macro is a set of recorded keystrokes, button presses, and cursor movements. that you can bind to your device and execute at any time.

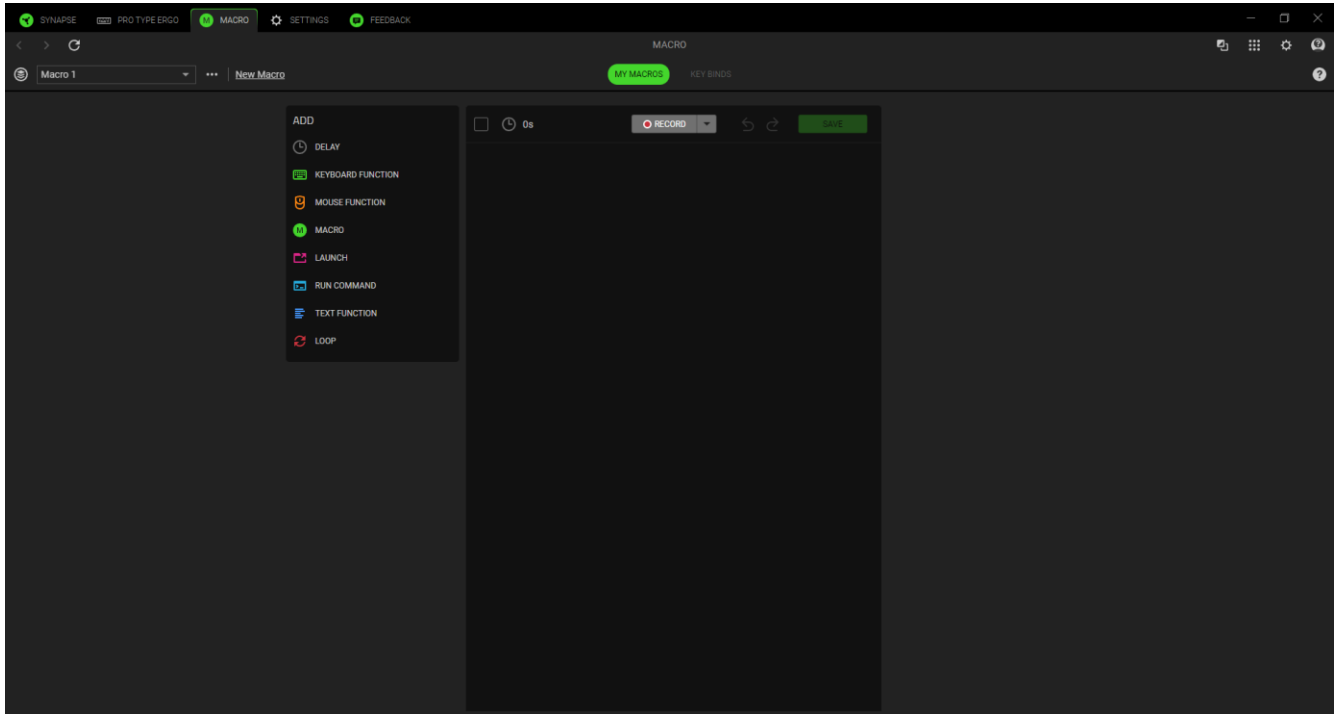

My Macros

The My Macros subtab allows you to create, edit, and organize these macros to assign them to your Razer device's keys or buttons. Use the following buttons below to access your macro options:



Clicking this dropdown bar will display all the macros for this device. From here, you can search for a specific macro, sort your macros, create a new folder, and create a new macro. Selecting a macro will enable miscellaneous options such as renaming, duplicating, or deleting the macro.

... Miscellaneous

Clicking this button will open a pop-up with options related to your current macro.

New Macro

Use this link to create and select the new macro quickly.

Once you have a macro, you can record keystrokes, button presses, and cursor movements. by clicking the Record button () or you can customize the macro by clicking the dropdown menu button () before you start recording with the following options below:

- **Start Delay.** Set a short delay between 1 and 5 seconds before the recording starts.
- **Shortcut Key.** Assign a shortcut key to start a macro recording even when Razer Synapse is in the background.
- **Delay Settings.** Set the amount of time between each command.
- **Mouse Movement Tracking.** Enable mouse movement recording and set conditions for how it is recorded.

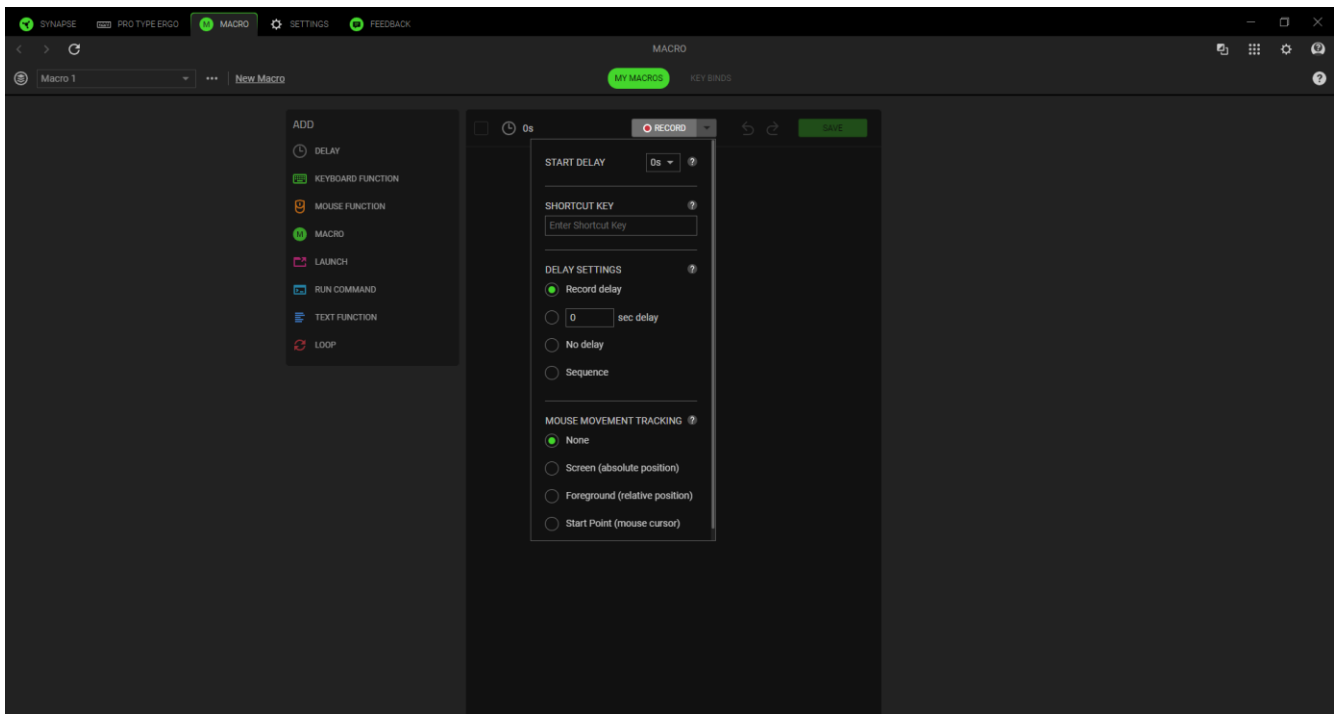

After recording your macro commands, click the Stop button () or press the Shortcut key to end the session. Once you have recorded a macro, you may edit the commands you have entered by selecting each command on the macro screen. Each keystroke or button press is arranged sequentially, with the first command at the top of the screen.

The Insert menu on the left side of the screen allows you to add delays, input keystrokes and button presses, insert an entire macro group within the macro, launch apps, run commands, type texts, and loop a set of commands within the macro.

Key Binds

The Key Binds subtab allows you to view the Shortcut Keys for the selected macro. You can bind a macro to the key or button of your choice without leaving the Macro tab by clicking the Assign Macro To Your Devices button (+).

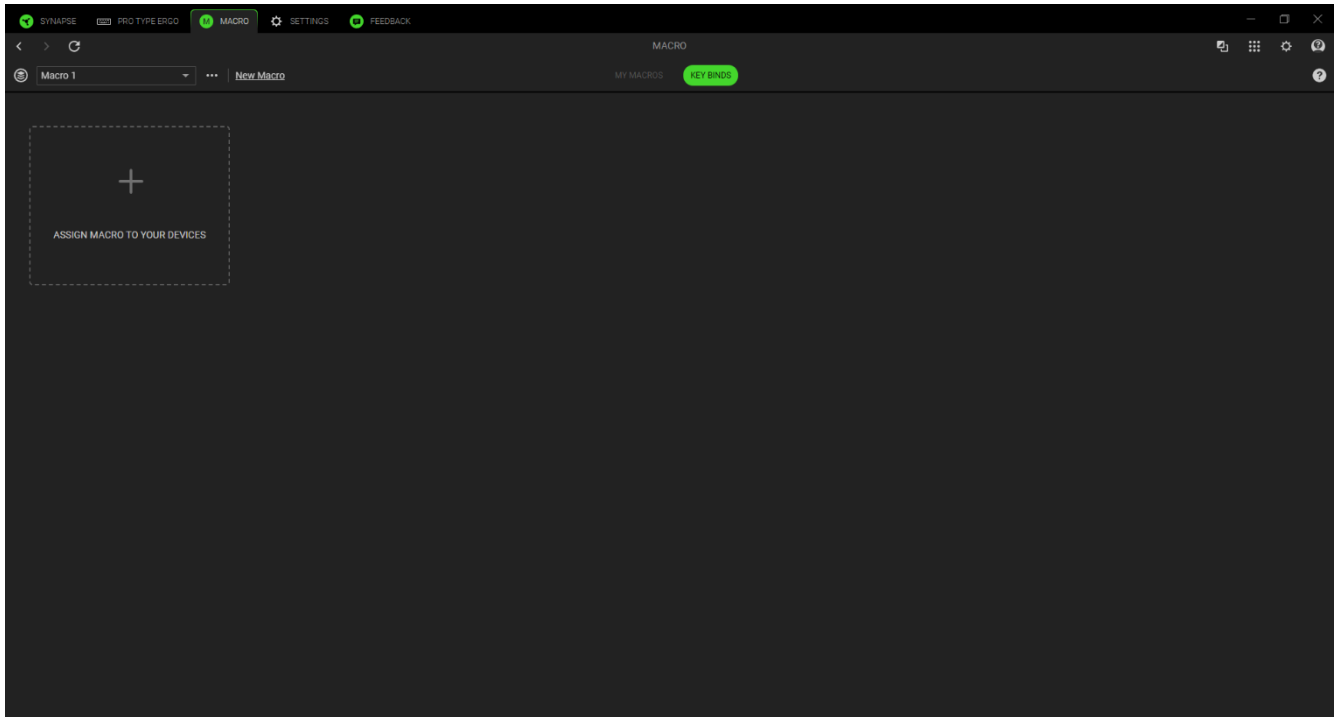

SETTINGS

The Settings tab, accessible by clicking the Settings button (⚙️), enables you to configure numerous options as listed below:

Synapse

The Synapse subtab is where you can find options that are specific to the app.

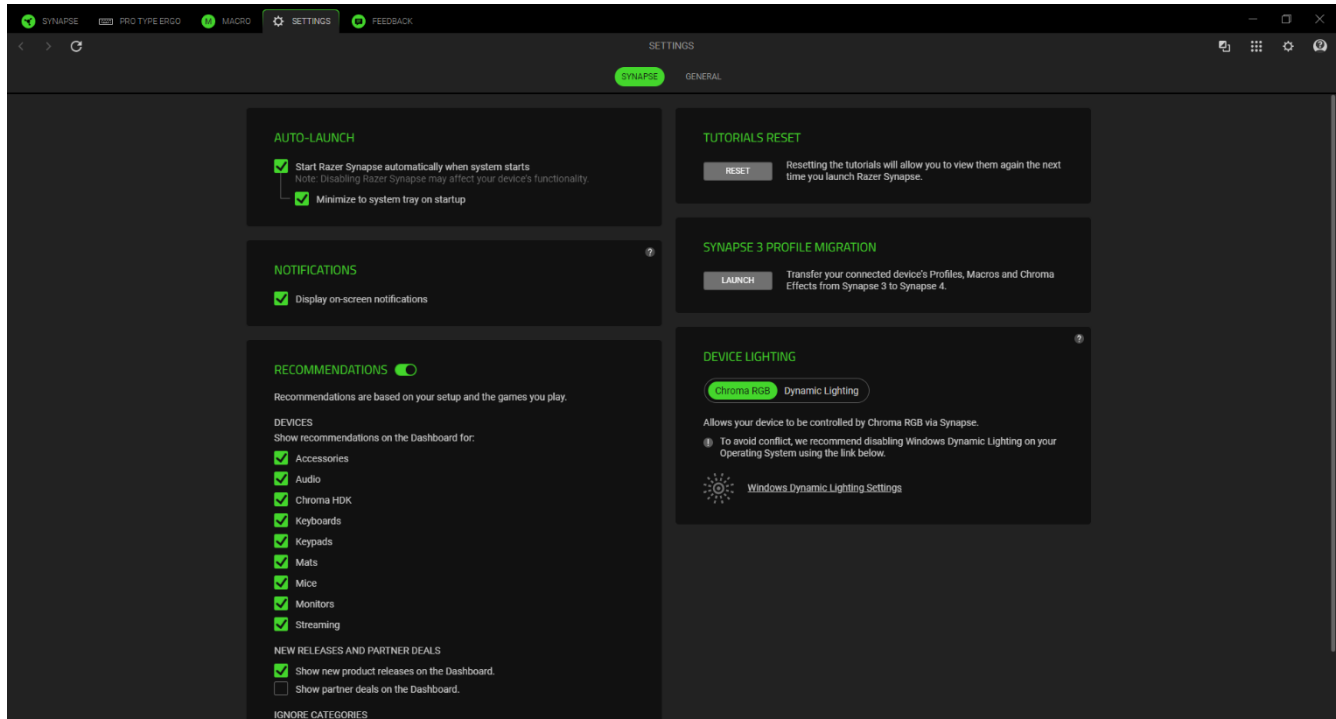

Auto Launch

The Auto Launch option allows you to configure the startup behavior the app.

Notifications

The Notifications option allows the app to display on-screen notifications even if you run full-screen apps.

Recommendations

Recommendations enable us to show the latest products and features on your Dashboard based on your installed devices and linked games.

Tutorials Reset

Selecting the Reset button will reactivate all tutorials that help you acquaint yourself with Razer Synapse's features.

Synapse 3 Profile Migration

This function lets you transfer all your device's Profiles, Macros, and Chroma Effects from Synapse 3 to the new Synapse.

Device Lighting

This option lets you choose which app will control the lighting effects on your device.

General

The General subtab is the section where you can access miscellaneous options for your app, as well as find additional information about the software.

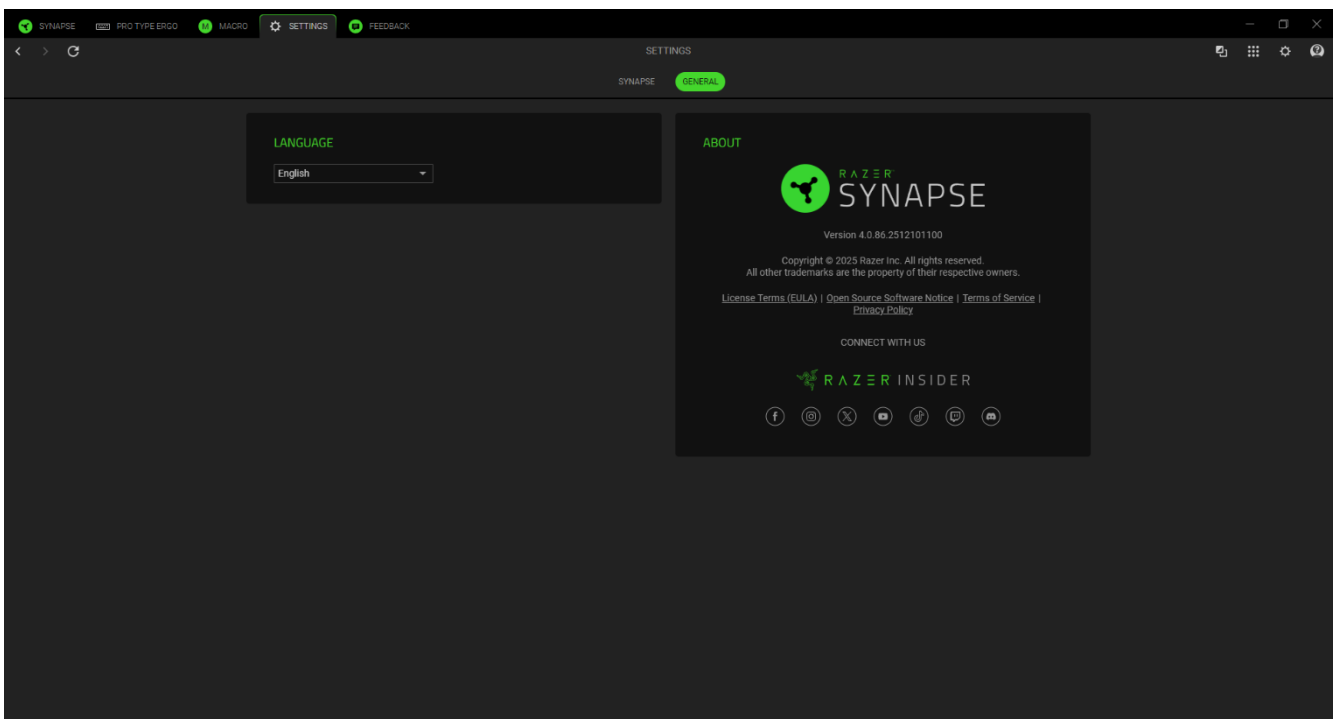

Language

This option lets you change the display language of Razer Synapse.

About

The About section shows the current software version, displays the copyright statement, and provides relevant links for Razer's terms of use. You may also use this option to access Razer's social communities quickly.

FEEDBACK

Help us improve Razer Synapse by giving your comments, suggestions, and problems with the software. You can contact us directly using this tab and even earn rewards for reporting bugs.

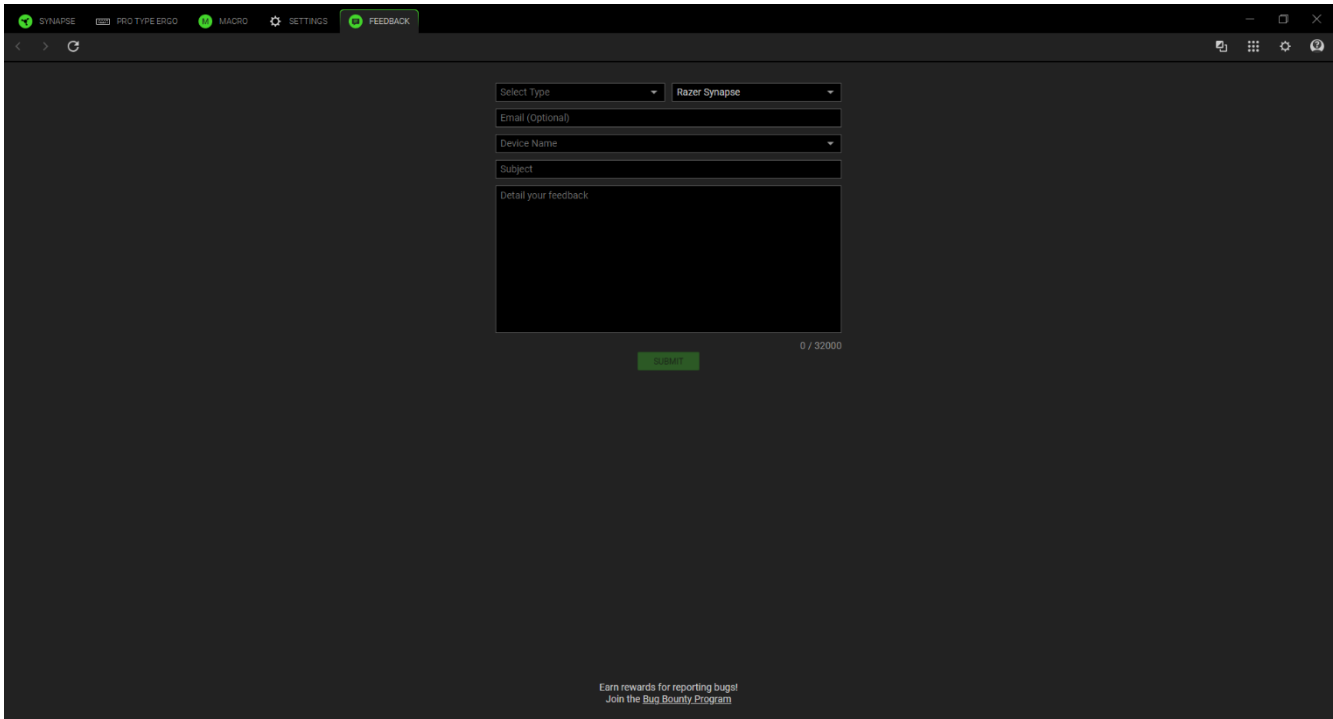

8. SAFETY AND MAINTENANCE

SAFETY GUIDELINES

To achieve maximum safety while using your Razer Pro Type Ergo, we suggest that you adopt the following guidelines:

Should you have trouble operating the device properly and troubleshooting does not work, unplug the device and contact the Razer hotline or go to support.razer.com for support.

Keep the keyboard and all its parts and accessories out of the reach of small children to avoid accidents and/or injuries.

Don't take apart the device, and do not attempt to operate it under abnormal current loads. Doing so will void your warranty.

Keep the device away from liquid, humidity or moisture. Operate the device only within the specific temperature range of 0°C (32°F) to 40°C (104°F). Should the temperature exceed this range, unplug and/or switch off the device to let the temperature stabilize to an optimal level.

COMFORT

Research has shown that long periods of repetitive motion, improper positioning of your computer peripherals, incorrect body position, and poor habits may be associated with physical discomfort and injury to nerves, tendons, and muscles. Below are some guidelines to avoid injury and ensure optimum comfort while using your Razer Pro Type Ergo.

1. Position your keyboard and monitor directly in front of you with your mouse next to it. Place your elbows next to your side, not too far away, and your keyboard within easy reach.
2. Adjust the height of your chair and table so that the keyboard and mouse are at or below elbow height.
3. Keep your feet well supported, posture straight, and your shoulders relaxed.
4. During gameplay, relax your wrist and keep it straight. If you do the same tasks with your hands repeatedly, try not to bend, extend or twist your hands for long periods.
5. Don't rest your wrists on hard surfaces for long periods.
6. Customize the keys on your keyboard to suit your gaming style and minimize repetitive or awkward motions.
7. Don't sit in the same position all day. Get up, step away from your desk, and do exercises to stretch your arms, shoulders, neck, and legs.

If you should experience any physical discomfort while using your keyboard, such as pain, numbness, or tingling in your hands, wrists, elbows, shoulders, neck or back, please consult a qualified medical doctor immediately.

MAINTENANCE AND USE

The Razer Pro Type Ergo requires minimum maintenance to keep it in optimum condition. Once a month, we recommend you unplug and switch off the device from the computer and clean it using a soft cloth or cotton swab to prevent dirt buildup. Don't use soap or harsh cleaning agents.

BATTERY WARNING

The Razer Pro Type Ergo contains a Li-ion rechargeable battery. In general, the life expectancy of such batteries is dependent upon usage. If you suspect that the Li-ion rechargeable battery inside the Razer Pro Type Ergo may be drained (has a low charge), try charging it.

Caution: Don't open, mutilate, or expose to conducting materials (metal), moisture, liquid, fire, or heat. Doing so may cause batteries to leak or explode, resulting in personal injury. Battery life varies with usage.

BATTERY INFO

The Razer Pro Type Ergo is designed with user-replaceable batteries. The user may properly remove and replace the batteries to ensure the device operates correctly and to prolong its lifespan. To replace the battery, please follow these steps:

1. Using a screwdriver, remove all screws from the back panel of the keyboard.

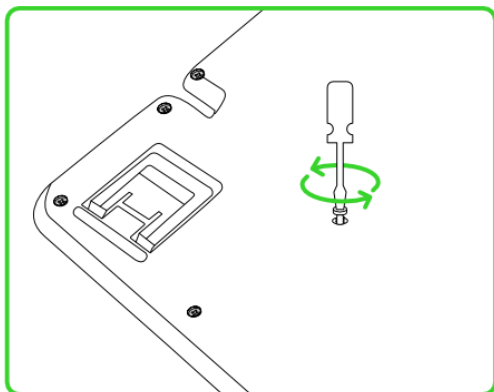

2. Gently separate the keyboard casing and remove the back cover.

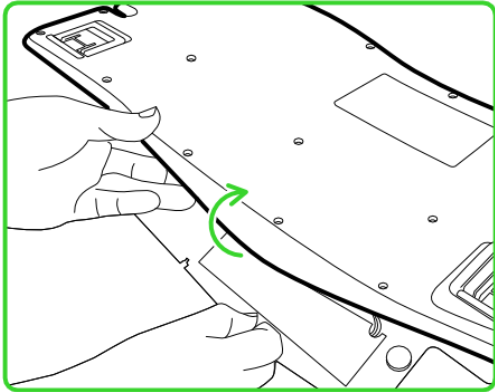

3. Remove the battery cover to access the battery, and carefully lift it out of the keyboard.

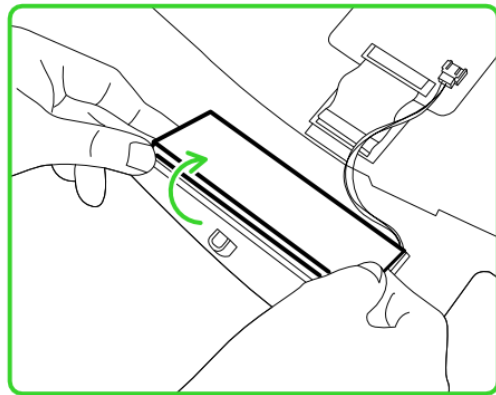
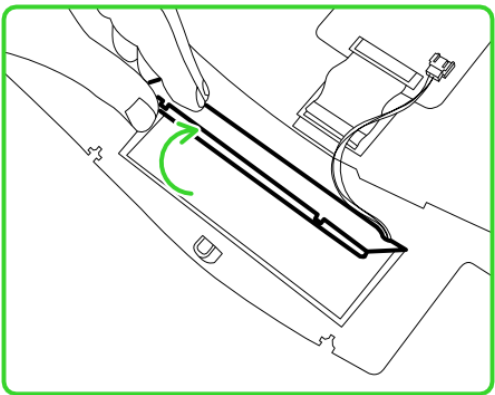

4. Gently disconnect the battery connector from the keyboard.

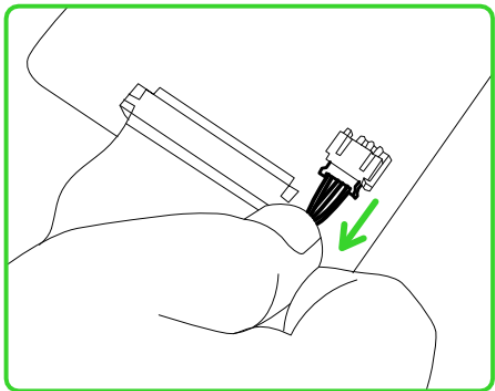

5. Please ensure to replace the battery with the correct model number by referring to the user manual or checking the label for the specifications.



Model: FT5936E2P
Rated Capacity: 4200 mAh
Rated Voltage: 3.7V
Limited Charge Voltage: 4.2V

9. LEGALESE

COPYRIGHT AND INTELLECTUAL PROPERTY INFORMATION

©2026 Razer Inc. All rights reserved. Razer, the triple-headed snake logo, Razer logo, "For Gamers. By Gamers.", and "Razer Chroma" logo are trademarks or registered trademarks of Razer Inc. and/or affiliated companies in the United States or other countries. All other trademarks are the property of their respective owners.

Windows and the Windows logo are trademarks of the Microsoft group of companies.

The Bluetooth® word mark and logos are registered trademarks owned by Bluetooth SIG, Inc., and any use of such marks by Razer is under license.

Razer Inc. ("Razer") may have copyright, trademarks, trade secrets, patents, patent applications, or other intellectual property rights (whether registered or unregistered) concerning the product in this guide. Furnishing of this guide does not give you a license to any such copyright, trademark, patent or other intellectual property right. The Razer Pro Type Ergo (the "Product") may differ from pictures whether on packaging or otherwise. Razer assumes no responsibility for such differences or for any errors that may appear. Information contained herein is subject to change without notice.

LIMITED PRODUCT WARRANTY

For the latest and current terms of the Limited Product Warranty, please visit razer.com/warranty.

LIMITATION OF LIABILITY

Razer shall in no event be liable for any lost profits, loss of information or data, special, incidental, indirect, punitive or consequential or incidental damages, arising in any way out of distribution of, sale of, resale of, use of, or inability to use the Product. In no event shall Razer's liability exceed the retail purchase price of the Product.

GENERAL

These terms shall be governed by and construed under the laws of the jurisdiction in which the Product was purchased. If any term herein is held to be invalid or unenforceable, then such term (in so far as it is invalid or unenforceable) shall be given no effect and deemed to be excluded without invalidating any of the remaining terms. Razer reserves the right to amend any term at any time without notice.