



# RAZER TURRET FOR XBOX ONE

MASTER GUIDE

One. Get incredible precision on a tenkeyless keyboard with an inbuilt mouse mat, paired with a mouse featuring the acclaimed Razer 5G Advanced Optical Sensor. It's the one-device solution for advanced gaming—on the couch.

# CONTENTS

1. WHAT'S INSIDE / SYSTEM REQUIREMENTS .....	3
2. LET'S GET YOU COVERED .....	4
3. TECHNICAL SPECIFICATIONS.....	5
4. EXPLORING YOUR RAZER TURRET FOR XBOX ONE.....	7
5. SETTING UP YOUR RAZER TURRET FOR XBOX ONE .....	9
6. USING YOUR RAZER TURRET FOR XBOX ONE .....	3
7. INSTALLING RAZER SYNAPSE / RAZER TURRET APP .....	6
8. CONFIGURING YOUR RAZER TURRET VIA RAZER SYNAPSE.....	7
9. SAFETY AND MAINTENANCE .....	31
10. LEGALESE.....	33

---

## 1. WHAT'S INSIDE / SYSTEM REQUIREMENTS

### WHAT'S INSIDE

- Razer Turret for Xbox One wireless keyboard
- Razer Turret for Xbox One wireless mouse
- USB wireless dongle
- Keyboard-to-mouse charging cable
- USB-A to USB-C cable
- USB-A to Micro-USB cable
- Power adapter (models may vary)
- Important Product Information Guide

### SYSTEM REQUIREMENTS

#### PRODUCT REQUIREMENTS

- Xbox One™ / Xbox One™ S / Xbox One™ X  
OR
- PC (Windows® 7 64-bit or higher) with free USB port(s)

#### RAZER TURRET APP / RAZER SYNAPSE REQUIREMENTS

- Internet connection
- 500 MB of free hard disk space

---

## 2. LET'S GET YOU COVERED

You've got a great device in your hands, complete with a 2-year limited warranty coverage. Now maximize its potential and score exclusive Razer benefits by registering at [razerid.razer.com](https://razerid.razer.com)

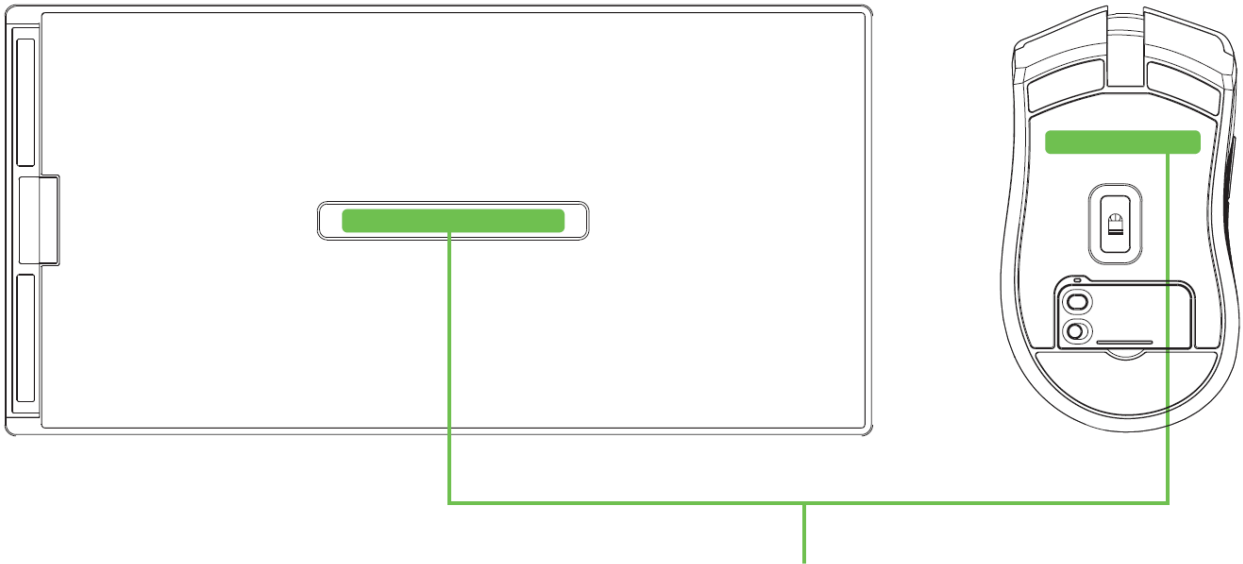

*Your product's serial number can be found here.*

Got a question? Ask the Razer Support Team at [support.razer.com](https://support.razer.com)

### SAFETY STATEMENT

**IMPORTANT!** Before using the Xbox One with this product, read the Xbox One instruction manual for safety, health, and other information regarding the use of the Xbox One.

---

## 3. TECHNICAL SPECIFICATIONS

### FEATURES

#### Razer Turret Mouse (Xbox One Edition)

- Razer 5G Advanced Optical Sensor with true 16,000 DPI
- Up to 450 inches per second (IPS) / 50 G acceleration
- 1000 Hz Ultrapolling
- 7 independently programmable Hyperresponse buttons
- Razer™ Mechanical Mouse Switches with 50-million click life cycle
- Gaming-grade tactile scroll wheel
- Ergonomic right-handed design
- Xbox Dynamic Lighting
- Powered by Razer Chroma™ with 16.8 million customizable color options
- Hybrid On-Board Memory and Cloud Storage
- Razer Synapse 3 enabled

#### Razer Turret Keyboard (Xbox One Edition)

- Razer™ Mechanical Switches with 50 g actuation force
- 80 million keystrokes
- Xbox Dynamic Lighting
- Powered by Razer Chroma™ with 16.8 million customizable color options
- Compact layout
- Ergonomic wrist rest
- Mid height keycaps
- Razer Synapse enabled
- 10 key roll-over anti-ghosting
- Fully programmable keys with on-the-fly macro recording (PC only)
- Gaming mode option (PC only)
- 1000 Hz Ultrapolling
- Instant Trigger Technology

## APPROXIMATE SIZE & WEIGHT

### Razer Turret Mouse (Xbox One Edition)

- Length: 125.70 mm / 4.95 in
- Width: 70 mm / 2.75 in
- Height: 43.20 mm / 1.70 in
- Weight (excluding cable): 106 g / 0.21 lbs

### Razer Turret Keyboard (Xbox One Edition)

#### *Without expanding the tray*

- Length: 194 mm / 7.64 in
- Width: 390 mm / 15.35 in
- Height: 36.93 mm / 1.45 in
- Weight: 1860 g / 4.10 lbs

#### *With the tray expanded*

- Length: 194 mm / 7.64 in
- Width: 600 mm / 23.62 in
- Height: 36.93 mm / 1.45 in

## 4. EXPLORING YOUR RAZER TURRET FOR XBOX ONE

### KEYBOARD

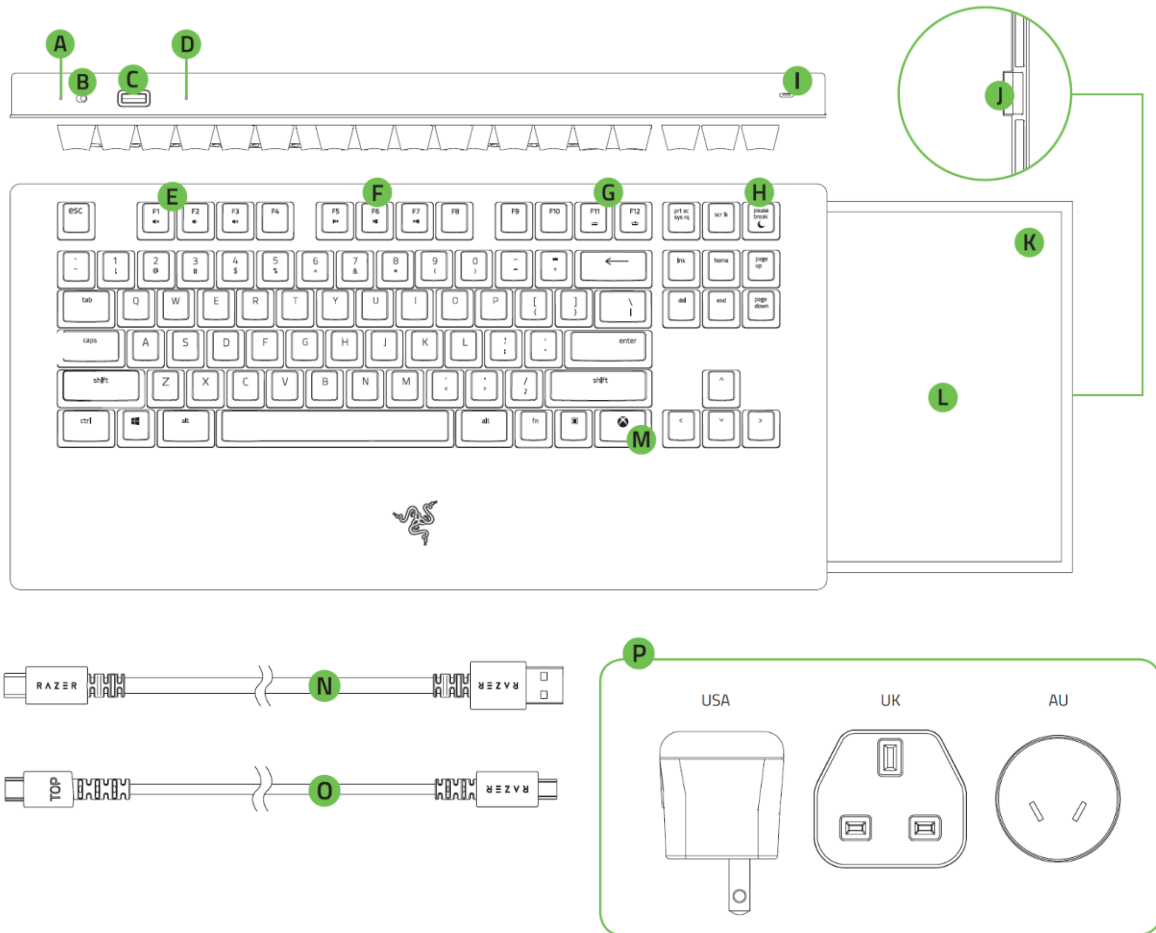

- A. Power indicator
- B. Power switch
- C. USB-C port
- D. Reset button
- E. Volume control keys
- F. Media keys
- G. Backlight control keys
- H. Sleep mode key
- I. Mouse charging port
- J. Latch for stowable mouse mat
- K. Magnetized mouse docking area
- L. Stowable mouse mat
- M. Xbox key
- N. USB-A to USB-C cable
- O. Keyboard-to-mouse charging cable
- P. Power adapter\*

\*Power adapter models may vary.



# MOUSE

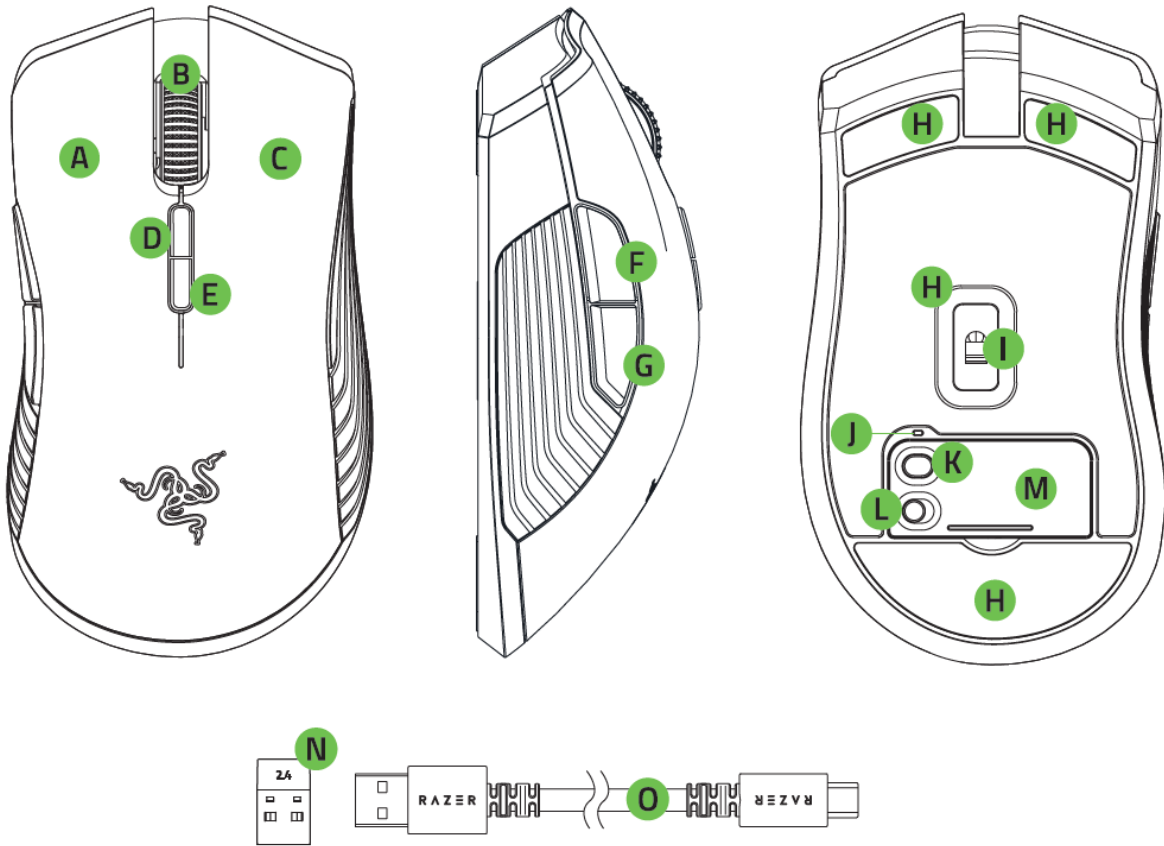

- A. Left mouse button
- B. Scroll wheel
- C. Right mouse button
- D. DPI stage up
- E. DPI stage down
- F. Mouse button 5
- G. Mouse button 4
- H. Ultraslick mouse feet
- I. True 16,000 DPI 5G optical sensor
- J. Profile indicator
- K. Profile button
- L. Power switch
- M. USB wireless dongle cover
- N. USB wireless dongle
- O. USB-A to Micro-USB cable

**i** Default DPI stages are as follows: 800, 1800, 4500, 9000, and 16000. The DPI stages can be customized using Razer Synapse 3 and the Razer Turret app. The Xbox One home screen can only be navigated with a controller or the keyboard; all mouse cursor functions are only available in-game.

---

## 5. SETTING UP YOUR RAZER TURRET FOR XBOX ONE

### PREPARING YOUR DEVICES FOR FIRST USE

1. Hold down the latch on the right side of the keyboard to unlock and pull out the mouse mat.

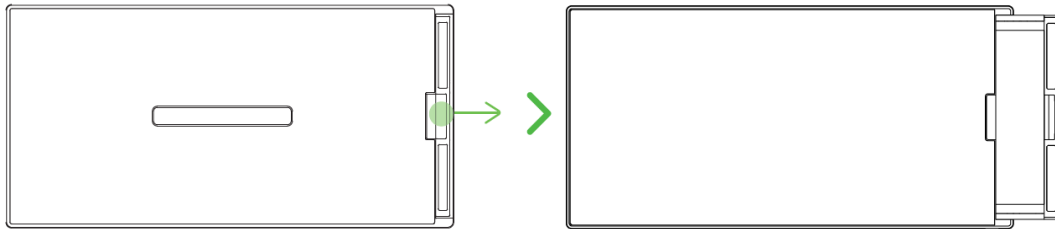

2. Connect the mouse to the keyboard's mouse port using the included Keyboard-to-mouse charging cable.

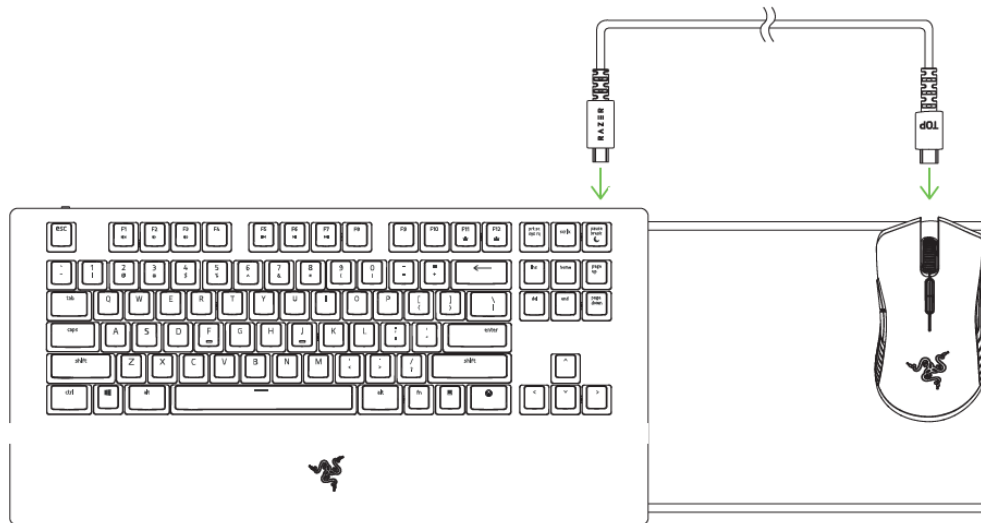

3. Select the appropriate power plug for your region and attach it to the power adapter.

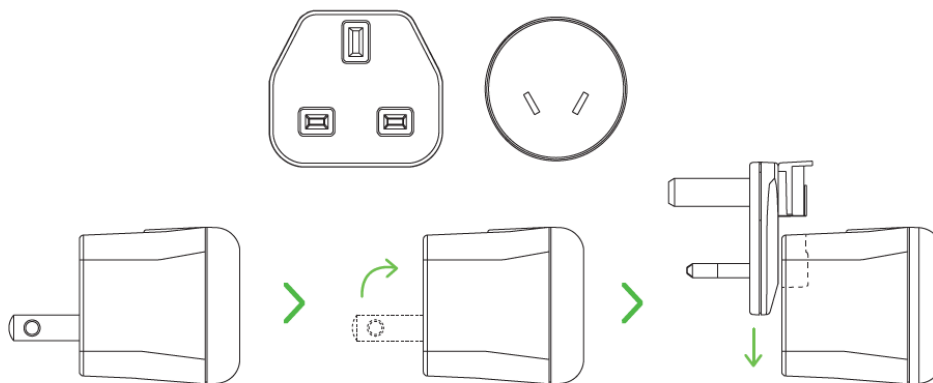

4. Connect the power adapter to the keyboard using the included USB-A to USB-C cable and plug it into a power outlet. The keyboard's power indicator will light up red to indicate that the keyboard is charging. The mouse will also begin to charge.

**i** Use only the power adapter and USB-A to USB-C cable included with the product.

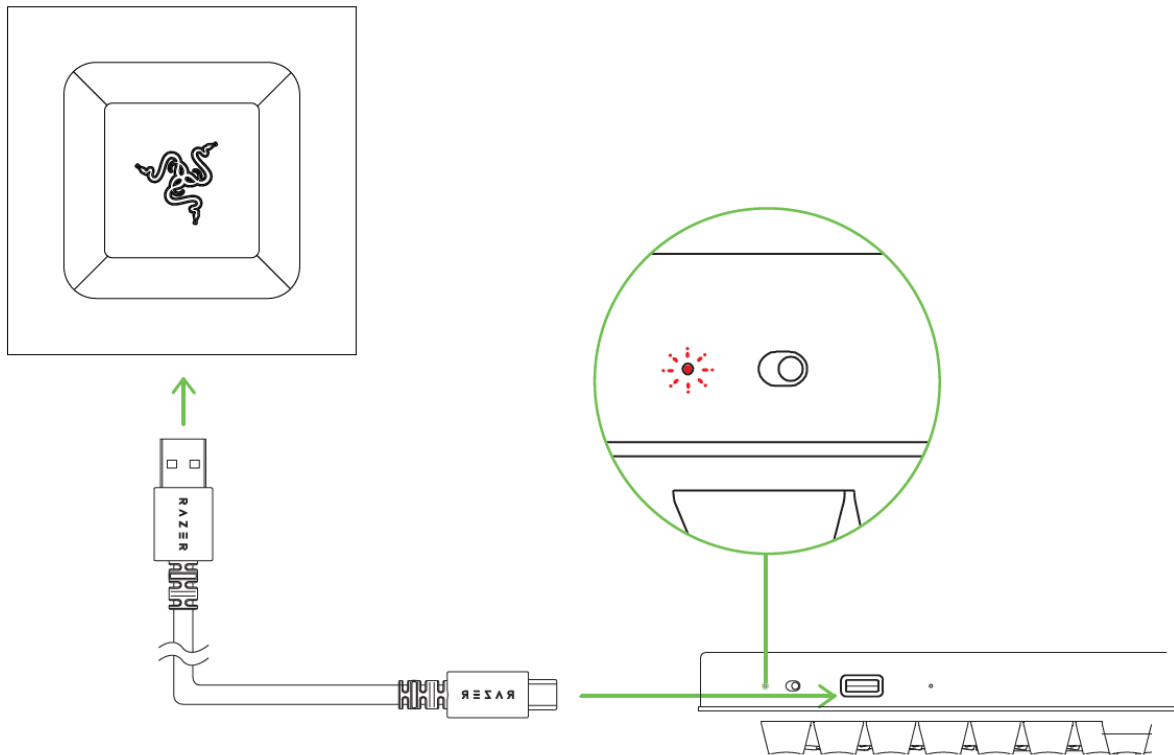

5. Wait for your keyboard to fully charge. The power indicator will light up green to indicate that it has fully charged.

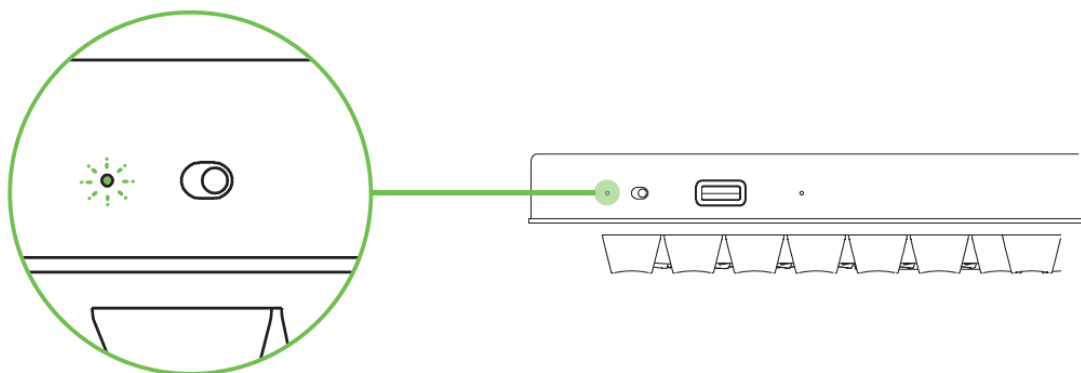

**i** For best results, please fully charge your Razer Turret for Xbox One before using it for the first time.

# CONNECTING THE RAZER TURRET FOR XBOX ONE TO YOUR XBOX ONE / PC

## Wireless Mode

1. On the mouse, remove the USB wireless dongle cover and pull out the USB wireless dongle.

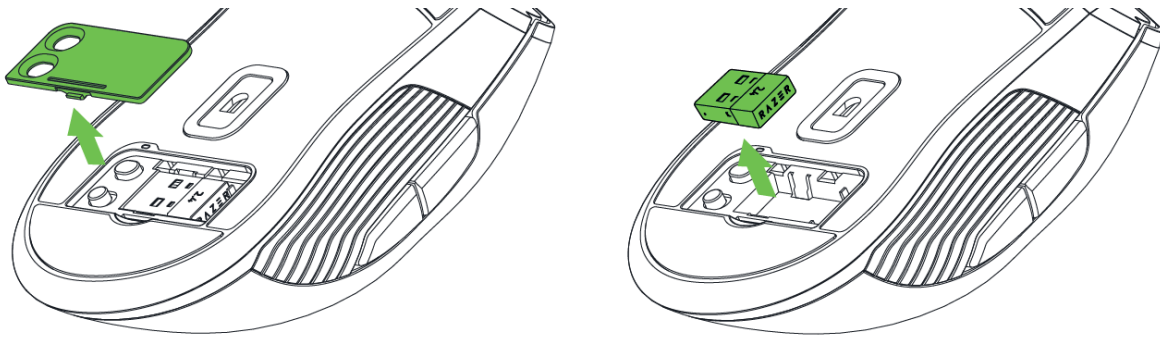

2. Connect the USB wireless dongle to the USB port of your Xbox One or PC.



3. Switch on the keyboard and mouse.



Keyboard



Mouse

4. The Razer Turret for Xbox One is now ready for use in wireless mode.



## Wired Mode

### Keyboard

Connect the keyboard's USB port to your Xbox One or PC using the included USB-A to USB-C cable, and then turn on the device.

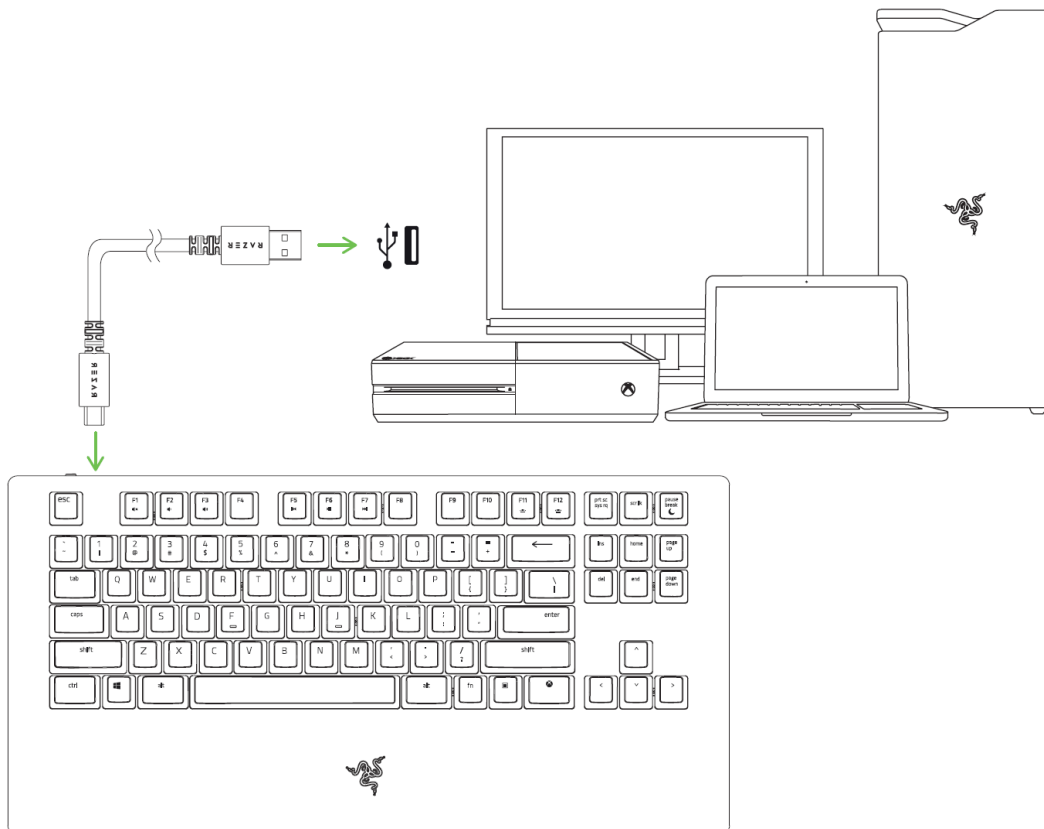

## Mouse

Connect the mouse's Micro-USB port to your Xbox One or PC using the included USB-A to Micro-USB cable, and then turn on the device.

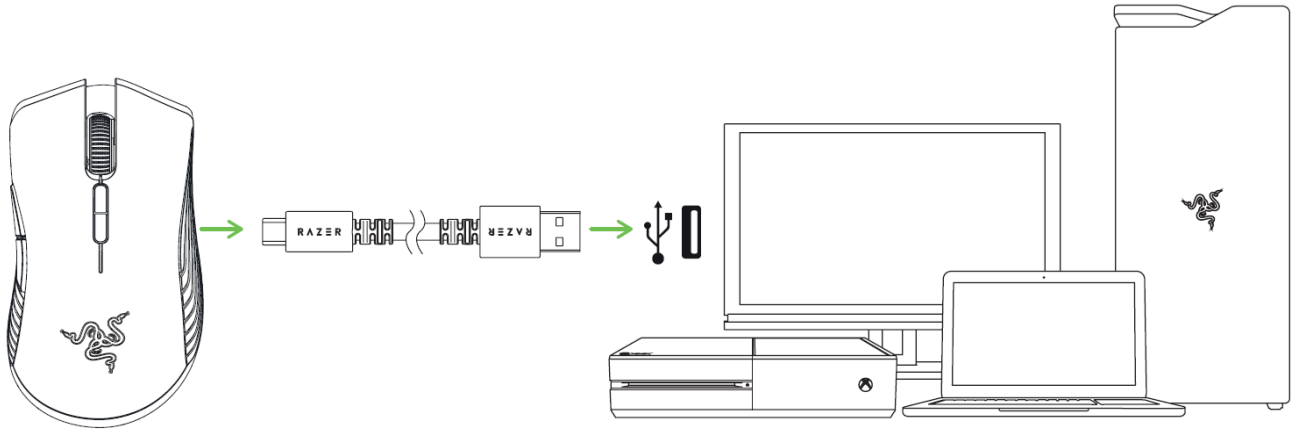

- i *Connecting the keyboard and/or mouse via wired connection will also individually charge your devices. A USB connection that can supply sufficient power to your device is required. The charging process may be affected if connected to non-powered USB hubs or non-powered USB ports found on certain keyboards and other peripherals. When in doubt, it is recommended to connect these devices directly to the USB ports of either your Xbox One or PC.*

## 6. USING YOUR RAZER TURRET FOR XBOX ONE

### UNDERSTANDING THE POWER INDICATORS

#### Power Indicator (keyboard)

The power indicator on the keyboard displays the keyboard's battery status.

Status	Full	Low	Critical*	Charging
Indicator				

**i** *Critical status indicates that the keyboard's battery is less than 3%. This lighting sequence will repeat until the battery is drained or the keyboard is charged. During this state, the lighting on the keyboard will also be disabled.*

#### Low Power Indicator (mouse)

The mouse's scroll wheel will blink red twice in repeated intervals to indicate that the battery's power is less than 5%. This lighting sequence will repeat until the battery is drained or the mouse is connected to the PC via the USB-A to Micro-USB cable.

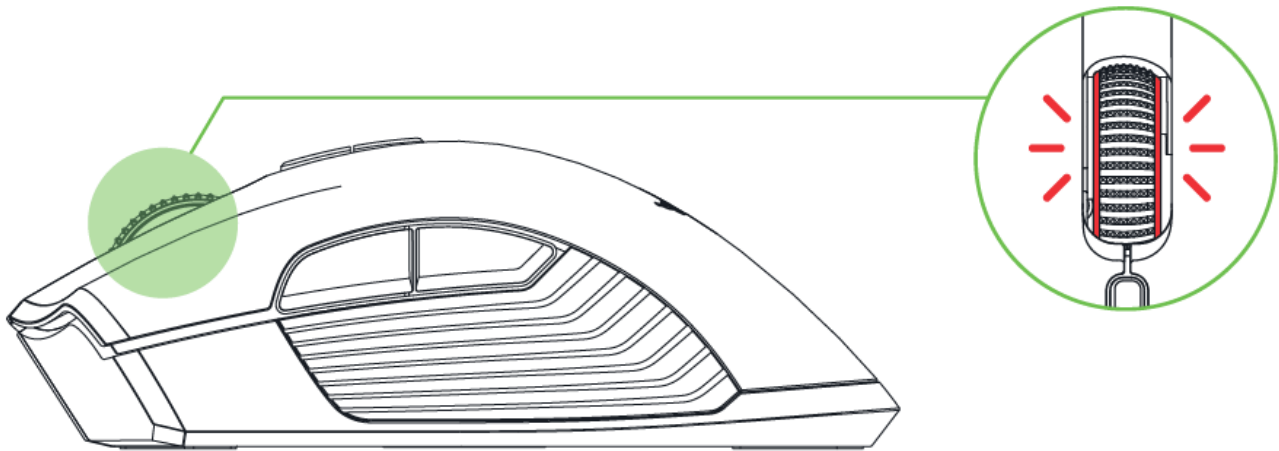

**i** *You may view the individual battery percentage of each device and/or customize the indicator percentage of the mouse using Razer Synapse or the Razer Turret app.*

## FUNCTION KEYS (KEYBOARD)



When the "fn" key is held down, all function keys with secondary functions including other keys which you can combine with the "fn" key will light up. Pressing the "fn" key in combination with these keys will activate their secondary commands on your PC.

Function keys	Secondary commands
	<p>The audio volume controls allow you to mute (  ), decrease (  ) and increase (  ) the audio output.</p>
	<p>The media keys allow you to play/pause (  ) a track or skip tracks backward (  ) and forward (  ).</p>
	<p>The backlight control keys allow you to decrease (  ) or increase (  ) the brightness of your keyboard's LEDs.</p>
	<p>The sleep key allows you to suspend all operating system activities. This function allows you to save electricity while the computer is idle.</p>





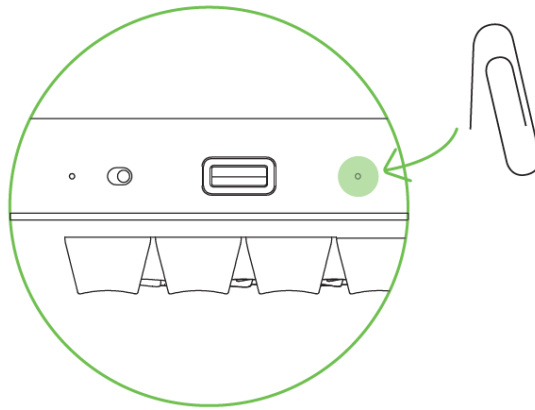

## RESET BUTTON (KEYBOARD)

If your keyboard freezes or suddenly stops responding, simply press the Reset button on the keyboard using a paper clip or any similar object to restart your device.



## STORED PROFILES (MOUSE)

The Razer Turret for Xbox One mouse can store up to 5 profiles from Razer Synapse, which you can use on systems that do not have Razer Synapse installed. You can store your current profile temporarily until it is replaced with a new active profile and pressing the Profile button will cycle from the current profile to profiles 1 to 4. The profile indicator will change its color to show which profile is presently selected. [Learn more about Storing profiles](#)

	Designated color
Active profile	White 
Profile 1	Red 
Profile 2	Green 
Profile 3	Blue 
Profile 4	Cyan 

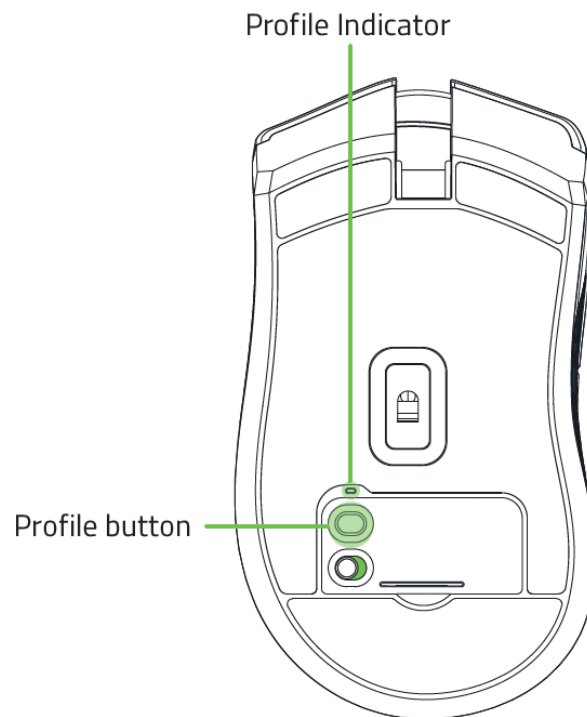

---

## 7. INSTALLING RAZER SYNAPSE / RAZER TURRET APP

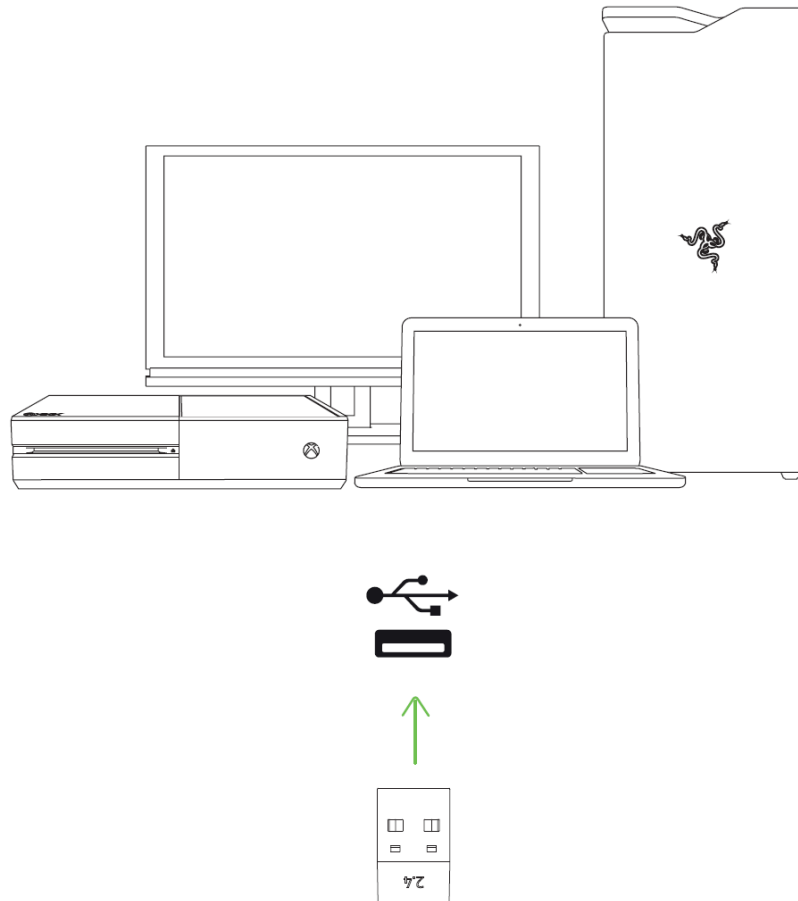

Step 1: Make sure the USB wireless dongle is connected to the USB port of your Xbox One or PC.

Step 2:

**For Xbox One.** Download and install the Razer Turret app from the Xbox Store of your gaming console.

**For PC.** Install Razer Synapse on your PC when prompted\* or download it from [razer.com/synapse](https://www.razer.com/synapse).

Step 3: Create your Razer ID or log into Razer Synapse with an existing account.

*\*Applicable for Windows 8 or later.*

---

## 8. CONFIGURING YOUR RAZER TURRET VIA RAZER SYNAPSE

**!** *Disclaimer: The features listed here require you to log into Razer Synapse. These features are also subject to change based on the current software version and your Operating System.*

### SYNAPSE TAB

The Synapse tab is your default tab when you first launch Razer Synapse.

#### Dashboard

The Dashboard subtab is an overview of your Razer Synapse where you can access all your Razer devices, modules, and online services.

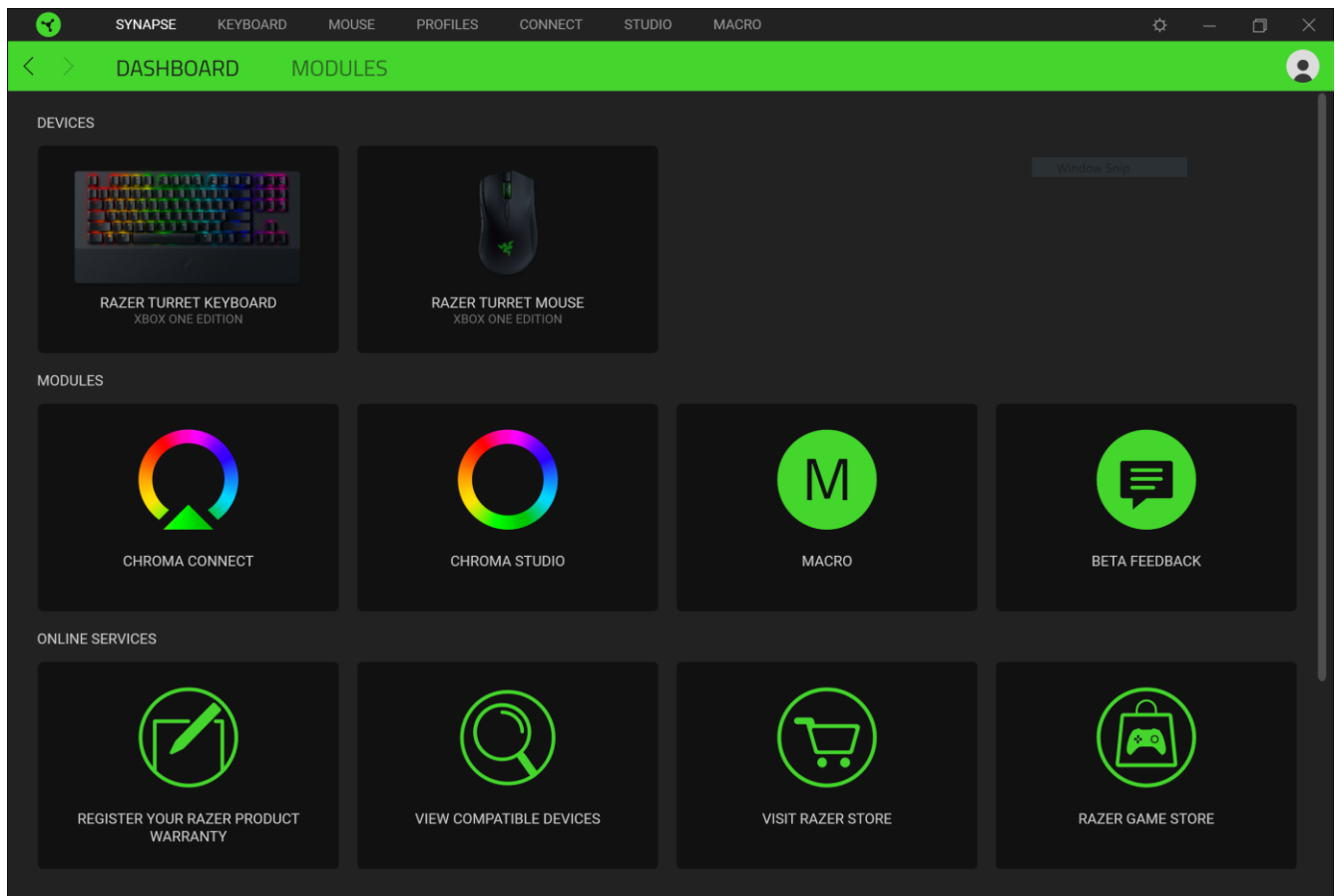

## Modules

The Modules subtab displays all installed and available modules for download and installation.

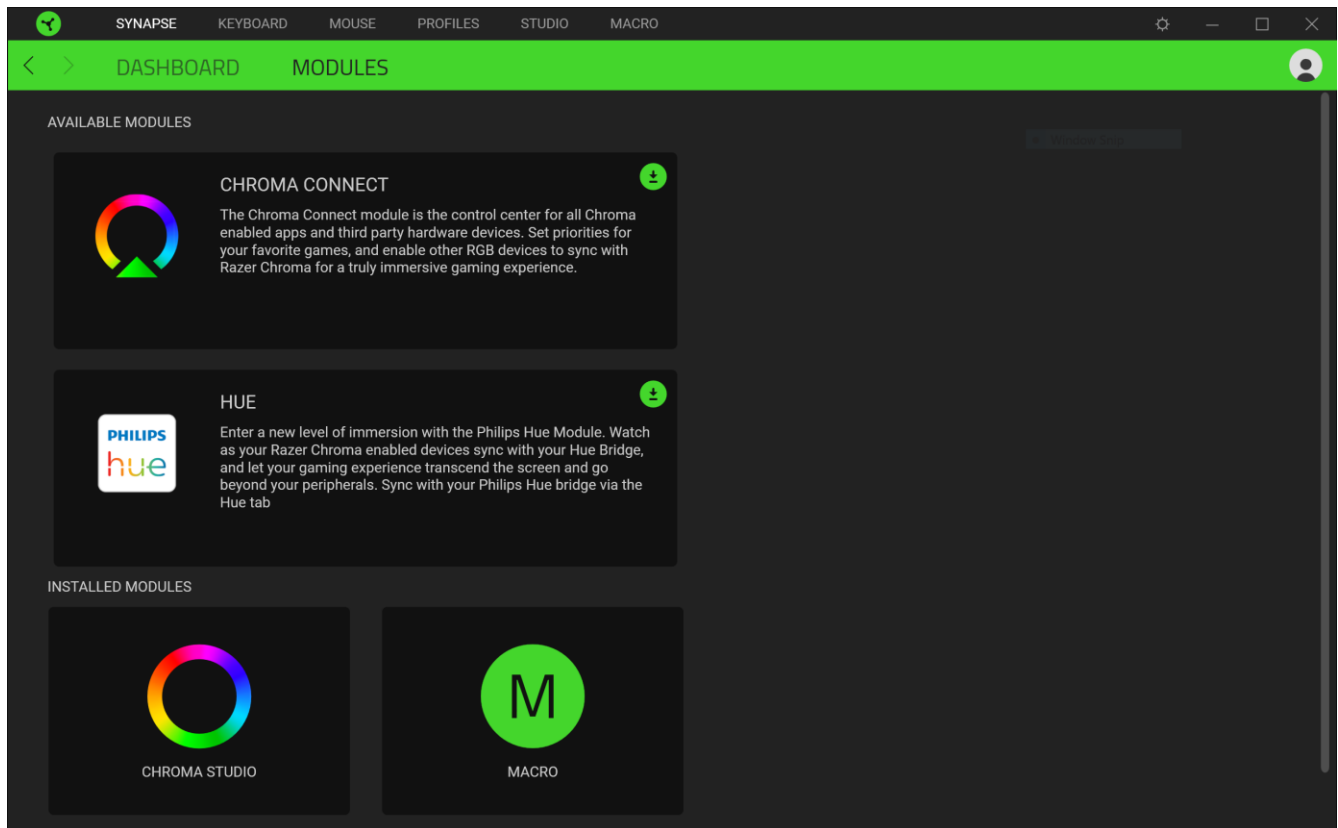

## KEYBOARD / MOUSE

The Keyboard and Mouse tabs are the main tabs for your Razer Turret for Xbox One devices. From here, you can change the corresponding settings of each device such as key or button assignments, DPI sensitivity, gaming mode settings, and each device's lighting.

**!** *Changes made under any of these tabs are automatically saved to your system and cloud storage. However, to use the on-board memory of the mouse, click the On-board Profiles button (📁) from the Mouse tab then drag and drop the profiles you want to store on your device.*

### Customize (Keyboard/Mouse)

The Customize subtab is for modifying the key or button assignments of your keyboard and mouse.

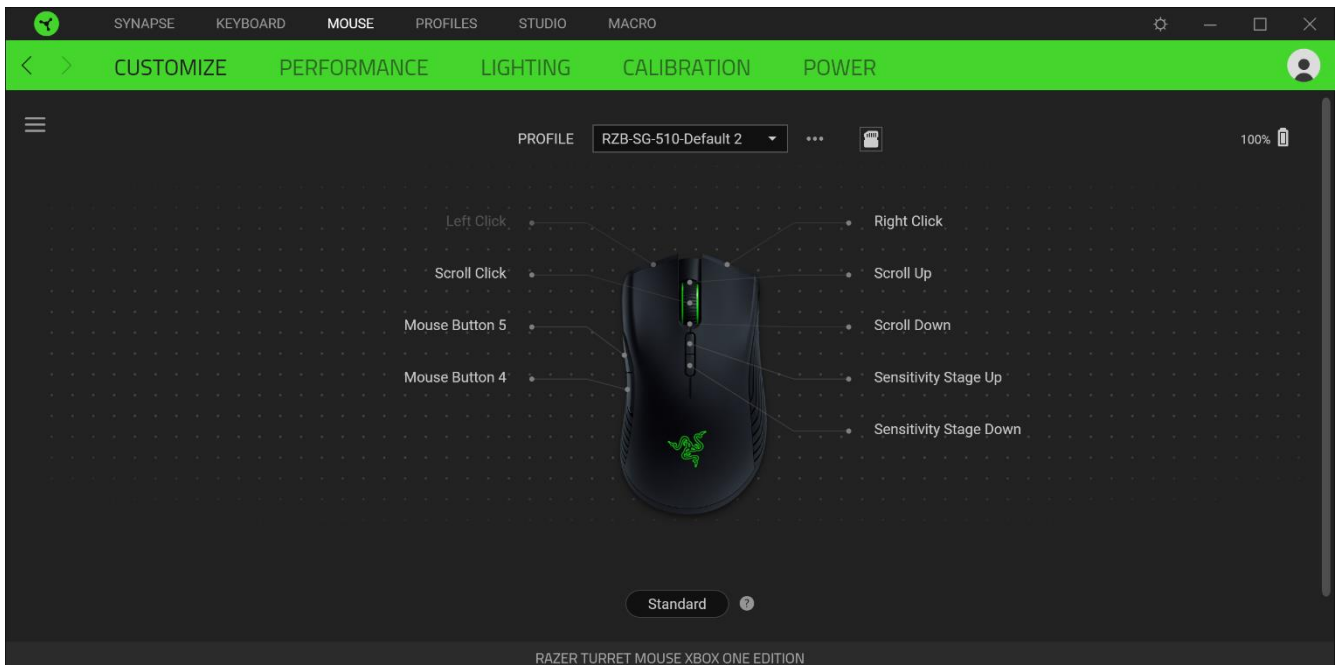
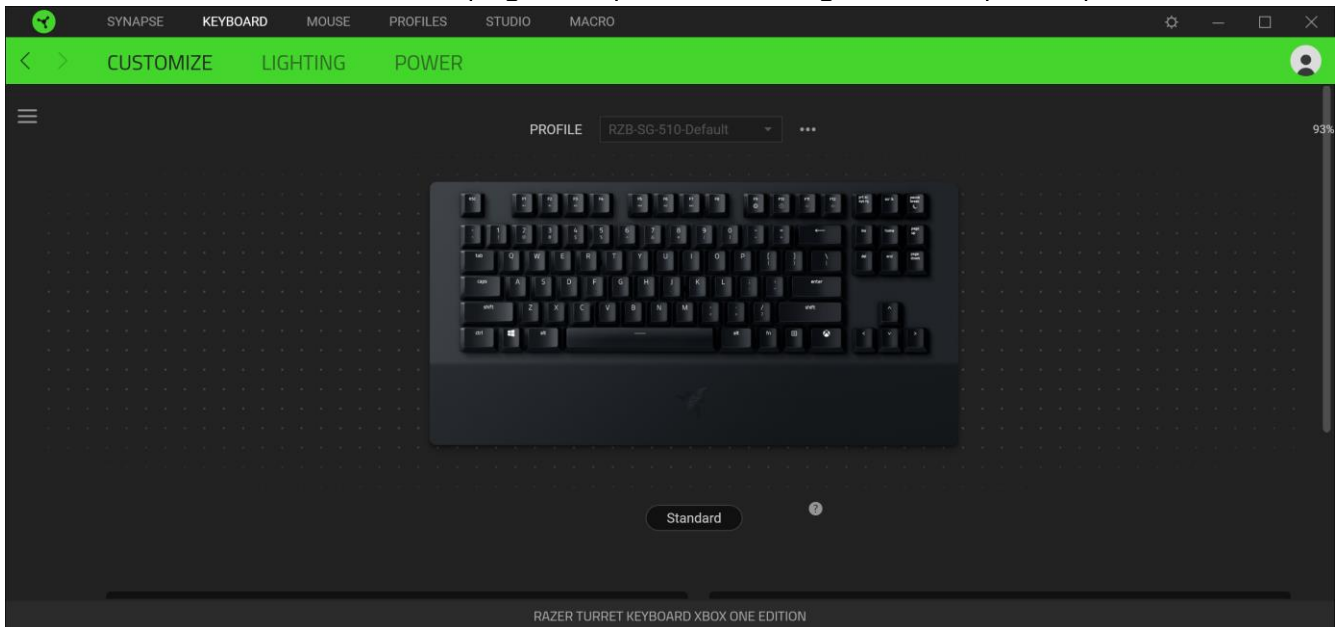

## Profile

Profile is a data storage for keeping all your Razer peripheral's settings. By default, the profile name is based on your system's name. To add, import, rename, duplicate, export, or delete a profile, simply press the profile's corresponding Miscellaneous button (•••).

## Hypershift

Hypershift mode is a secondary set of key or button assignments activated when the Hypershift key is held down. By default, the Hypershift key is assigned to the fn key of your Razer Synapse supported keyboard however, you can also assign any key or button as a Hypershift key.

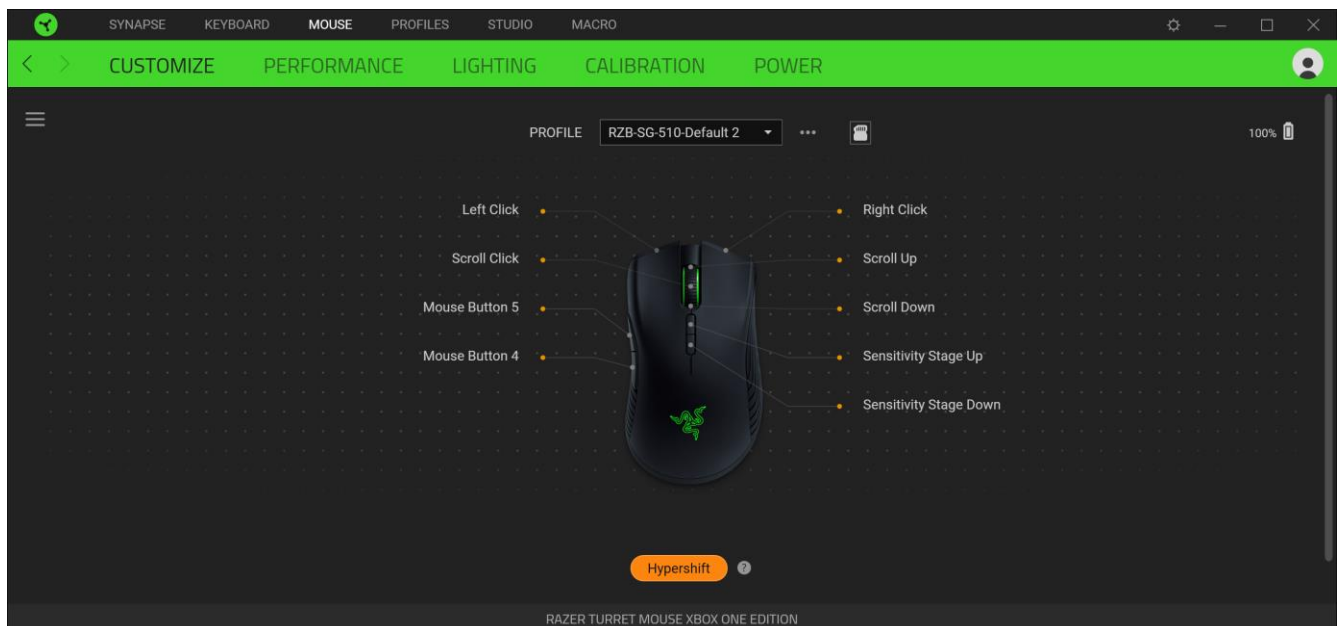
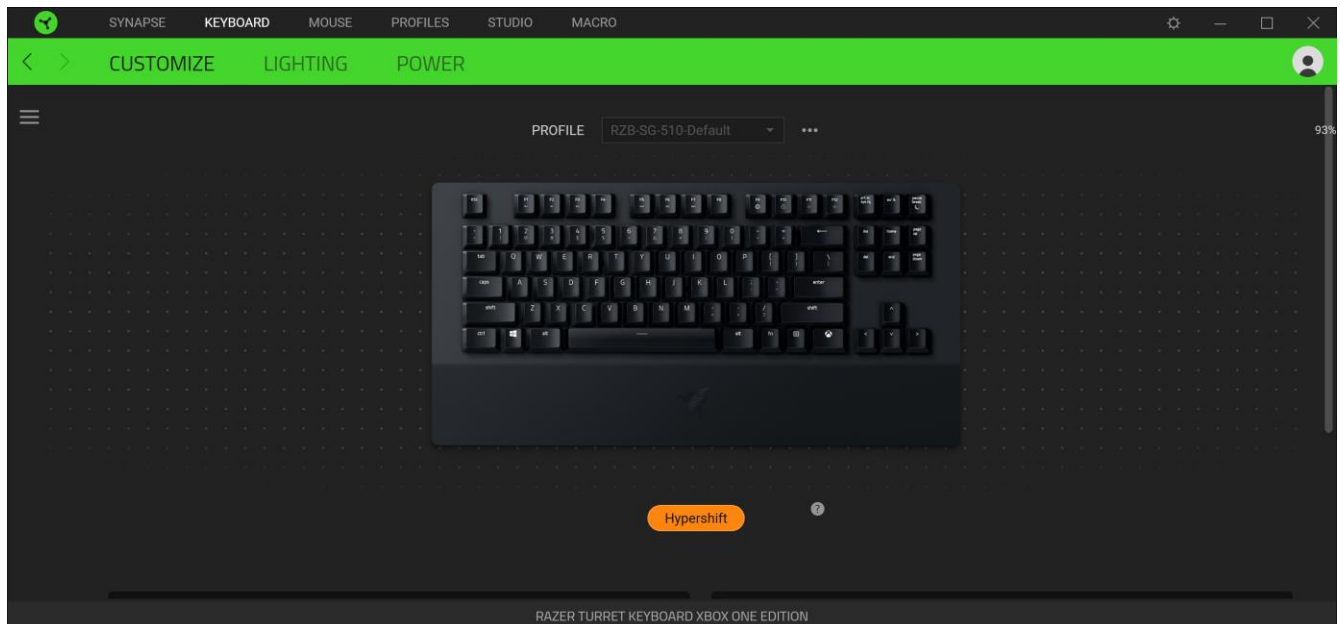

## Sidebar

Clicking the Sidebar button (☰) on the Customize subtab of the Keyboard or Mouse tabs will reveal all of your devices' current key or button assignments.

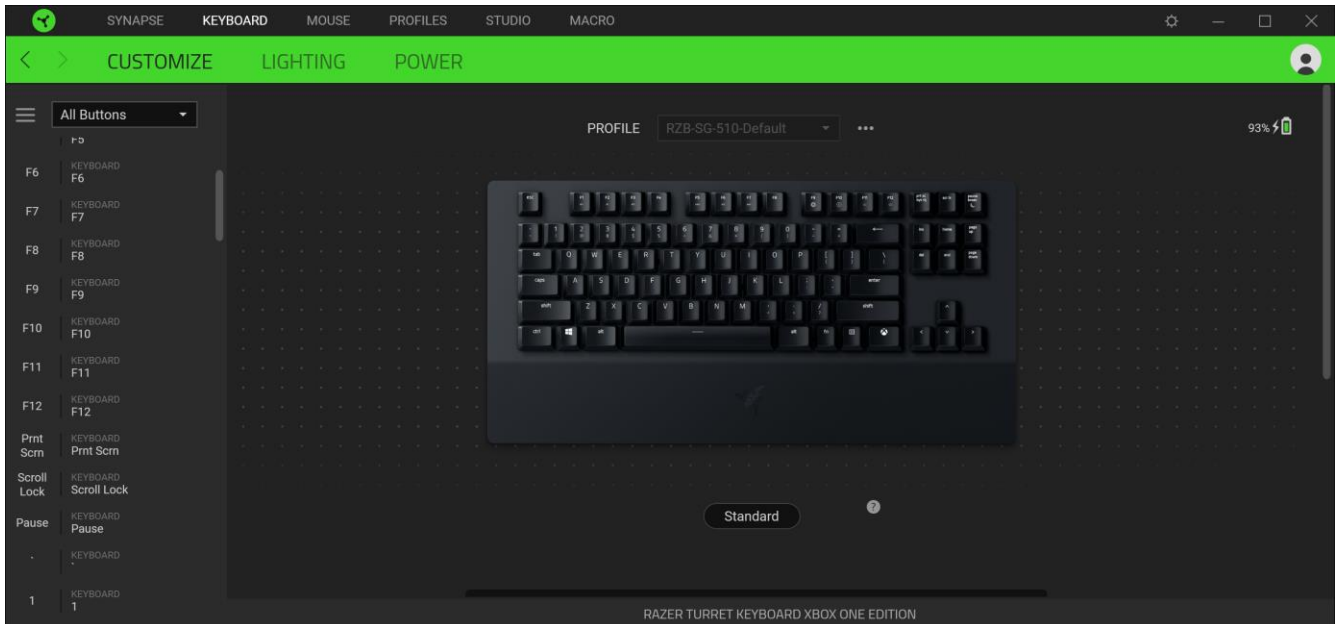

Alternatively, you can skip to a specific assignment by selecting it on the Customize tab.

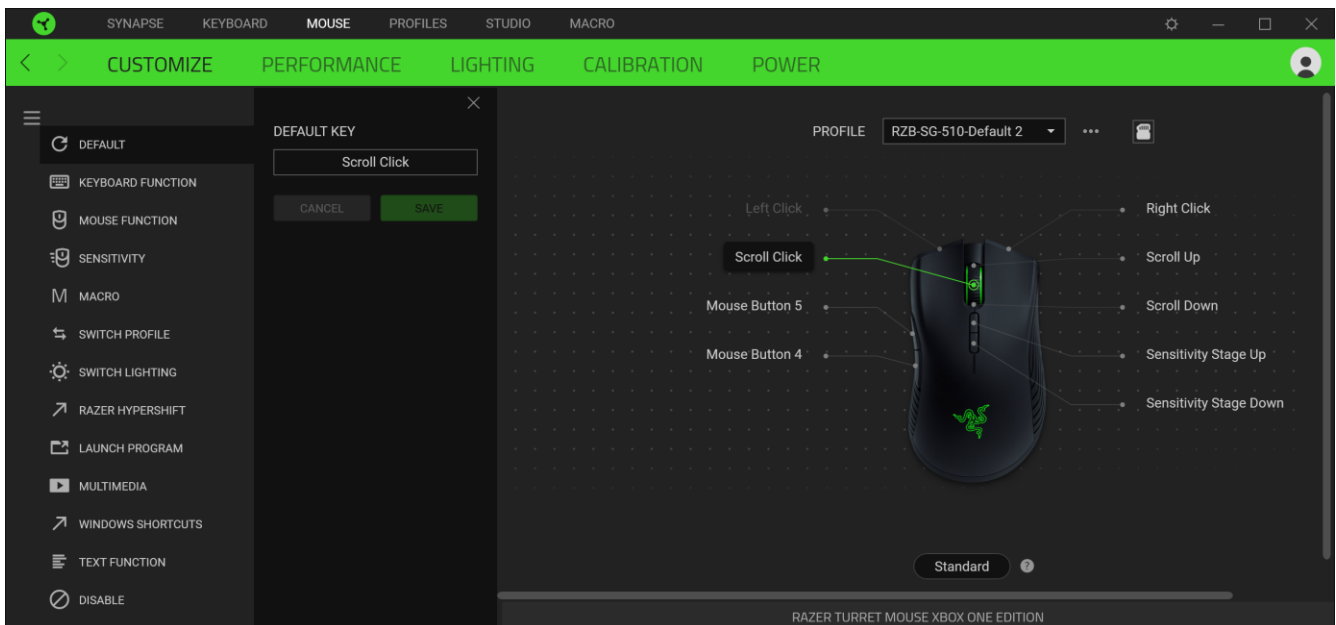

Upon selecting a key or button assignment, you may then change it to any of the following functions:

### Default

Returns the selected key or button to its original setting.

### Keyboard Function

Changes the key or button assignment into a keyboard function. You can also choose enable Turbo mode which allows you to repeatedly emulate a keyboard function while the key or button is held down.

### Mouse Function

Changes any key or button into a mouse function. Listed below are the functions which you can choose from:

- Left Click - Performs a left mouse click using the assigned button.
- Right Click - Performs a right mouse click using the assigned button.
- Scroll Click - Activates the universal scrolling function.
- Double Click - Performs a double left click using the assigned button.
- Mouse Button 4 - Performs a "Backward" command for most internet browsers.
- Mouse Button 5 - Performs a "Forward" command for most internet browsers.
- Scroll Up - Performs a "Scroll Up" command using the assigned button.
- Scroll Down - Performs a "Scroll Down" command using the assigned button.
- Scroll Left - Performs a "Scroll Left" command using the assigned button.
- Scroll Right - Performs a "Scroll Right" command using the assigned button.

You can also choose to enable Turbo mode in some of the mouse functions which allow you to emulate repeatedly pressing and releasing said function while the key is held down.

### Sensitivity (for mouse only)

Allows you to manipulate the DPI setting of your mouse with a touch of a button. Listed below are the Sensitivity options and their description:

- Sensitivity Clutch - Changes the sensitivity to a predefined DPI while the designated button is held down. Releasing the button will return it to the previous sensitivity.



- Sensitivity Stage Up - Increases the current sensitivity by one stage.
- Sensitivity Stage Down - Decreases the current sensitivity by one stage.
- On-The-Fly Sensitivity - Pressing the designated button and moving the scroll wheel either up or down will increase or decrease the current DPI respectively.
- Cycle Up Sensitivity Stages - Increases the current sensitivity stage by one. Once it reaches the highest sensitivity stage, it will return to stage 1 when the button is pressed again.
- Cycle Down Sensitivity Stages - Decreases the current sensitivity stage by one. Once it reaches stage 1, it will return to the highest sensitivity stage when the button is pressed again. [Click here to learn more about Sensitivity Stages](#)

## M Macro

A Macro is a prerecorded sequence of keystrokes and button presses that is executed with precise timing. By setting the key or button function to Macro, you can conveniently execute a chain of commands. [Click here to learn more about Macros](#)

## ↔ Switch Profile

Switch Profile enables you to quickly change profiles and load a new set of key or button assignments. An on-screen notification will appear whenever you switch profiles.

## ⚙️ Switch Lighting

Switch Lighting allows you to easily switch between all advanced lighting effects. Do take note that this function will only be visible if you have installed the Chroma Studio module from the Modules subtab. [Click here to learn more about Advanced Chroma Effects](#)

## ↗️ Razer Hypershift

Setting the key to Razer Hypershift will allow you to activate Hypershift mode as long as a key or button is held down.

## 🔗 Launch Program

Launch Program enables you to open an app or a website using the assigned key or button. When you select Launch Program, two choices will appear which requires you to search for a specific app you want to open, or write the address of the website you want to visit.

## Multimedia

This option allows you to assign multimedia controls to your Razer device. Listed below are the multimedia controls you can choose from:

- Volume Down - Decreases the audio output.
- Volume Up - Increases the audio output.
- Mute Volume - Mutes the audio.
- Mic Volume Up - Increases the microphone volume.
- Mic Volume Down - Decreases the microphone volume.
- Mute Mic - Mutes the microphone.
- Mute All - Mutes both microphone and audio output.
- Play / Pause - Play, pause, or resume playback of the current media.
- Previous Track - Play the previous media track.
- Next Track - Play the next media track.

## Windows Shortcuts

This option allows you to assign your preferred key into a Windows Operating System shortcut command. For more information, please visit: [support.microsoft.com/kb/126449](https://support.microsoft.com/kb/126449)

## Text Function

Text Function enables you to type a prewritten text with a touch of a key. Simply write your desired text on the given field and your text will be typed whenever the assigned key is pressed. This function has full Unicode support and you can also insert special symbols from character maps.

## Disable

This option renders the assigned key unusable. Use Disable if you do not want to use the selected key or button; or if it interferes with your gaming.

## *Gaming Mode (for keyboard only)*

Gaming Mode enables you to customize which keys to disable when Gaming Mode is activated. Depending on your settings, you may choose to disable the Windows key, Alt + Tab and Alt + F4.

### *Keyboard Properties (for keyboard only)*

Allows you to open the Windows Keyboard Properties where you can modify other keyboard settings such as Repeat delay, Repeat Rate, and Cursor blink rate, or view all keyboard drivers installed in your PC.

## Performance (Mouse)

The Performance subtab allows you to modify the sensitivity, acceleration, and polling rate.

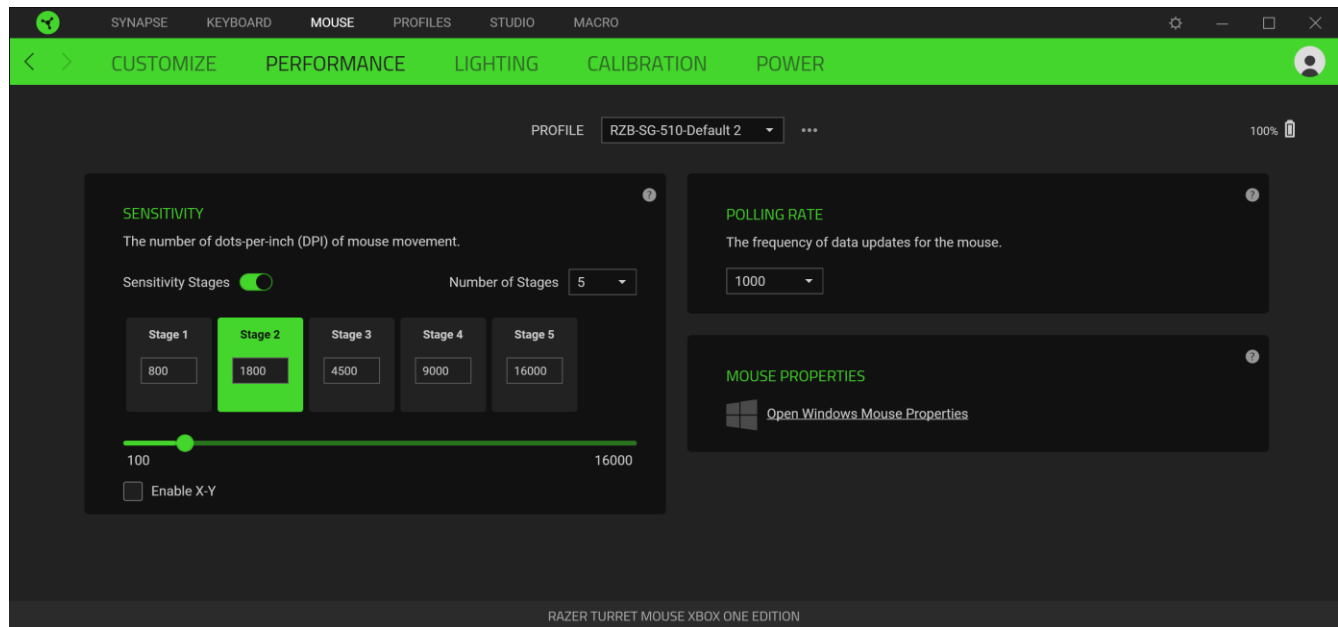

### Sensitivity

Sensitivity refers to the distance the cursor will travel based on how far the mouse moved. The higher the DPI, the farther the cursor will travel given the same distance of mouse movement.

### Enable X-Y Sensitivity

By default, the X-axis (horizontal) and Y-axis (vertical) use the same sensitivity values. However, you may set different sensitivity values to each of the axes by selecting the Enable X-Y Sensitivity option.

### Sensitivity Stages

A sensitivity stage is a preset sensitivity value. You can create up to 5 different sensitivity stages which you can cycle through using the sensitivity stage up/down buttons. You may use the Enable X-Y Sensitivity concurrently with this option.

### Polling Rate

The higher the polling rate, the more often the computer receives information about the status of your mouse, thus increasing the mouse pointer's reaction time. You can switch between 125Hz (8ms), 500Hz (2ms) and 1000Hz (1ms) by selecting your desired polling rate on the dropdown menu.

## Mouse Properties

From here, you can access the Windows Mouse Properties where you modify operating system settings that can directly affect your mouse.

## Lighting (Keyboard/Mouse)

The Lighting subtab enables you to modify each of your Razer device's light settings.

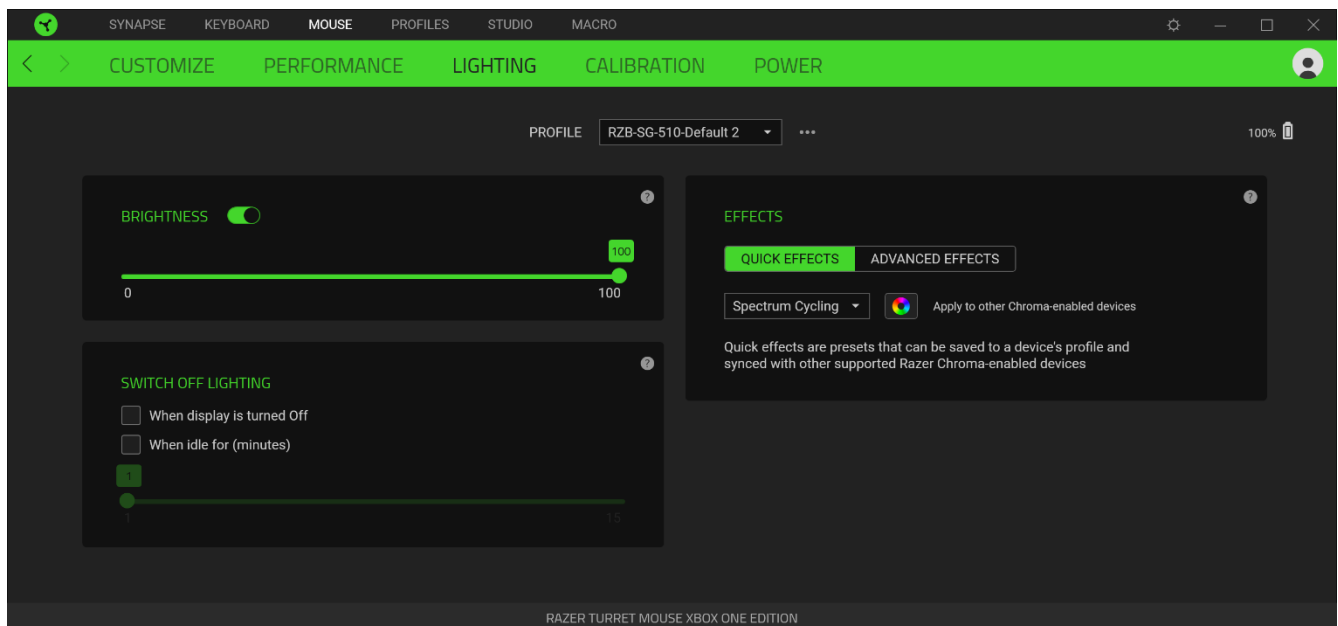
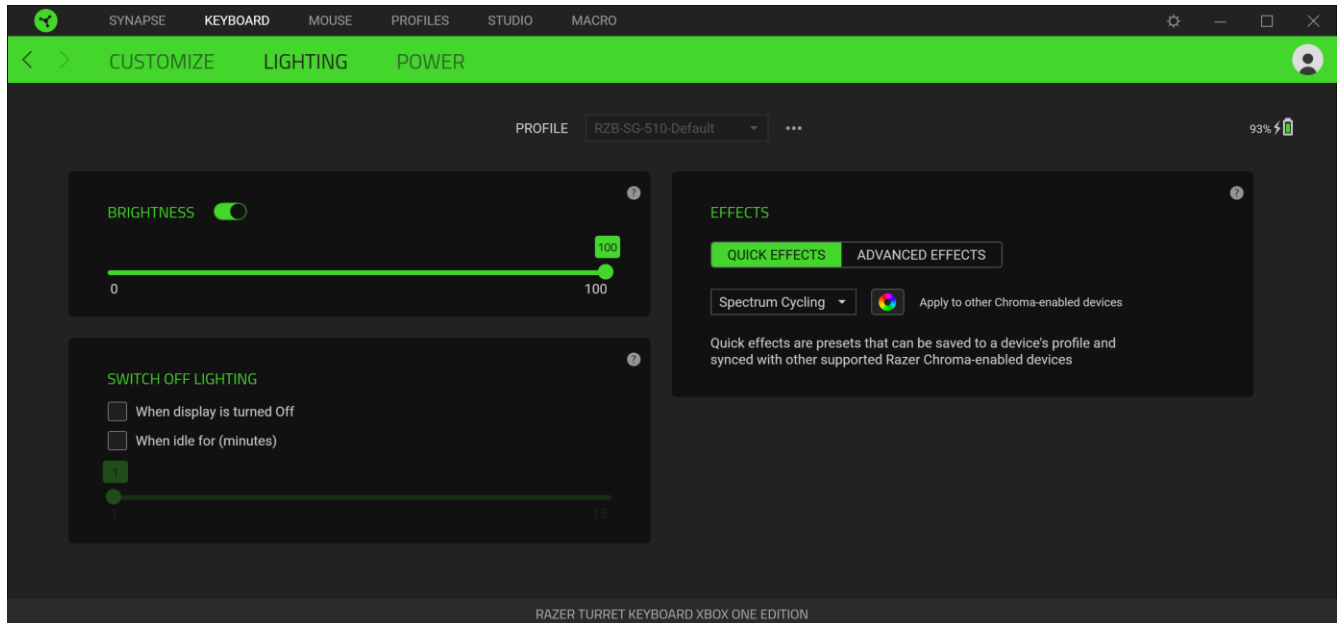

## Brightness

You can turn off your Razer device's lighting by toggling the Brightness option or increase/decrease the luminance using the slider.







## Switch Off Lighting

This is a power saving tool which allows you to disable a device's lighting in response to your system's display turning off and/or automatically power down when your keyboard and/or mouse has been idle for a set amount of time.

## Quick Effects

A number of quick effects can be selected and applied to any of your devices' lighting, as listed here:

**i** Only devices that support the selected lighting effect will synchronize. Power indicators are not customizable.

	Name	Description	How to set up
	Breathing	The lighting fades in and out of the selected color(s)	Select up to 2 colors or randomize
	Fire*	The keyboard lights up in warm colors to mimic the motion of flames	No further customization required
	Reactive	The LEDs will light up when you press or click any of the keys or mouse buttons	Select the color and the length of time for the LED to remain lit
	Ripple*	On key press, light will ripple away from the pressed key	Select a color
	Spectrum cycling	The lighting will cycle between 16.8 million colors indefinitely	No further customization required
	Starlight*	Each key will have a chance of fading in and out at a random time and duration	Select up to 2 colors or randomize colors and select a duration
	Static	The LEDs will remain lit in the selected color	Select a color



Wave\*

The lighting will scroll in the direction selected

Select either left-to-right or right-to-left wave direction

*\*These effects are only available for the keyboard.*

If you have other supported Razer Chroma-enabled devices, you can synchronize their quick effects with your Razer device by clicking the Chroma Sync button (  ).

### *Studio Effects*

The Studio Effects option allows you to choose a Chroma Effect you want to use on your Razer Chroma-enabled peripheral. To start making your own Chroma Effect, simply press the Chroma Studio button (  ). [Click here to learn more about the Chroma Studio](#)

## Calibration (Mouse)

The Calibration subtab allows you to optimize your Razer Precision Sensor to any surface for better tracking. To use this feature, you must click the **Add A Surface** option where you can select from a comprehensive list of Razer mouse mats or add your own mouse mat.

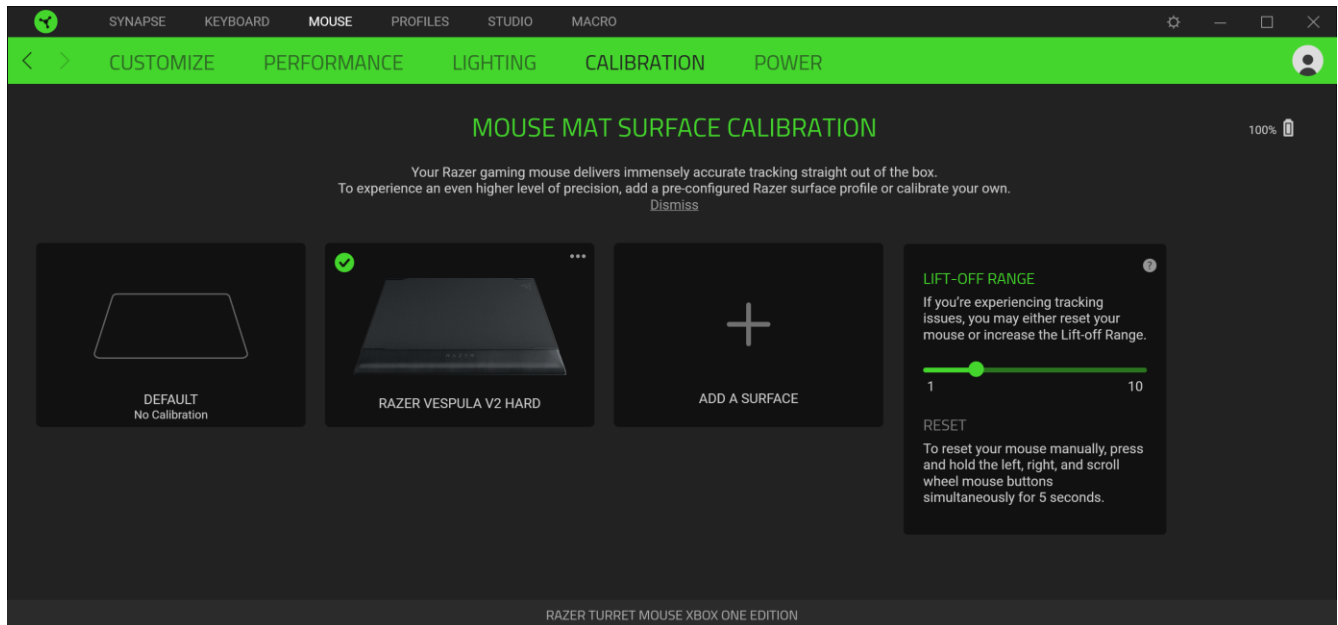

### Liftoff Range

The Liftoff Range enables you to set the distance at which the sensor stops tracking when it is lifted from its surface to avoid unwanted cursor movement.



## Power (Keyboard/Mouse)

The Power subtab allows you to manage the keyboard or mouse's energy consumption when running on batteries. You can set each device to dim its lighting or enter sleep mode when the corresponding device has been idle for a certain amount of time.

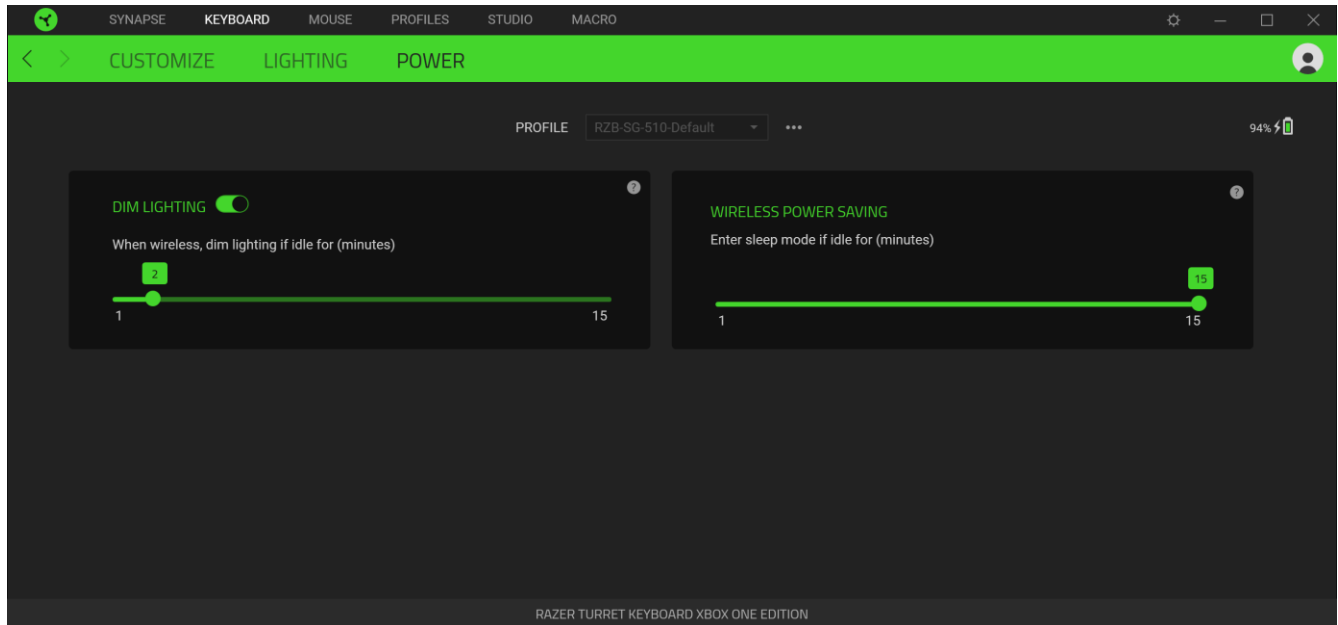

You may also adjust the required battery percentage of the mouse when entering Low Power Mode to conserve battery life.

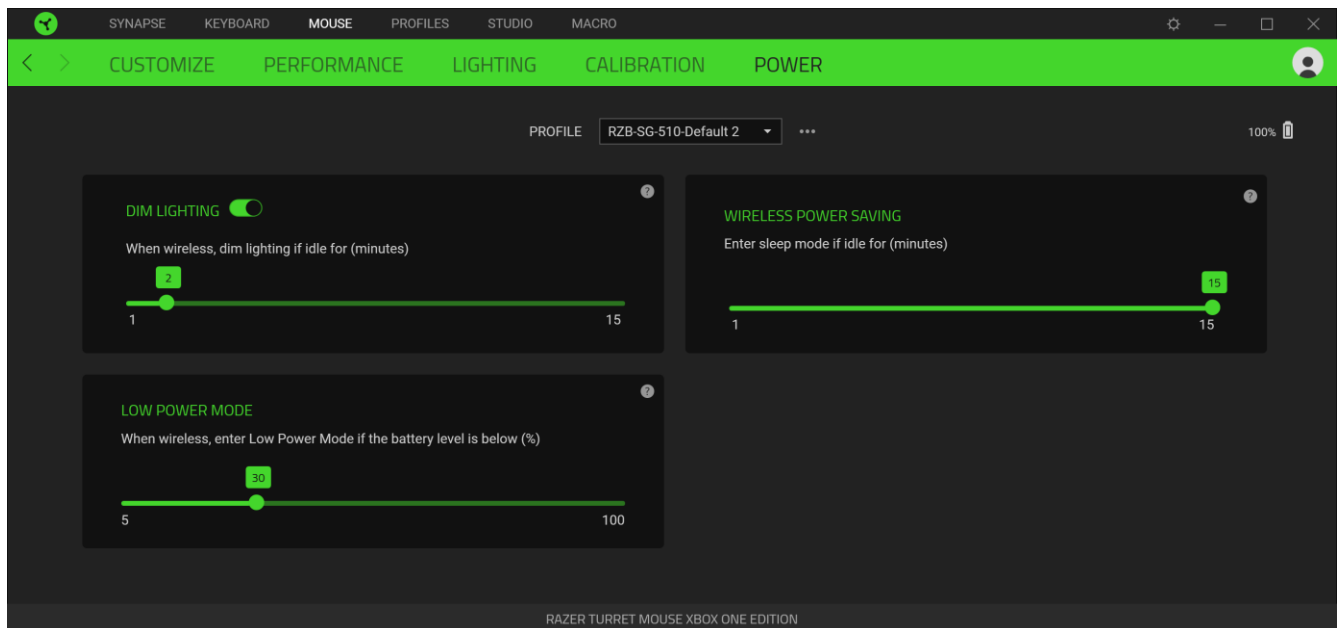





## PROFILES TAB

The Profiles tab is a convenient way of managing all your profiles and linking them to your games and applications.

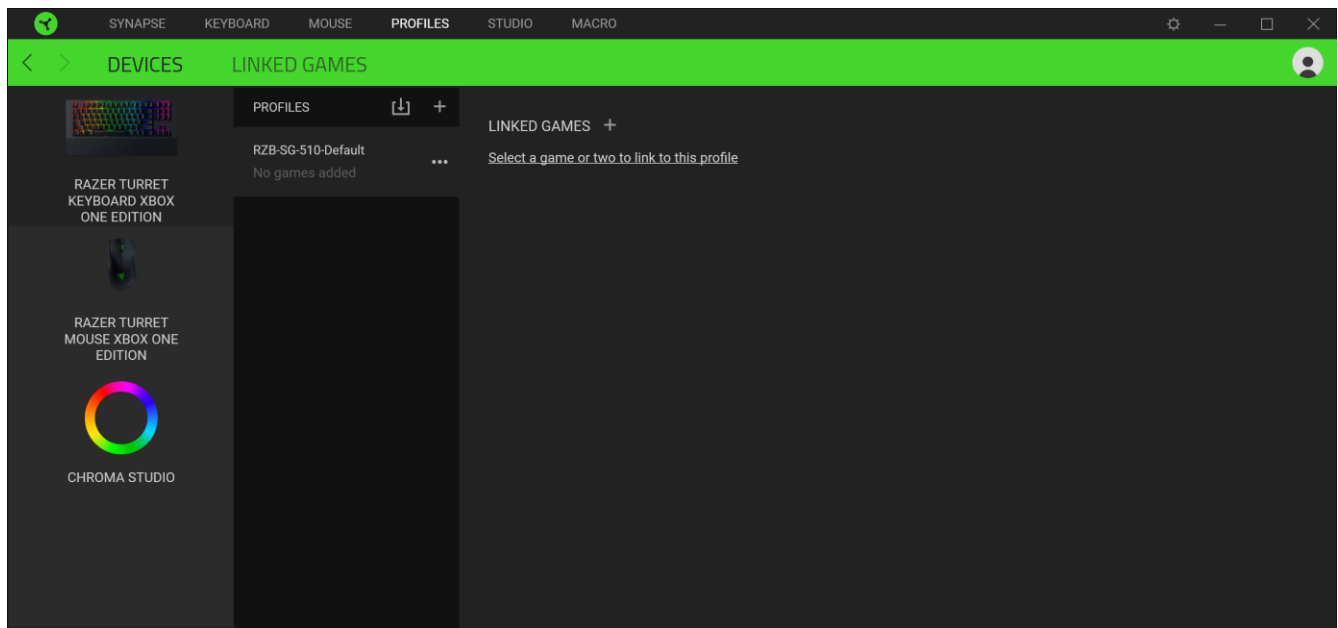
### Devices

View which games are linked to each device's profiles or which Chroma Effect is linked to specific games using the Devices subtab.



You can import Profiles / Chroma Effects from your computer or from the cloud through the import button (  ), or create new profiles within the selected device or new Chroma Effects for specific games using the add button (  ). To rename, duplicate, export, or delete a profile, simply press the Miscellaneous button (  ). Each profile and/or Chroma Effect can be set to automatically activate when you run an application using the Linked Games option.

## Linked Games

The Linked Games subtab gives you the flexibility to add games, view peripherals that are linked to games, or search for added games. You can also sort games based on alphabetical order, last played, or most played. Added games will still be listed here even if it is not linked to a Razer device.

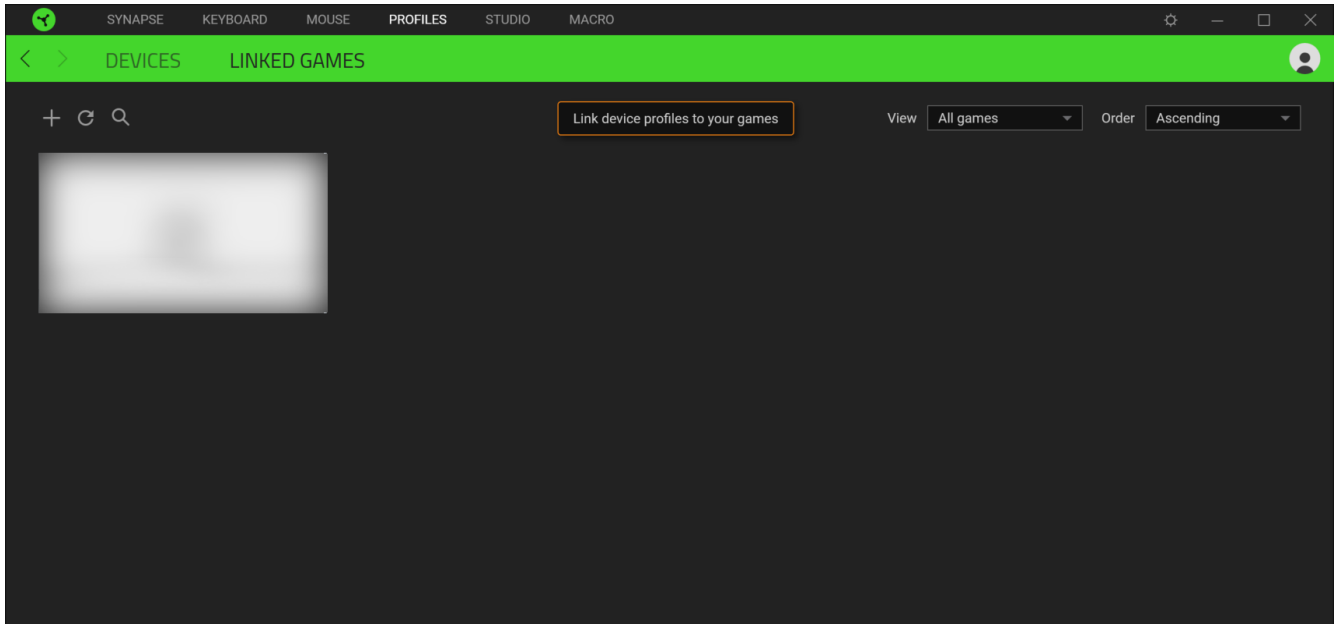

To link games to connected Razer devices or Chroma Effects, simply click on any game from the list, and then click **Select a device and its profile to launch automatically during gameplay** to select the Razer device or Chroma Effect it will link with.

Once linked, you may click on the Miscellaneous button (•••) of the corresponding Chroma Effect or device to select a specific Chroma Effect or profile.

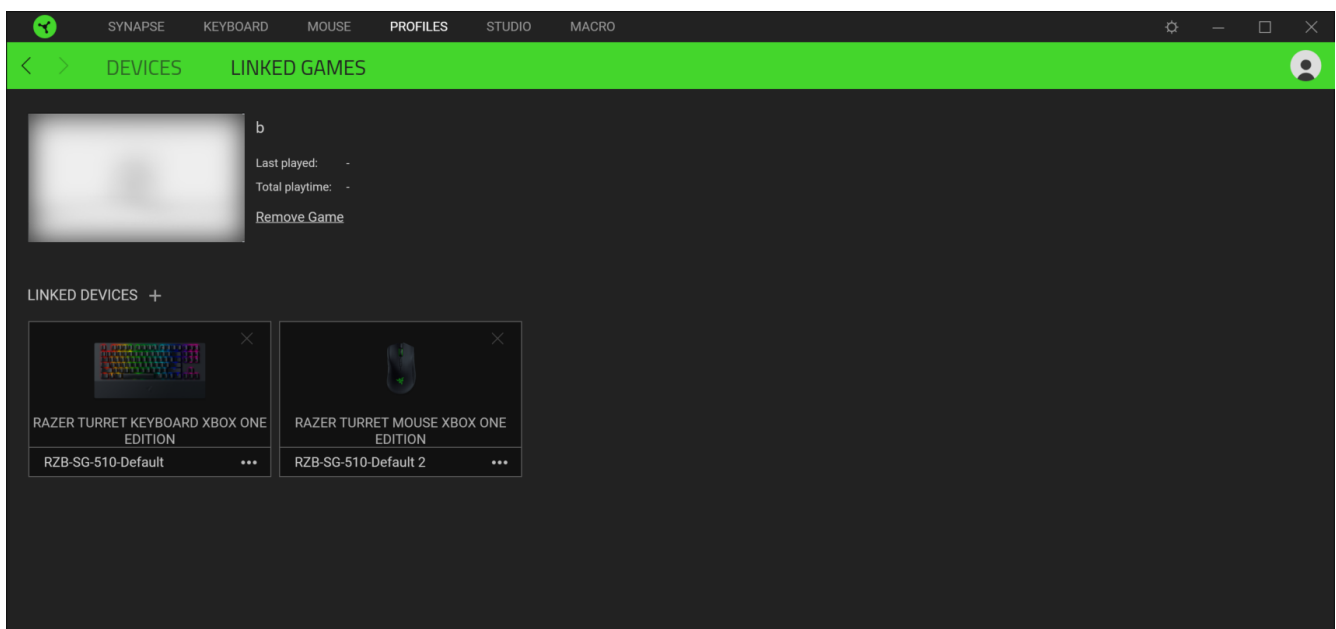

## STUDIO TAB

 *The Studio tab will only be accessible once you have installed the Chroma Studio module from the Modules subtab.*

The Chroma Studio enables you to create and edit your own Chroma Effects which you can apply to all supported Razer Chroma-enabled and/or RGB devices. To add, import or export, rename, duplicate, or delete a Chroma Effect, simply click the Miscellaneous button (•••). To revert the selected layer to its original setting, click the Reset button (↺). And to apply and save a modified layer, click the Save button.

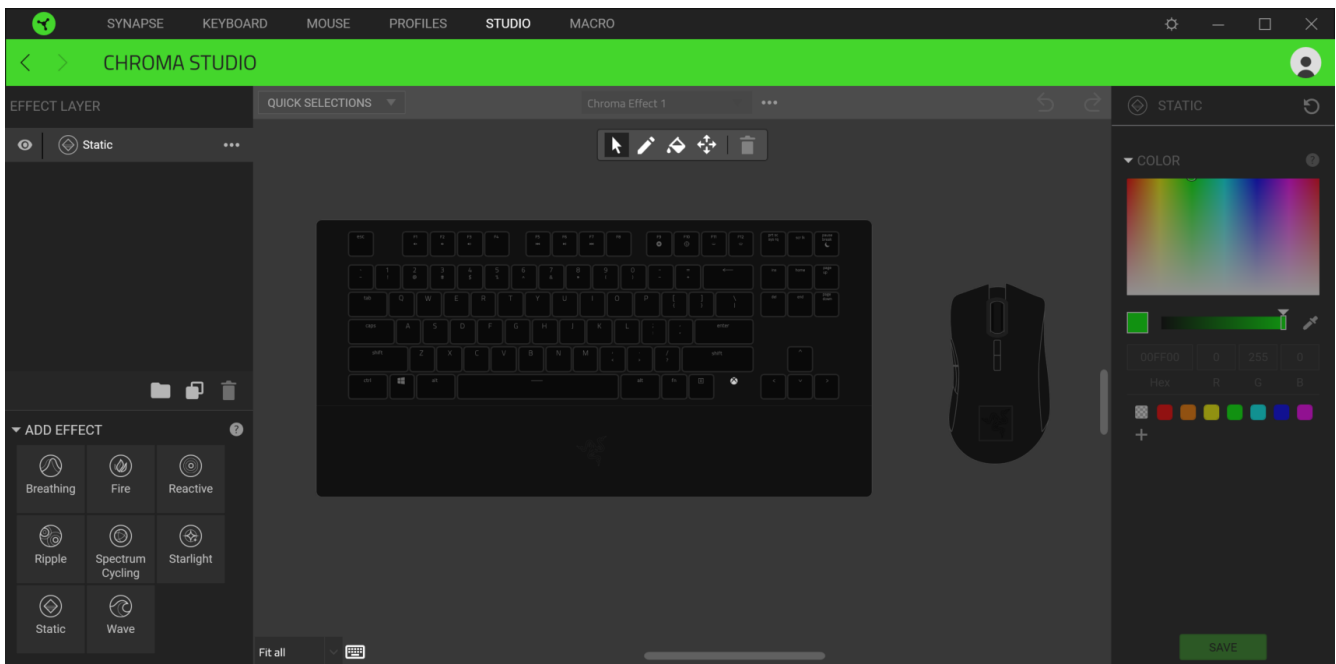





### *Quick Selections*

The Quick Selections drop-down menu are a preset of lighting regions which you can use to easily customize your Razer device. Alternatively, you can individually select an LED by clicking on the area or select multiple LEDs by using click and drag.



### *Selection Panel & Controls*

The Selection Panel allows you to fluidly select or remove LED areas your Chroma Effect will use. Listed below are the selection functions you can choose from:

-  Selector – Select the LEDs where you want to apply the current effect.
-  Pen - Draw directly on the LEDs with the current effect.
-  Paint Bucket - Fill an area continuously with the current effect.
-  Move - Enables you to reposition the devices.

-  Clear Selection - Removes the applied effect from the selected area.

### *Effect Layer*



Lighting effects are arranged in layers wherein the topmost layer takes priority. You can group multiple lighting effects by clicking the Add Group button (  ) and dragging the layers you want to group to the newly added folder, duplicate a layer by clicking the Copy button (  ), or delete a layer by clicking the Trash button (  ). Some layers may have overlapping effects, so you may need to arrange layers in a specific order.

### *Add Effect*



All supported quick effects are listed under the Add Effect option which you can click to insert onto the Effect Layer. Quick Effects can be edited on the Chroma Studio by allowing you to change its preset color, properties, and playback options.

## MACROS TAB

 *The Macro tab will only be accessible once you have installed the Macro module from the Modules subtab.*

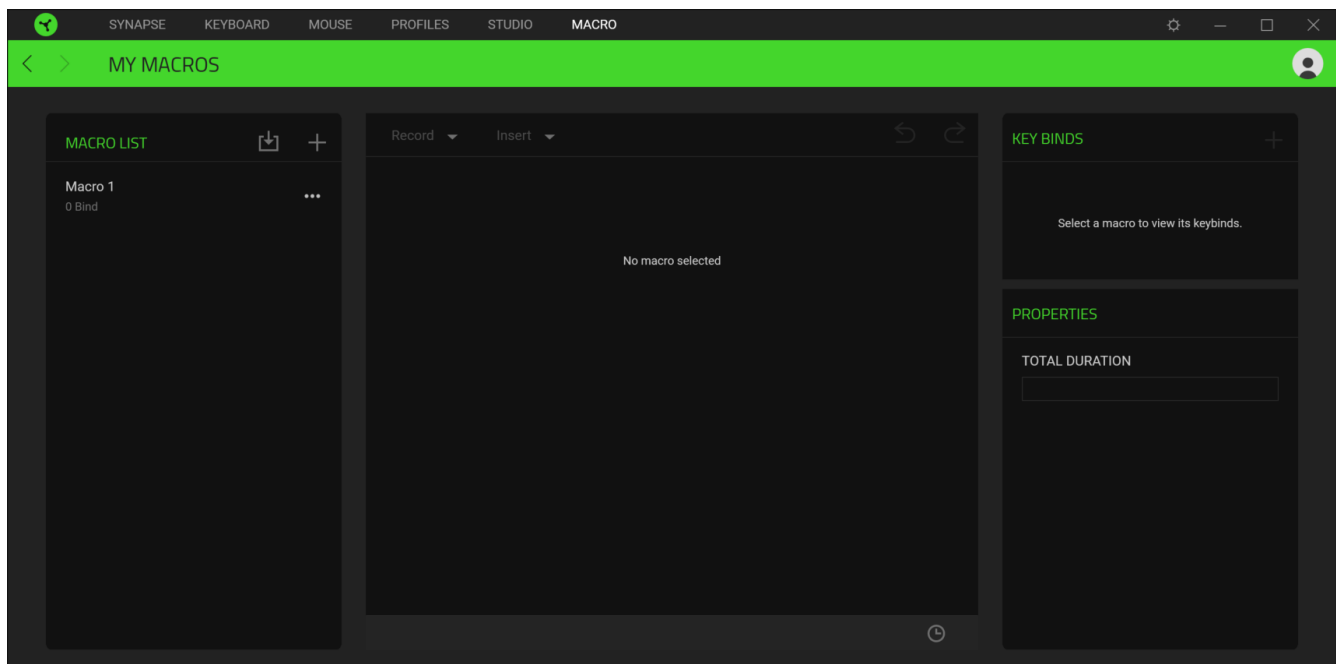
If you need to accurately execute a series of complex commands, then you need a Macro. A macro is a set of recorded keystrokes, button presses, and cursor movements. The Macros tab allows you to create, edit, and organize these macros so that you can assign them to the keys or buttons of your Razer device. You can also share macros with others using the import button () and export button ()



There are also other options available in the macro section such as creating a new macro by clicking the Add button () , deleting the current macro by clicking the Trash button () , and duplicating it using the Copy button () .

To create a macro, simply select a macro name to store your commands, then click the **Record** menu.

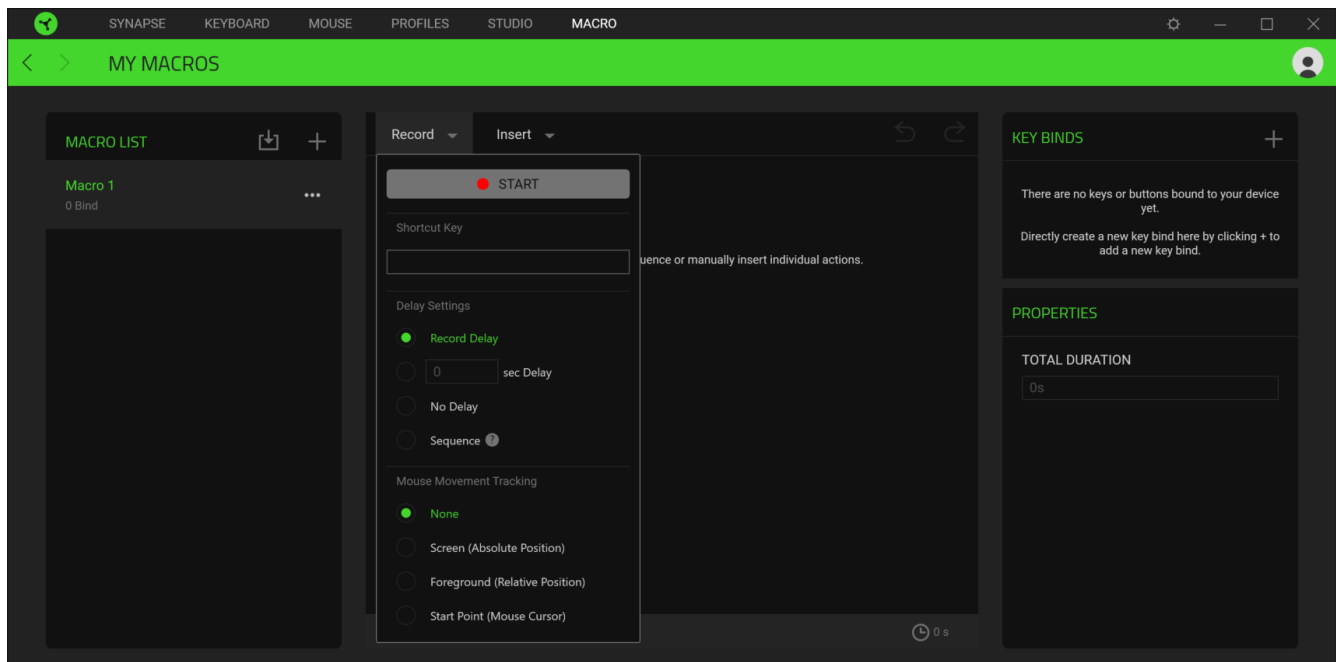



From here you may assign a key or button on the Shortcut Key field that will start or stop the macro recording if you want to record commands and/or movements outside the Razer Synapse window. You may also opt to include or remove the delay or the amount of time between each command through the Delay Settings listed below:

- Record delay – Includes all delays between each command.
- Sec delay – Uses your specified time (in seconds) as a delay between each command.
- No Delay – Removes all delays between each command.
- Sequence– Upon binding a macro using this setting to a key or button, each command within the macro will only be executed by pressing the key bound to the macro continuously.

Or choose to remove or include your preferred mouse movement tracking setting from any of the settings listed below:

- None – Removes all mouse movements made during the macro recording.
- Screen (Absolute Position) – Uses and preserves the exact coordinates of the recorded mouse movement regardless of screen size changes.
- Foreground (Relative Position) – Automatically scales recorded mouse movements proportionally to your screen's current resolution.

- Start point (Mouse Cursor) – Uses the current position of your mouse cursor when performing mouse patterns within macros.

Once you have chosen the settings for the macro, click the Start button (  ). After a brief countdown, all keystrokes, button presses, and mouse movements will be recorded on the macro screen. When you are done recording your macro commands, click on the Stop button (  ) or simply press the Shortcut key to end the session.

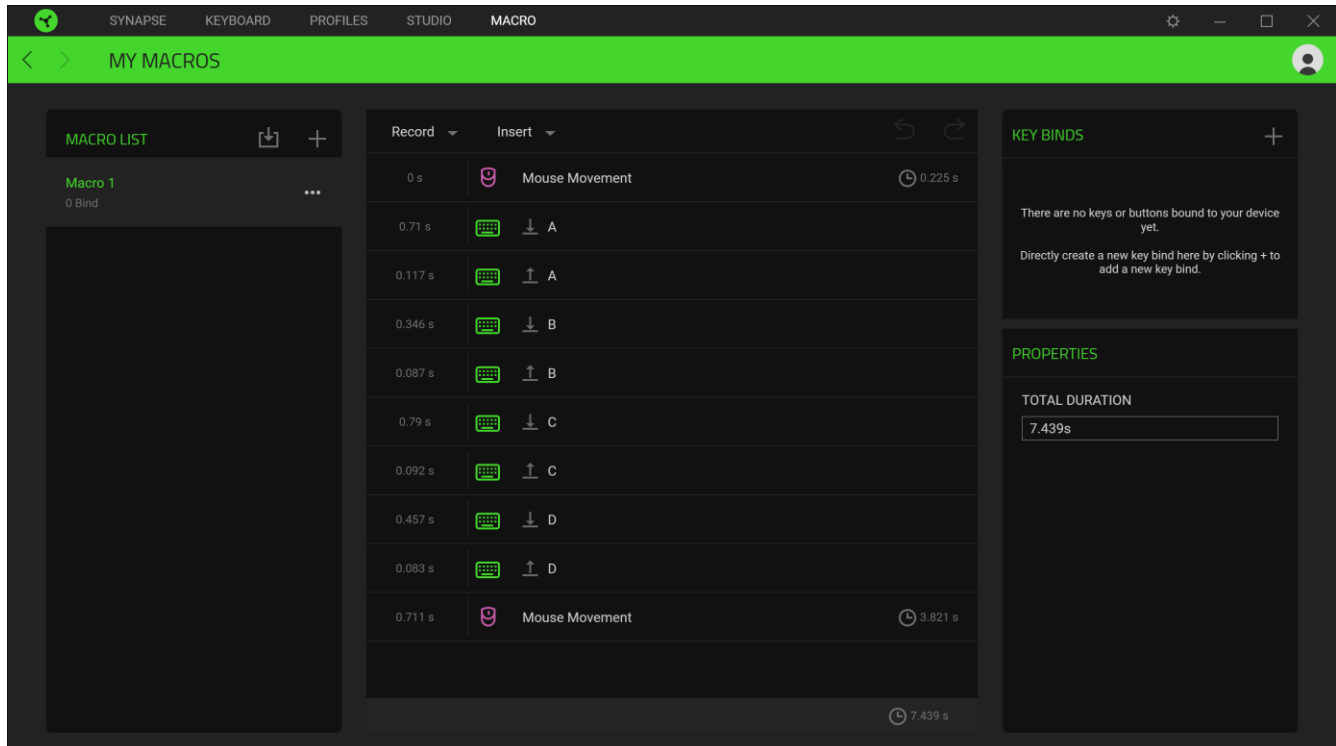

You may then proceed on binding the new macro with your preferred key or button using the Key Binds option. You may also change the overall duration of the recorded macro through the Total Duration field on the Properties option.

 *Changing the overall duration of a macro will proportionally adjust all delays included in each command within the macro.*



Once you have recorded a macro, you may edit the commands you have entered by selecting each command on the macro screen. Each keystroke or button press is arranged sequentially with the first command shown at the top of the screen.

The Insert drop-down menu allows you to put in additional keystrokes, button presses, type texts, run commands, loop a set of commands within the macro, or insert an entire macro group within the macro.

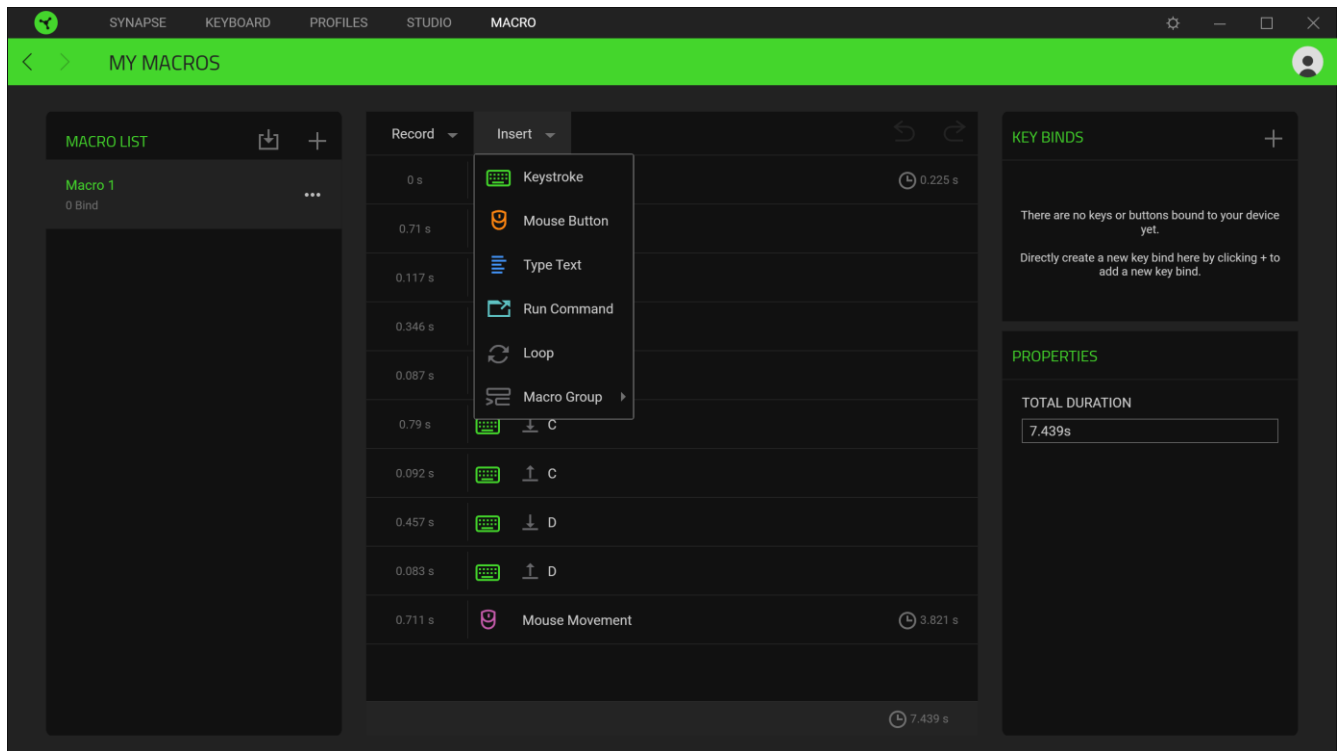

### Key Binds

The Key binds option allows you to view the Shortcut Keys for the selected macro. You can bind a macro to the key or button of your choice without leaving the Macro tab by selecting the Macro you want to bind, and then clicking the Key bind button ( + ).

### Properties

The Properties option enables you to individually edit commands, adjust their delay, change actions, and also change the total duration of the macro so that it executes faster or slower.

## SETTINGS WINDOW

The Settings window, accessible by clicking the (⚙️) button on Razer Synapse, enables you to configure the startup behavior and display language of Razer Synapse, view the master guides of each connected Razer device, or perform factory reset on any connected Razer device.

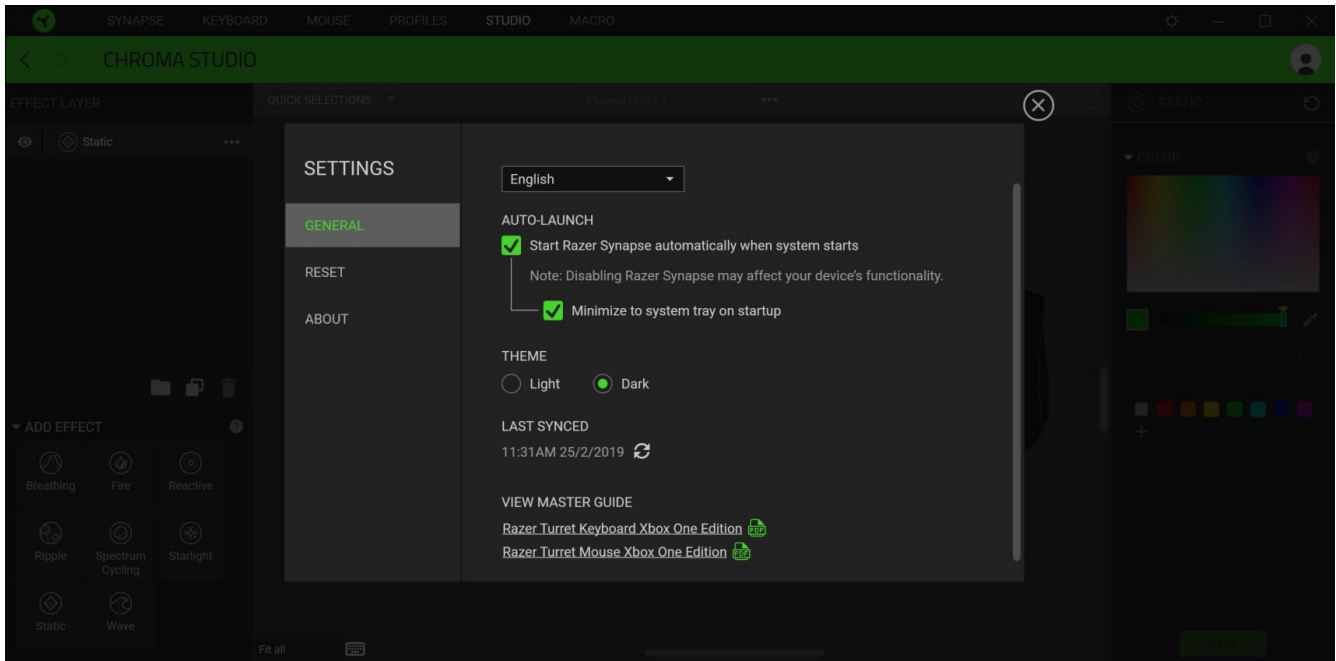

### General tab

The default tab of the Settings window. The General tab enables you to change the software's display language, start-up behavior, and display theme; or view the master guide of all connected Razer devices. You may also manually sync your profiles to the cloud (↻) or view the master guide of all connected Razer devices.

### Reset tab

The Reset tab allows you to perform a factory reset on all connected Razer devices with on-board memory and/or reset Razer Synapse tutorials to acquaint yourself again with Razer Synapse's new features on its next launch.

**i** *By resetting a Razer device, all profiles stored on the selected device's on-board memory will be erased.*

### About tab

The About tab displays brief software information and copyright statement, and provides relevant links for its terms of use. You may also use this tab to check for software updates, or as a quick access to Razer's social communities.

---

## 9. SAFETY AND MAINTENANCE

### SAFETY GUIDELINES

In order to achieve maximum safety while using your Razer Turret for Xbox One, we suggest that you adopt the following guidelines:

- Should you have trouble operating the device properly and troubleshooting does not work, unplug the device and contact the Razer hotline or go to [support.razer.com](https://support.razer.com) for assistance.
- Avoid looking directly at the tracking beam of your mouse or pointing the beam in anyone else's eye. Note that the tracking beam is NOT visible to the naked human eye and is set on an Always-On mode.
- Do not insert or connect foreign objects, cables, or devices not intended for the device.
- Do not take apart the device (doing so will void your warranty) and do not attempt to operate it under abnormal current loads.
- When unplugging any connected devices and/or cables, always pull the cable or device's plug or connector. Don't forcefully tug on its cord.
- When connecting cables or setting up the device, carefully plan how the wires will be placed. Protect any connected cables from being walked on or pinched, particularly at plugs, convenience receptacles, or the point where they exit from.
- Keep the device away from liquid, humidity or moisture. Operate the device only within the specific temperature range of 0°C (32°F) to 40°C (104°F). Should the temperature exceed this range, unplug and/or switch off the device in order to let the temperature stabilize to an optimal level.

### COMFORT

Research has shown that long periods of repetitive motion, improper positioning of your computer peripherals, incorrect body position, and poor habits may be associated with physical discomfort and injury to nerves, tendons, and muscles. Below are some guidelines to avoid injury and ensure optimum comfort while using your Razer Turret for Xbox One.

1. Position your keyboard and monitor directly in front of you with your mouse next to it. Place your elbows next to your side, not too far away and your keyboard within easy reach.
2. Keep your feet well supported, posture straight and your shoulders relaxed.
3. During gameplay, relax your wrist and keep it straight. If you do the same tasks with your hands repeatedly, try not to bend, extend or twist your hands for long periods.
4. Do not rest your wrists on hard surfaces for long periods.

5. Customize the keys on your keyboard to suit your style of gaming in order to minimize repetitive or awkward motions while gaming.
6. Do not sit in the same position all day. Get up, step away from your desk and do exercises to stretch your arms, shoulders, neck and legs.

If you should experience any physical discomfort while using your keyboard, such as pain, numbness, or tingling in your hands, wrists, elbows, shoulders, neck or back, please consult a qualified medical doctor immediately.

## **MAINTENANCE AND USE**

The Razer Turret for Xbox One requires minimum maintenance to keep it in optimum condition. Once a month we recommend you switch off and unplug each device, remove all connected cables, and then clean each device using a soft cloth or cotton swab to prevent dirt buildup.

## **BATTERY WARNING**

The Razer Turret for Xbox One keyboard and mouse both contain an internal, lithium-ion rechargeable battery. In general, the life expectancy of such battery is dependent upon usage. If you suspect that the lithium-ion rechargeable battery inside the Razer Turret for Xbox One keyboard and/or mouse may be drained (has a low charge), try charging it. If the battery does not recharge after several attempts, it may be non-operational.

**CAUTION:** Do not open, mutilate, or expose to conducting materials (metal), moisture, liquid, fire, or heat. Doing so may cause the battery to leak or explode, resulting in personal injury. Do not leave any of the devices discharged or unused for extended periods. When not using your Razer Turret for Xbox One keyboard and/or mouse for more than 30 days, be sure to store each device in a fully charged state. Battery life varies with usage.

---

## 10. LEGALESE

### **COPYRIGHT AND INTELLECTUAL PROPERTY INFORMATION**

©2019 Razer Inc. All rights reserved. Razer, the triple-headed snake logo, Razer logo, "For Gamers. By Gamers.", and "Powered by Razer Chroma" logo are trademarks or registered trademarks of Razer Inc. and/or affiliated companies in the United States or other countries.

Microsoft, Windows, the Windows logo, and Xbox One are trademarks of the Microsoft group of companies. All other trademarks are the property of their respective owners.

Razer Inc. ("Razer") may have copyright, trademarks, trade secrets, patents, patent applications, or other intellectual property rights (whether registered or unregistered) concerning the product in this guide. Furnishing of this guide does not give you a license to any such copyright, trademark, patent or other intellectual property right. The Razer Turret for Xbox One (the "Product") may differ from pictures whether on packaging or otherwise. Razer assumes no responsibility for such differences or for any errors that may appear. Information contained herein is subject to change without notice.

### **LIMITED PRODUCT WARRANTY**

For the latest and current terms of the Limited Product Warranty, please visit [razer.com/warranty](https://www.razer.com/warranty).

### **LIMITATION OF LIABILITY**

Razer shall in no event be liable for any lost profits, loss of information or data, special, incidental, indirect, punitive or consequential or incidental damages, arising in any way out of distribution of, sale of, resale of, use of, or inability to use the Product. In no event shall Razer's liability exceed the retail purchase price of the Product.

### **GENERAL**

These terms shall be governed by and construed under the laws of the jurisdiction in which the Product was purchased. If any term herein is held to be invalid or unenforceable, then such term (in so far as it is invalid or unenforceable) shall be given no effect and deemed to be excluded without invalidating any of the remaining terms. Razer reserves the right to amend any term at any time without notice.