



RAZER JUNGLECAT

MASTER GUIDE

When you and the **Razer Junglecat** are on the move, the only place you'll arrive at is victory. Leave your opponents behind and enhance your mobile gaming experience with the portable precision of an advanced dual-sided controller.

CONTENTS

1. WHAT'S INSIDE / WHAT'S NEEDED.....	3
2. LET'S GET YOU COVERED.....	4
3. TECHNICAL SPECIFICATIONS.....	5
4. SETTING UP YOUR RAZER JUNGLECAT	6
5. USING YOUR RAZER JUNGLECAT	9
6. USING THE RAZER GAMEPAD APP.....	11
7. SAFETY AND MAINTENANCE	16
8. LEGALESE.....	17

1. WHAT'S INSIDE / WHAT'S NEEDED

WHAT'S INSIDE

- Razer Junglecat

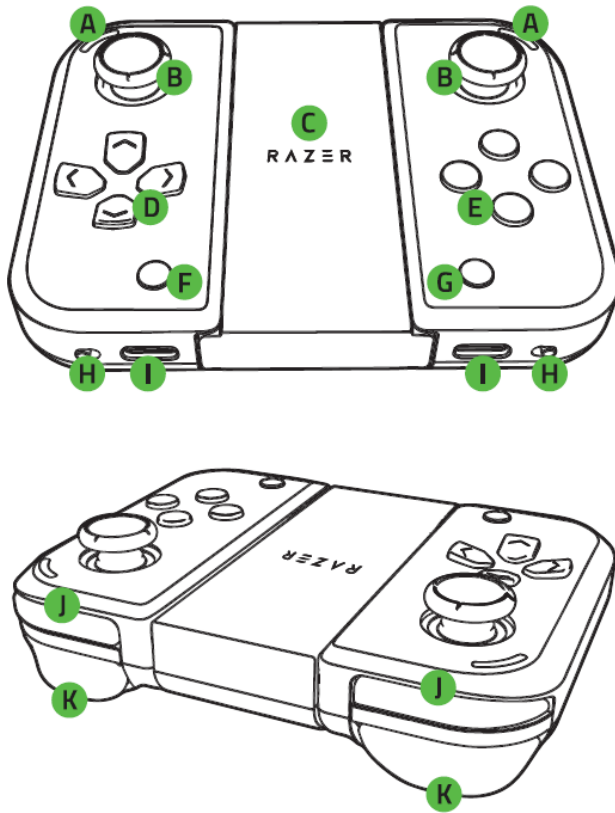

- A. Status indicators
- B. Clickable thumbsticks
- C. Slide-in controller grip
- D. Directional pad
- E. Tactile Switch action buttons
- F. SELECT button
- G. START button
- H. Power switches
- I. Type C charging ports
- J. Bumpers (L1/R1)

- Phone-grip cases*
- Important Product Information Guide

**Included cases may vary for specific regions.*

WHAT'S NEEDED

- Android™ 7.1 Nougat (or higher)
- Bluetooth connectivity
- Internet connection for software installation

2. LET'S GET YOU COVERED

You've got a great device in your hands, complete with a 1-year limited warranty coverage. Now maximize its potential and score exclusive Razer benefits by registering at razerid.razer.com

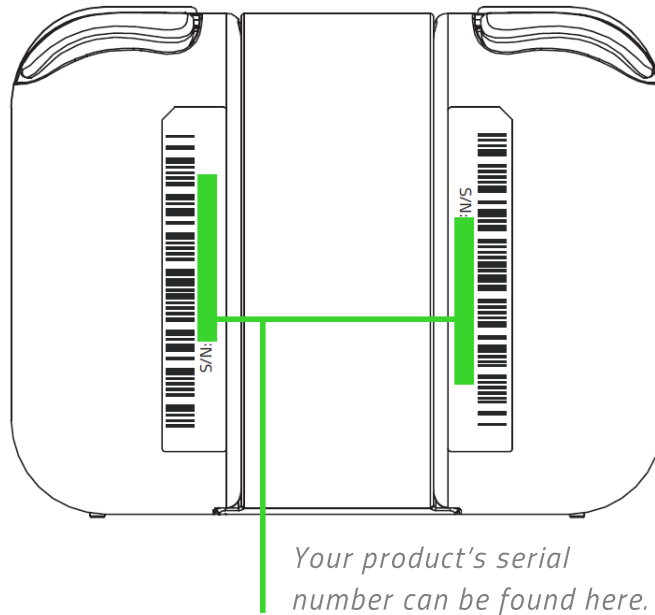

Got a question? Ask the Razer Support Team at support.razer.com

3. TECHNICAL SPECIFICATIONS

FEATURES

- Portable Dual-sided controller for enhanced mobile gaming precision
- Modular design for total flexibility and personalization
- Razer Gamepad app for integrated game support and custom button mapping
- Low latency connection for seamless button response
- Bluetooth low energy for longer battery life

APPROXIMATE SIZE & WEIGHT

Controller (Left or Right)

- Length: 81 mm / 3.18 in
- Width: 36.8 mm / 1.44 in
- Height: 29.9 mm / 1.17 in
- Weight: 42 g / 1.48 lbs

Controllers + Slide-in Controller Grip

- Length: 81 mm / 3.18 in
- Width: 104 mm / 4.09 in
- Height: 29.9 mm / 1.17 in
- Weight: 101 g / 0.22 lbs

4. SETTING UP YOUR RAZER JUNGLECAT

1. Plug in both of your controllers to powered USB ports using a Type C cable (not included) to charge your controllers. It takes approximately 2.6 hours to fully charge each controller.

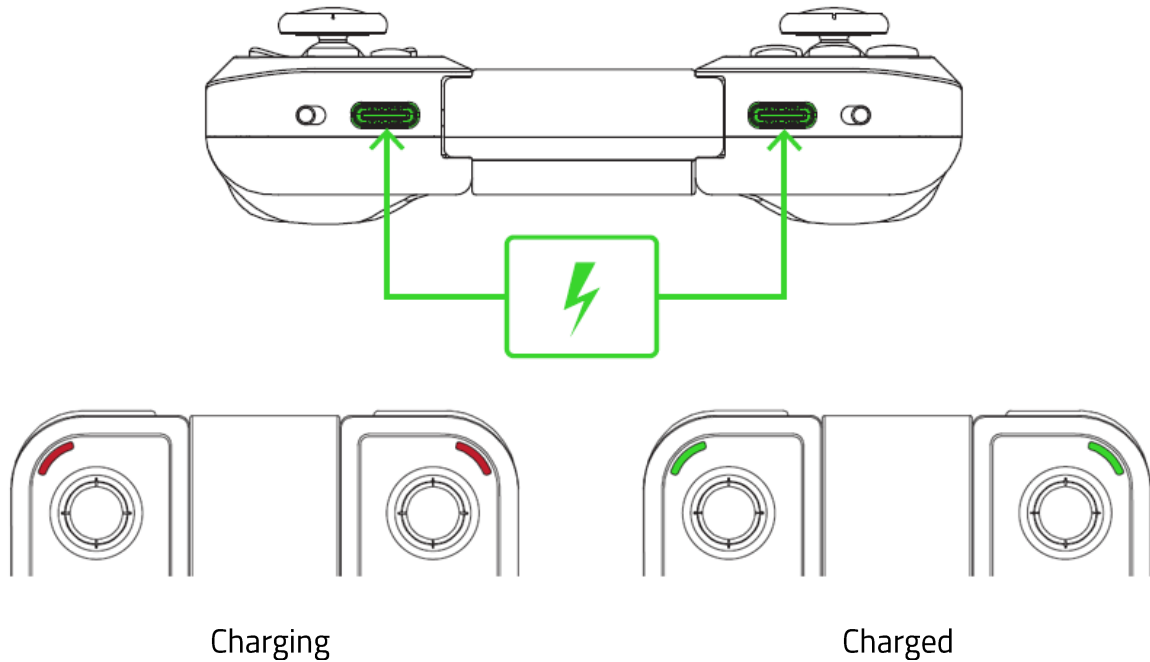

i *Unplug both controllers once they finish charging.*

2. With your phone placed in its correct phone-grip case, detach the left and right controllers from the slide-in controller grip, then slide in each controller to the sides of the case.

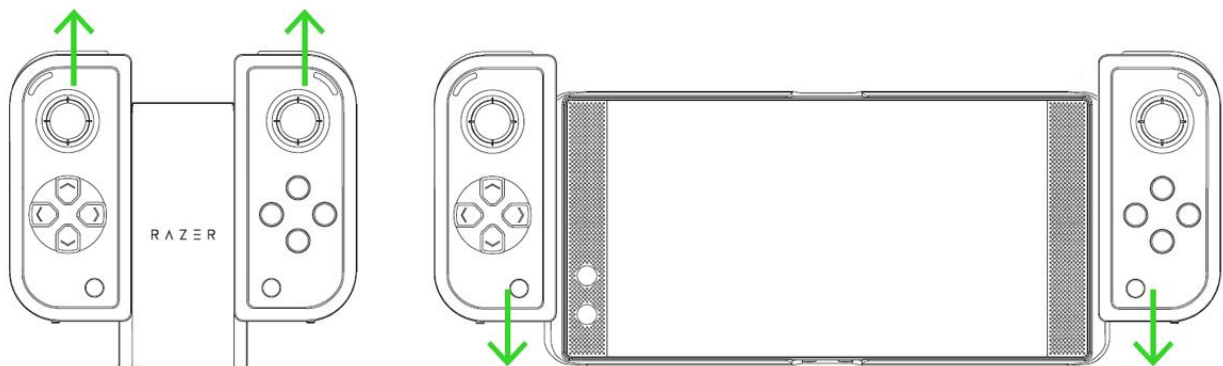

**Smartphone not included.*

(Optional) For longer hours of gaming, you may continue using the slide-in controller for more comfort.

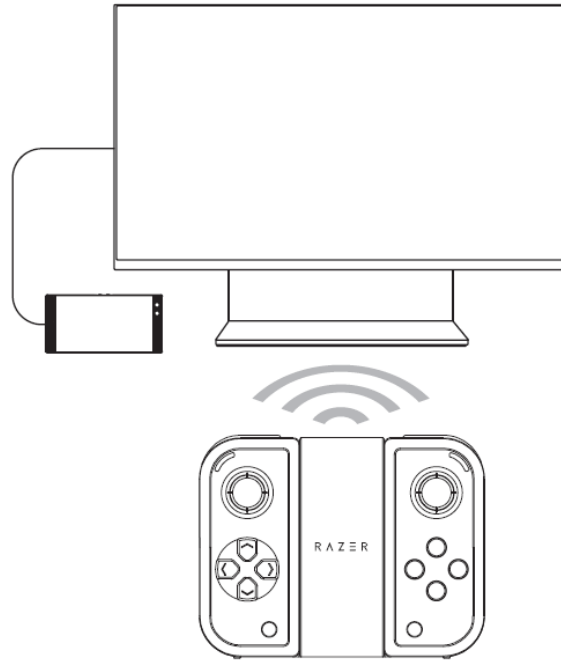

i Cable not included and requires Android smartphone with video output capabilities

3. Switch on both controllers. Switch on both controllers. The controllers will automatically pair with each other via 2.4 GHz and the status indicators on both controllers will blink in blue, indicating that they can now be paired to your phone via Bluetooth connectivity.

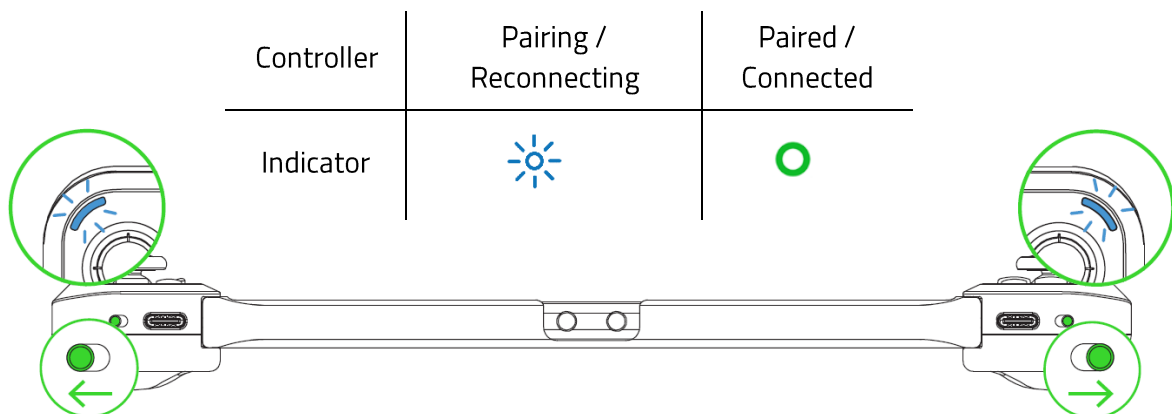

4. Open the Bluetooth settings on your phone and select either the left or right Razer Junglecat controller from the list of available devices. The remaining controller will automatically connect to the first paired controller once present.

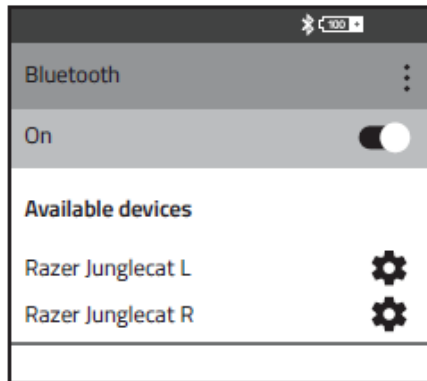

The status indicators of both controllers will turn solid green, indicating that they are now paired to your phone.

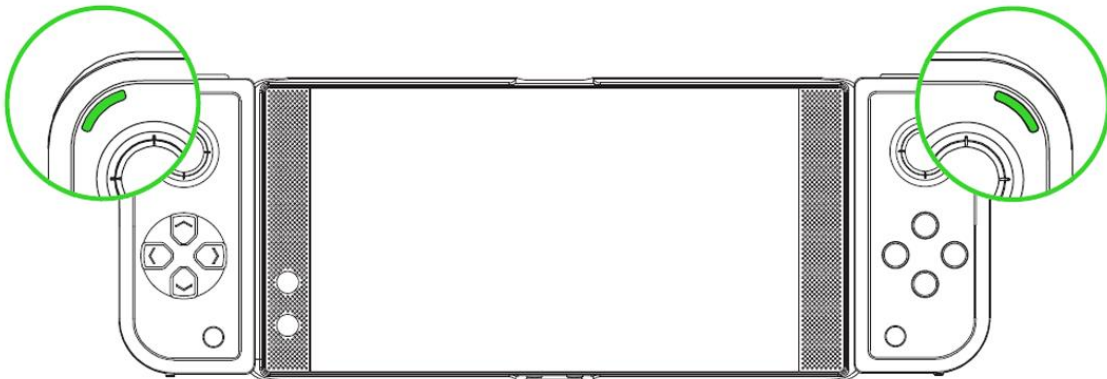

i You can pair your phone with just one controller and the second controller will automatically connect to your phone (and controller) once available.



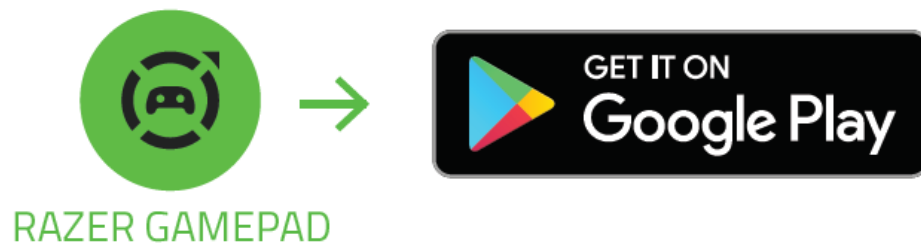



5. Download the Razer Gamepad app to customize your controllers' button functions and thumbsticks exactly as you want them for each game.



5. USING YOUR RAZER JUNGLECAT

UNDERSTANDING THE STATUS INDICATORS

Use the status indicators when checking the connection and power status of each controller.

Status	Fully charged	Pairing / Connecting*	Paired / Connected*
ON			
Charging (and ON)			

* When active (and not charging) a controller's current status will alternately blink in red when its battery is low. This sequence will repeat until the corresponding controller's battery is drained or charged.

CONNECTING AN EXISTING CONTROLLER TO A NEW CONTROLLER

By default, your left and right controllers will automatically connect to each other. However, in the event that you need to replace any of your controllers with a new controller, you must connect the existing controller to the new controller before pairing it with your phone.

To connect any existing controller with a new controller:

1. Make sure the existing controller is off.
2. On the existing controller, hold **UP (directional pad) + SELECT** on the left controller OR **Y + START** on the right controller, and then switch it on. The existing controller's status indicator will blink in white, indicating that it is now searching for a new controller.
3. Repeat step 2 on the new controller. Its status indicator will also blink in white, indicating that it is also searching for a controller to connect to.
4. Wait for the indicators to show any of the following:
 - **Solid green**, if one of your controllers have already been paired with your phone and the phone's Bluetooth is active. This indicates that your controllers are now connected (to each other) and paired with your phone.
 - **Blinking blue**, if the controller that you replaced was the one paired with your phone. This indicates that that your controllers are now connected (to each other) and may now be paired again with your phone.

STANDBY MODE

To conserve battery, the controllers will automatically enter standby mode if they remain unpaired (to a controller and/or phone) within 60 seconds or when left idle for 10 minutes. Press the START or SELECT button to wake any of your controllers.

6. USING THE RAZER GAMEPAD APP

i *Disclaimer: Internet connection is required for installation, updates and cloud-based features. Registering for a Razer ID account is recommended, but optional. All listed features are subject to change based on the current app version.*

From allowing you to launch compatible games with their default controls or with your very own mapping, to showing you the hottest supported mobile games available, the Razer Gamepad app allows you to flexibly customize the button functions, mappings, and other features of your Razer Junglecat – whenever needed.

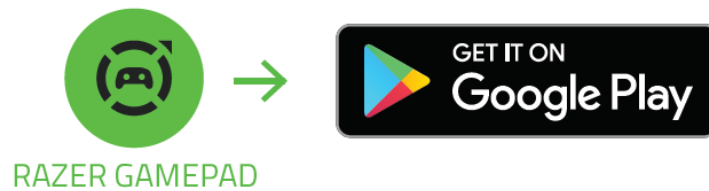

CONNECTING YOUR RAZER ID

By default, the Razer Gamepad app will automatically use a Guest account on its first launch.

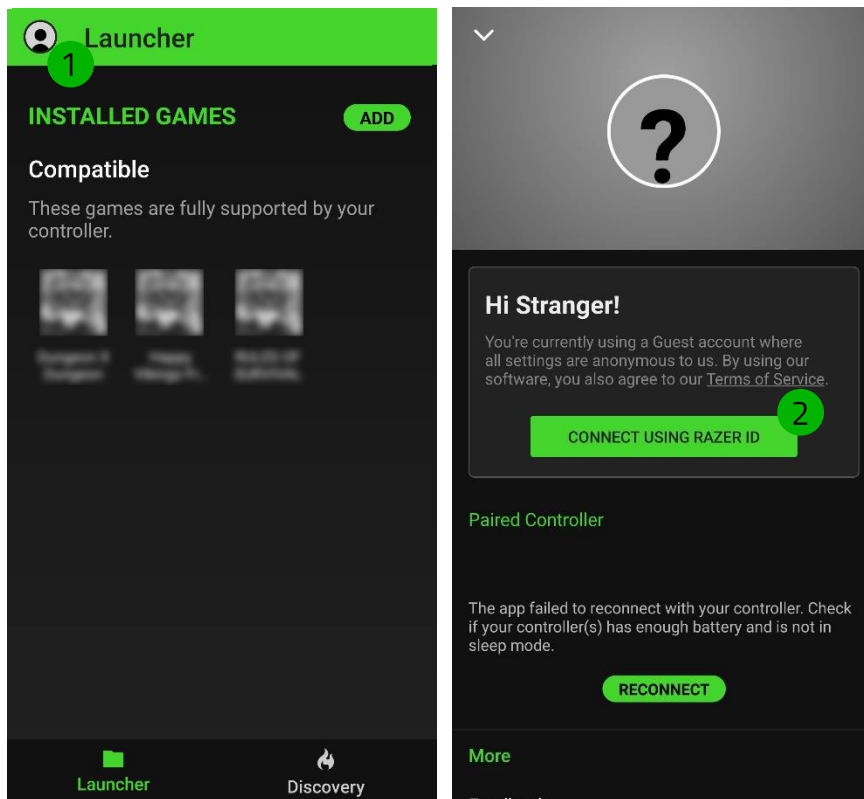

(Optional) It is recommended that you immediately connect your Razer ID to the Razer Gamepad app to continuously access [custom profiles](#) for all your games even as you use your controller and app on other phones. [Learn more about Settings](#)

LAUNCHER TAB

The Launcher tab is the default tab of the Razer Gamepad app.

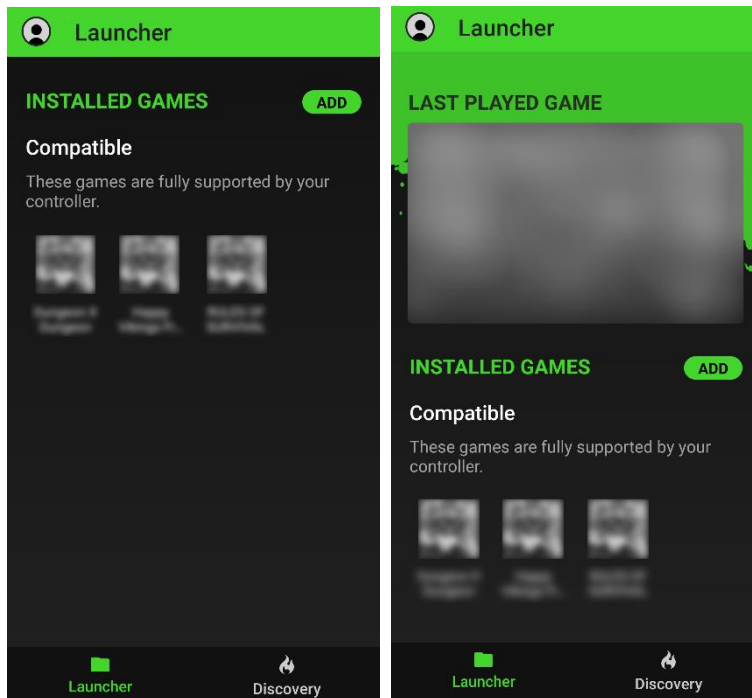

This tab shows all **Compatible** games detected on your phone, **Untested** apps you've added into the Launcher, as well as the last Compatible app launched through the Razer Gamepad app.

i *When launching any games using the Launcher, both controllers must be active and paired to your phone.*

Adding Untested games

If you're unable to find an installed game in the Compatible list, it's possible that your game is not (or has not yet been listed) as a supported / tested game.

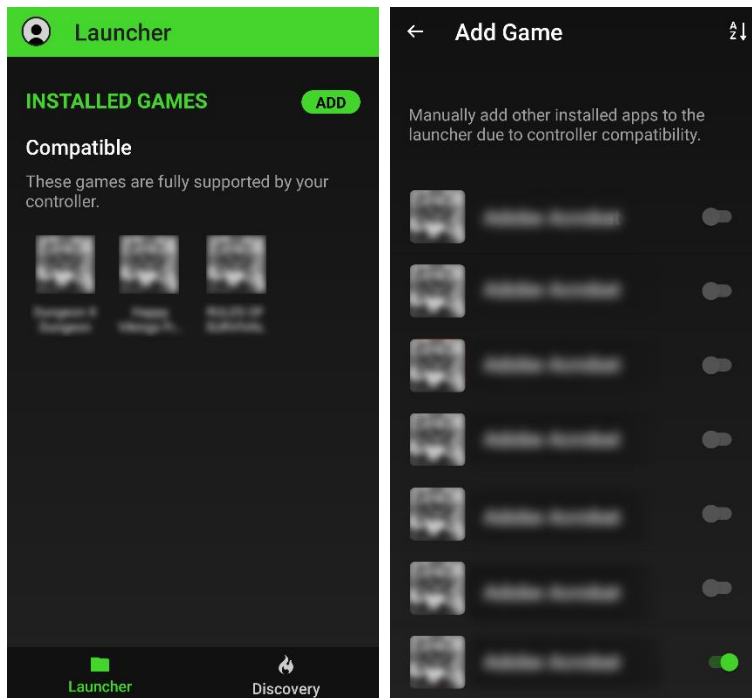

To play untested game(s), you need to manually add your installed game(s) into the Launcher first. Simply tap **ADD** and then enable the game(s) that you want to use with your controller. Manually added games will automatically be added to the Untested list.

i *As these games may not be supported by the Razer Gamepad app, controls, functions, and other features may not work as expected.*

Launching compatible games

The Compatible list shows all controller supported games installed on your phone. Games classified as compatible already have default controls mapped directly into the controller allowing you to either immediately use its default mapping or fully customize each button function before launching the selected game.

Launch Options

The Launch Options page allows you to either use the game's **Default** (↺) mapping or create your very own **Custom** (≡) mapping. By default, this page is shown when launching any compatible game through the Launcher.

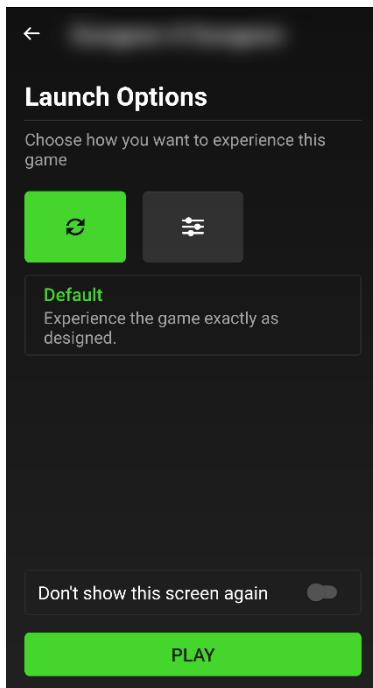

i Enable the **Don't show this screen again** option to hide the Launch Options for the selected game and keep on using the chosen setting whenever launching it. To access any game's hidden Launch Options, long tap on any game on the Launcher's Compatible list.

Creating Custom Profiles

When launching any compatible game, tap **Custom** to create your very own mapping and even use your preferred sticks sensitivity for the selected game.

i When logged in, any changes made on a custom profile are automatically saved and stored into the cloud servers.

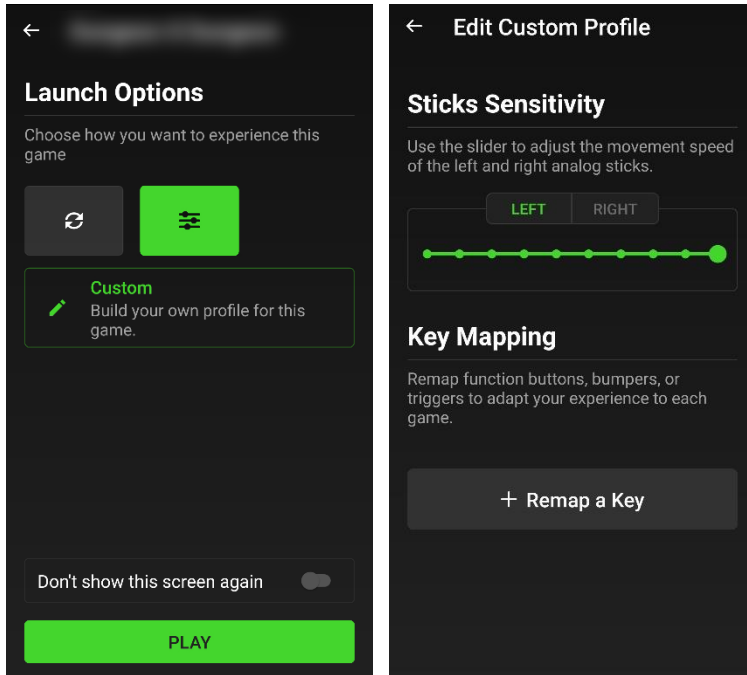

Sticks sensitivity

Adjust the movement speed of the left and right analog sticks. Simply tap which analog stick will be modified and adjust the slider to change its corresponding speed.

Key Mapping

Tap **+ Remap a Key** to begin remapping function buttons, bumpers or triggers as needed for the selected game.

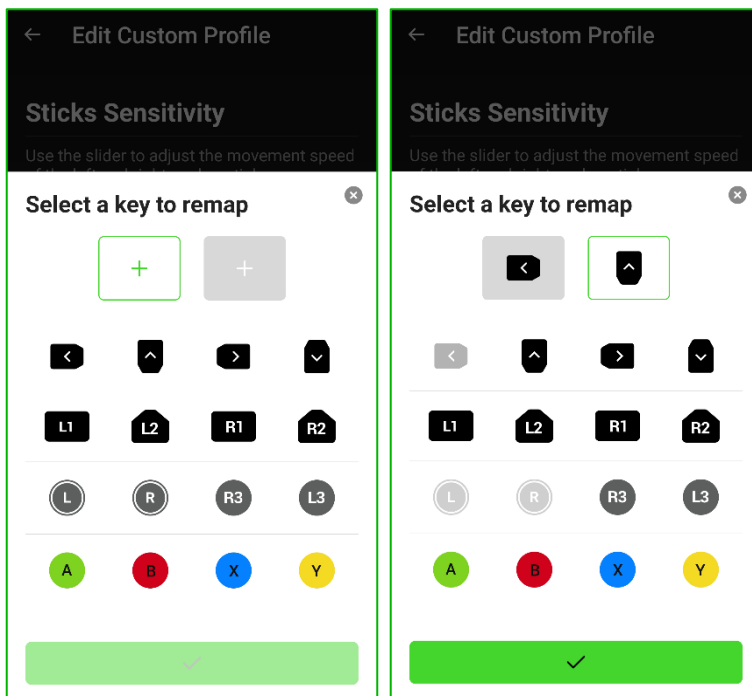

Select the controller function that you want to remap and then choose its new function from the functions provided. Once done, tap the ✓ button to confirm the remap.

DISCOVERY TAB

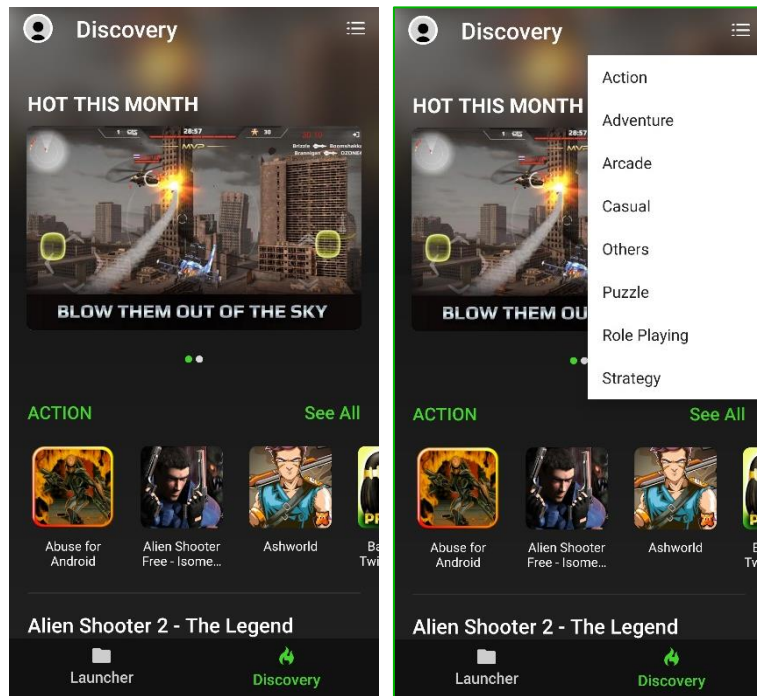

The Discovery tab allows you to explore and access an expansive list of supported games available for your controller. To easily filter which game genre is shown, tap the miscellaneous button (☰).

SETTINGS

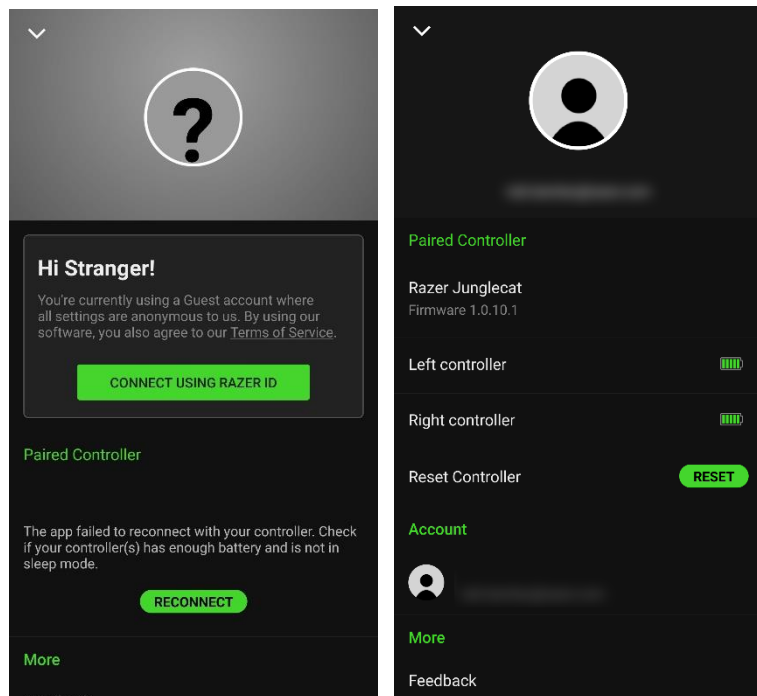

Accessible by tapping your avatar icon, the Settings page enables you to connect to the app using your Razer ID, see the battery status of each controller and perform other controller-specific functions such as manually reconnecting the app to your controllers, and resetting the controllers to their default settings if needed.

You may also use this tab to submit feedback, contact customer support, and view the app's FAQs.

7. SAFETY AND MAINTENANCE

SAFETY GUIDELINES

In order to achieve maximum safety while using your Razer Junglecat, we suggest that you adopt the following guidelines:

Should you have trouble operating the device properly and troubleshooting does not work, make sure to unplug the device (if applicable) and contact the Razer hotline or go to support.razer.com for support.

The controllers should slide in smoothly into the controller grip or phone-grip cases. Should you have trouble attaching any of the controllers, check if you're sliding it into its allocated side. Don't forcefully slide them into the controller grip or phone-grip cases.

Don't take apart the device (doing so will void your warranty) and don't attempt to operate it under abnormal current loads.

Keep the device away from liquid, humidity or moisture. Operate the device only within the specific temperature range of 0°C (32°F) to 40°C (104°F). Should the temperature exceed this range, unplug and/or switch off the device in order to let the temperature stabilize to an optimal level.

MAINTENANCE AND USE

The Razer Junglecat requires minimum maintenance to keep it in optimum condition. Once a month, we recommend you switch off and detach both controllers, remove any attached cables, and gently clean all components using a soft cloth or cotton swab to prevent dirt buildup.

BATTERY WARNING

The Razer Junglecat contains an internal, lithium-ion polymer rechargeable battery. In general, the life expectancy of such battery is dependent upon usage. If you suspect that the lithium-ion polymer rechargeable battery inside the Razer Junglecat may be drained (has a low charge), try charging it. If the battery does not recharge after several attempts, it may be non-operational. Do not open, mutilate, or expose to conducting materials (metal), moisture, liquid, fire, or heat. Doing so may cause the battery to leak or explode, resulting in personal injury. Do not leave the device discharged or unused for extended periods.

8. LEGALESE

COPYRIGHT AND INTELLECTUAL PROPERTY INFORMATION

©2019 Razer Inc. All rights reserved. Razer, the triple-headed snake logo, Razer logo, "For Gamers. By Gamers.", Razer Phone 2 and "Powered by Razer Chroma" logo are trademarks or registered trademarks of Razer Inc. and/or affiliated companies in the United States or other countries. All other trademarks are the property of their respective owners.

©2018 Google LLC All rights reserved. Android, Google, Google Logo, Google Play, and the Google Play logo are registered trademarks of Google LLC.

The Bluetooth® word mark and logos are registered trademarks owned by Bluetooth SIG, Inc., and any use of such marks by Razer is under license.

Razer Inc. ("Razer") may have copyright, trademarks, trade secrets, patents, patent applications, or other intellectual property rights (whether registered or unregistered) concerning the product in this guide. Furnishing of this guide does not give you a license to any such copyright, trademark, patent or other intellectual property right. The Razer Junglecat (the "Product") may differ from pictures whether on packaging or otherwise. Razer assumes no responsibility for such differences or for any errors that may appear. Information contained herein is subject to change without notice.

LIMITED PRODUCT WARRANTY

For the latest and current terms of the Limited Product Warranty, please visit [razer.com/warranty](https://www.razer.com/warranty).

LIMITATION OF LIABILITY

Razer shall in no event be liable for any lost profits, loss of information or data, special, incidental, indirect, punitive or consequential or incidental damages, arising in any way out of distribution of, sale of, resale of, use of, or inability to use the Product. In no event shall Razer's liability exceed the retail purchase price of the Product.

GENERAL

These terms shall be governed by and construed under the laws of the jurisdiction in which the Product was purchased. If any term herein is held to be invalid or unenforceable, then such term (in so far as it is invalid or unenforceable) shall be given no effect and deemed to be excluded without

invalidating any of the remaining terms. Razer reserves the right to amend any term at any time without notice.